



Report 2011

LEITNER[®]
ropeways





LEITNER ropeways è in grado di coniugare la massima tecnologia e qualità con sostenibilità, design e i desideri e le idee della clientela.







Hightech e sostenibilità ambientale, design e qualità di massimo livello. Grazie a questi tratti fondamentali, che contraddistinguono la nostra offerta, nel corso dell'anno 2011 siamo riusciti ad ottenere degli ottimi risultati, primi fra tutti: l'apertura a nuovi mercati, l'attuazione di progetti prestigiosi ed infine la creazione di prodotti straordinari, in grado di entusiasmare la nostra clientela.

Al giorno d'oggi gli impianti a fune non possono più essere considerati esclusivamente dei semplici sistemi di trasporto. LEITNER ropeways propone infatti un sistema altamente innovativo sia per quanto attiene il suo utilizzo nel settore turistico che per quanto riguarda il trasporto di persone in un contesto urbano. Le aspettative della clientela si orientano in misura sempre crescente verso soluzioni individuali, realizzate secondo i principi fondamentali del marketing. All'interno di questo settore LEITNER ropeways rappresenta un partner straordinario che, in virtù del suo knowhow tecnologico con alto livello di specializzazione unitamente all'offerta di idee creative, pone le basi per un sicuro business di successo. Il sistema di azionamento diretto LEITNER ropeways, unico al mondo nel settore delle funivie, crea nuovi standard di riferimento grazie ad un consumo energetico notevolmente ridotto, a minori costi di manutenzione e con l'ottenimento del massimo livello di silenziosità durante il funzionamento. Per questi motivi un numero sempre crescente di clienti sceglie questo sistema di azionamento diretto ed orienta i propri investimenti verso prodotti dotati di un elevato livello di sostenibilità e compatibilità ambientale.

Italia: meno problemi di traffico e maggiore confort. Nonostante la situazione economica in Italia non sia particolarmente favorevole, è stato comunque possibile portare a termine svariati progetti ambiziosi e di grande prestigio. L'attenzione del pubblico era naturalmente rivolta alla nuova cabinovia a 10 posti sorta in località Plan de Coronas in Alto Adige, che dimostra in modo particolarmente significativo, quanto stiano mutando i requisiti nel settore delle funivie. La nuova cabinovia collega la località di Perca con la vetta e con altre cabinovie di produzione LEITNER ropeways. Per la prima volta questo impianto è in grado di garantire il collegamento diretto alla rete ferroviaria della Val Pusteria. L'amministrazione provinciale prevede, che almeno il 40% del traffico automobilistico diretto verso l'area sciistica venga convogliato verso i mezzi di trasporto pubblici. Questa cabinovia, terzo esempio presente a Plan de Coronas, rappresenta senza dubbio un modello di ampio respiro.

Naturalmente anche le due nuove cabinovie a 8 posti, che garantiscono il collegamento tra le regioni sciistiche di Gitschberg e Jochtal in Alto Adige, sono state concepite con grande attenzione verso l'estetica ed offrono alla propria clientela un elevato livello di confort. I comprensori sciistici di Pinzolo e Madonna di Campiglio in Trentino sono stati collegati con tre cabinovie a 8 posti firmate LEITNER ropeways che si susseguono con trasferimento delle cabine da un impianto all'altro. In tal modo i passeggeri possono viaggiare sul tracciato che da Pinzolo conduce a Madonna di Campiglio e viceversa, senza mai essere costretti a cambiare veicolo.

Il fatto che gli impianti a fune rappresentino un prezioso strumento per l'ottimizzazione del livello qualitativo, viene sottolineato anche

dalle seggiovie presenti nelle località di La Villa e Corvara nel comprensorio sciistico dell'Alta Badia. E' stato adottato il sistema di sicurezza passeggeri, in virtù del quale vengono protetti anche i baby sciatori. Una nuova seggiovia a 6 posti è stata costruita anche sul Passo Sella in Val Gardena.

LEITNER ropeways ha realizzato una nuova cabinovia a 8 posti ad Alleghe a Col dei Baldi nella provincia di Belluno e nel comprensorio del Monte Rosa presso Gressoney in Val d'Aosta. A Monte Magnola in Abruzzo è stata costruita una nuova seggiovia a 6 posti.

Grazie alla creazione di una seggiovia a 4 posti a Col di Lana nella provincia di Belluno e a San Domenico di Varzo in Piemonte, l'offerta è stata ulteriormente incrementata. La località di Roana in Veneto dispone di una nuova seggiovia biposto. Anche nel meridione d'Italia si evidenzia un sempre maggiore interesse verso gli sport invernali. Sull'Etna, in località di Linguaglossa nei pressi di Catania è stata realizzata una sciovia, che presenta le medesime caratteristiche di quelle presenti nelle località di Asiago e Selva di Cadore in Veneto.

Austria: impianti a fune per campionati del mondo ed azionamenti ecologici. Nel 2013 i campionati del mondo di sci alpino avranno luogo a Schladming e LEITNER ropeways, anche in questa occasione, avrà un ruolo da protagonista.

La nuova seggiovia "WM-Shuttle", che lo scorso gennaio in occasione del celebre slalom notturno di Coppa del mondo aveva già ottenuto dei risultati a dir poco eccellenti, porterà gli atleti alla partenza dello slalom speciale. LEITNER ropeways e la regione sciistica di Kitzbühel da molto tempo danno vita ad una partnership di successo. A Resterhöhe nel corso dello scorso anno due vecchi impianti di risalita sono stati sostituiti con una seggiovia a 6 posti, dotata di azionamento diretto di tipo ecologico e silenzioso, che ha aumentato notevolmente la capacità di trasporto. Adesso le piste presso Resterhöhe e Passo Thurn possono essere comodamente raggiunte grazie alle seggiole carenate, dotate di sedili riscaldabili. La garanzia del massimo confort ed un'offerta di livello qualitativo sempre più elevato sono i criteri che garantiscono il successo. E questi principi sono stati attuati anche presso le località di Almbahnen di Finkenbergl nella Valle Tuxer. La vecchia seggiovia biposto „Katzenmoos“ è stata sostituita con una seggiovia a 6 posti di LEITNER ropeways. Le seggiole sono dotate di sedili riscaldabili che conducono gli sciatori in modo più agevole e rapido direttamente sulle piste. Adesso è possibile trasportare fino a 2.800 persone all'ora e gli ospiti hanno accolto questa novità con grande entusiasmo, come viene confermato dalla direzione aziendale di Almbahnen.

Altri due ambiziosi progetti sono stati realizzati a Goldeck presso Spittal sulla Drava. Una cabinovia a 8 posti, lunga oltre 3 chilometri che supera un dislivello di 1.200 metri è infatti ora in grado di trasportare gli sciatori da valle direttamente sulle piste. Sempre in quella località inoltre la vecchia sciovia "Bärnbiss" è stata sostituita con una seggiovia a 6 posti, in grado di garantire il massimo livello di confort.



Svizzera: il lusso, un vero e proprio piacere per gli occhi e non solo.

La nuova seggiovia a 6 posti realizzata da LEITNER ropeways presso Laax Grigioni fa davvero scalpore da svariati punti di vista. In soli cinque mesi LEITNER ropeways è stata infatti in grado di realizzare qui una delle seggiovie più rapide e moderne (con una velocità di 6 metri al secondo) delle Alpi, dotata di sedili riscaldabili, seggiole carenate e sistema di sicurezza per i passeggeri. Un ulteriore tocco di classe è dato dal suo design, che propone le seggiole completamente nere. Grazie al suo innovativo sistema di azionamento diretto, questa seggiovia risulta essere particolarmente silenziosa e necessita di un minore consumo di energia.

Germania: massimo rispetto per l'ambiente nella regione del Sauerland.

Anche a Winterberg nella regione del Sauerland è possibile godere dei grandi vantaggi derivanti dall'introduzione del sistema di azionamento diretto di LEITNER. La nuova seggiovia a 6 posti "Büre Bremberg X-Press" con seggiole carenate, la prima dotata di sistema di azionamento diretto in Germania, va a sostituire il vecchio "Talexpress". Grazie all'introduzione di ulteriori innovazioni è stato inoltre possibile ottenere il massimo livello di confort e di rispetto per tutto l'ambiente naturale circostante. La seggiovia è stata realizzata per mezzo di apparecchiature del massimo livello qualitativo, come la barra di sicurezza bloccabile dotata di poggiasci, uno strumento ideale al fine di garantire la massima sicurezza dei passeggeri. Visto che la stazione a valle confina con un'area idrica protetta, l'impianto verrà dotato di prodotti lubrificanti eco-compatibili.

Lo straordinario progetto realizzato presso l'aeroporto di Francoforte esplica la duplice funzione a dimostrazione da un lato dell'enorme potenzialità di questi sistemi di trasporto, e dall'altro l'eccezionale versatilità che caratterizza il loro campo di applicazione. La "Squire Metro" collega l'avanguardistico edificio "The Squire" con il parcheggio. "The Squire" è uno dei maggiori edifici destinati ad uffici esistente al mondo, ed al suo interno ospita una vera e propria città, dotata di tutti i servizi. Sebbene il collegamento al parcheggio copra una distanza di soli 300 metri circa, il tragitto offre comunque uno spettacolo assolutamente imperdibile. Questa funicolare, dotata di comandi automatici e cavo di trazione, si libra sopra l'autostrada e la linea ferroviaria a 18 metri di altezza; opera in esercizio ad emissioni zero, garantendo il recupero dell'energia di frenata e, in caso di ridotto numero di passeggeri, utilizzando comunque un minore livello di consumo energetico.

Europa centrale: i nuovi mercati in via di sviluppo richiedono un sempre più elevato livello di tecnica e confort.

Nelle regioni sciistiche dell'Europa centrale viene prestata un'attenzione sempre crescente ad elementi quali il confort e la tecnologia. Presso la regione sciistica di Tatranská Lomnica in Slovacchia LEITNER ropeways è stata incaricata della realizzazione della prima seggiovia a 8 posti della nazione. L'impianto è dotato di seggiole carenate che possono essere immagazzinate all'interno della stazione a valle. Questa seggiovia presenta un altro dettaglio straordinario che rivolge lo sguardo verso il futuro. Grazie alle cupole blu, risultato della cooperazione di LEITNER ropeways ed il produttore di occhiali Scott, gli sciatori sa-

ranno sempre accompagnati da un magnifico cielo azzurro durante tutto il percorso in seggiovia.

Anche la nuova seggiovia a 6 posti nella località di Pasięka in Białka Tatrzańska, presso la principale area sciistica della Polonia, è in grado di soddisfare tutti i moderni parametri della tecnologia più sofisticata. Oltre ai sedili riscaldabili e le cupole blu, le seggiole sono dotate di sistema di sicurezza per i passeggeri. Inoltre l'impianto è provvisto di un azionamento diretto silenzioso ed ecologico. Questa seggiovia, che risulta molto economica grazie ai costi ridotti sia per quanto riguarda il consumo energetico che per la manutenzione, è in grado di trasportare fino a 3.000 persone all'ora.

Il mercato dell'Europa centrale, unitamente a quello dell'Europa orientale, è caratterizzato da una forte spinta verso lo sviluppo. E proprio per questo motivo per LEITNER ropeways l'apertura di una nuova sede a Stará Ľubovňa nel nord-ovest della Slovacchia è stato un passaggio naturale, finalizzato all'acquisizione ed allo sviluppo di nuovi mercati. Dall'inizio del 2011 circa 40 collaboratori si occupano della produzione dei componenti principali per impianti a fune su di una superficie di oltre 1.800 metri quadrati. Inoltre LEITNER ropeways dispone di una filiale in loco per la vendita e l'assistenza ai clienti.

Europa del nord: SkiStar può contare su nuovi impianti a fune.

Lo sci in Svezia è uno sport molto popolare. Oltre un quarto degli svedesi pratica questo sport. Il gruppo svedese SkiStar Group rappresenta una delle maggiori imprese nel settore dello sci in Europa e da molti anni è legato a LEITNER ropeways in virtù di una proficua collaborazione professionale. Nel 2011 LEITNER ropeways è stata incaricata da SkiStar Group della realizzazione di una seggiovia a 6 posti presso la località di Vemdalen. Questo impianto, con i suoi 592 metri di lunghezza inclinata, è il più rapido impianto in Svezia ed il primo ad essere dotato di un sistema di sicurezza per i passeggeri. LEITNER ropeways ha ottenuto dei buoni successi anche presso la località di Klövsjö, anch'essa gestita dal gruppo SkiStar, grazie alla realizzazione di un impianto di risalita. Mentre nella regione sciistica di Idre LEITNER ropeways ha realizzato una seggiovia a 6 posti e due sciovie.

Anche in Norvegia sono stati realizzati degli impianti di risalita da parte di LEITNER ropeways. A Vikersund è sorta una nuova seggiovia, mentre presso le località di Trysil ed Eidfjord una sciovia.

Asia Occidentale: nuovi progetti per gli sport invernali ed una cabinovia sulla spiaggia.

La Turchia rappresenta un mercato molto interessante, caratterizzato da una situazione economica molto dinamica ed in forte espansione. Nel 2011 LEITNER ropeways ha potuto realizzare nella località di Dorukkaya/Bolu, situata a circa due ore di auto dalla città di Ankara, una nuova seggiovia a 4 posti.

La nuova cabinovia a 8 posti di Ordu, una pittoresca città sulla costa del Mar Nero, percorre invece tutta un'altra via. La cabinovia collega infatti la spiaggia ed il quartiere urbano con l'area ricreativa di Boztepe, contribuendo a ridurre notevolmente il traffico cittadino.



Gli impianti di risalita alla conquista del mondo. Questa affermazione, che di primo acchito potrebbe sembrare eccessiva, risulta invece essere ampiamente supportata da numerosi progetti più che concreti. E questo offre la possibilità di dimostrare, quanto i tre già citati punti di forza distintivi di LEITNER ropeways, ossia lo sport invernale, l'utilizzo turistico alternativo e l'utilizzo per il trasporto delle persone in un contesto urbano, abbiano enormi potenzialità di sviluppo. In generale è già ora possibile affermare che la situazione degli ordini per l'anno 2012 risulta essere molto favorevole, soprattutto grazie alla crescita costante della domanda a livello internazionale.

Sport invernale. Nel settore dello sport invernale si rileva una forte tendenza verso il rispetto e la sostenibilità ambientale, unitamente alla richiesta di confort di livello sempre più elevato ed di design raffinato. All'inizio del prossimo inverno, nella località di Savognin in Svizzera verrà messa in funzione la prima cabinovia a 10 posti del paese. La nuova cabinovia "Tignes-Somtgant" sarà in grado di trasportare fino a 2.600 persone all'ora e, grazie alle sue caratteristiche multifunzionali, potrà offrire il massimo livello di confort durante tutto il corso dell'anno.

Ad Avoriaz in Francia LEITNER ropeways si sta occupando della costruzione di una funivia trifune, che collega le località di Avoriaz e Morzine, che non viene utilizzata solo per il trasporto degli sciatori, ma anche per il trasporto dei visitatori in arrivo ed in partenza. Si tratta quindi di un riuscito connubio tra le esigenze dello sport invernale e quelle del trasporto pubblico locale.

Il nuovo impianto sulla Sniezka, la cima più elevata della Repubblica Ceca, rappresenta un progetto molto promettente e prestigioso. La

cima di questa imponente montagna rappresenta una delle principali destinazioni turistiche del paese. Anche per quanto riguarda la Turchia, presso la maggiore area sciistica di Kayseri, e la Romania sono stati progettati nuovi impianti, alcuni già in costruzione.

In occasione dei prossimi Giochi Olimpici Invernali che avranno luogo nel 2014 a Sotschi sciatori e snowboarder si muoveranno agevolmente ed in totale sicurezza e confort grazie agli impianti di LEITNER ropeways. LEITNER ropeways si sta occupando della costruzione di due impianti per le gare di halfpipe e moguls.

Utilizzo turistico alternativo. Gli impianti a fune rendono più agevolmente accessibili le attrazioni turistiche ed allo stesso tempo rappresentano una soluzione al problema del traffico urbano. Quando poi le stesse funivie diventano un'attrazione turistica, come accade a Tbilisi, la capitale della Georgia, allora questi impianti diventano anche particolarmente redditizi. A Tbilisi entro la primavera verrà messa in funzione una nuova cabinovia a 8 posti, che condurrà direttamente dal parco al castello.

Sistemi di trasporto urbano. La cabinovia a 10 posti a Miocable nella località di Santiago de Cali in Colombia verrà collegata alla rete di trasporto pubblico locale e sarà in grado di trasportare fino a 22.000 persone al giorno. In questo modo viene colmata la lacuna di un quartiere che fino ad ora non era servito nemmeno del trasporto degli autobus pubblici. Infine a Manizales verrà ampliato l'impianto esistente già dal 2009, per mezzo dell'aggiunta di una nuova sezione.











Alcuni esempi di 365 giorni di attività ...

MM50 SQUAIRE METRO

Frankfurt / DE

	300 m		165 kW
	2 m		2
	3400 p/h		8

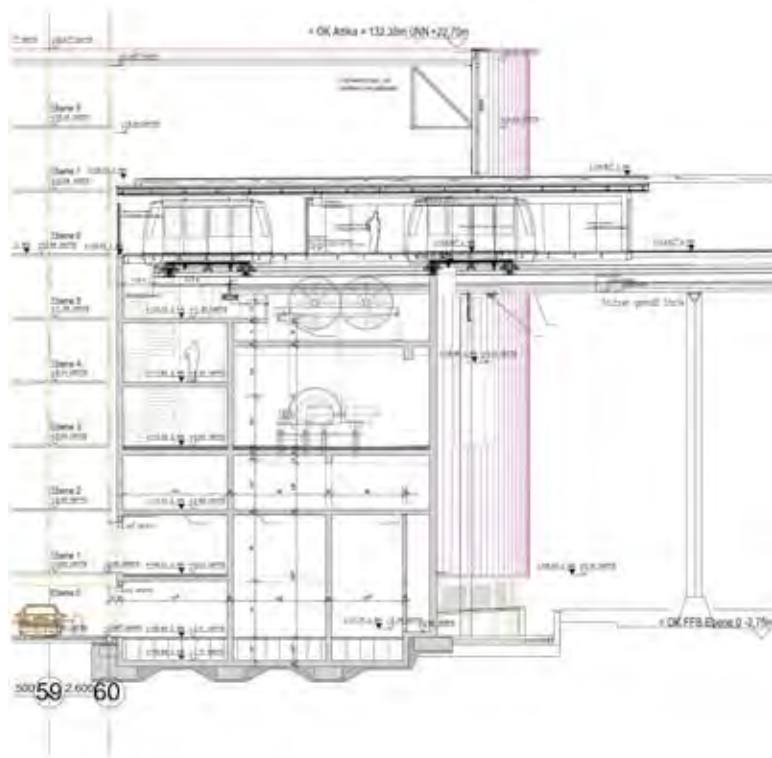



KPMG

Metrolink





GD10 RIED

Kronplatz / Plan de Corones (BZ) / IT

↗	4340 m	⚙️	1340 kW
↕	801 m	🗣️	144
👤👤👤	3200 p/h	📏	24

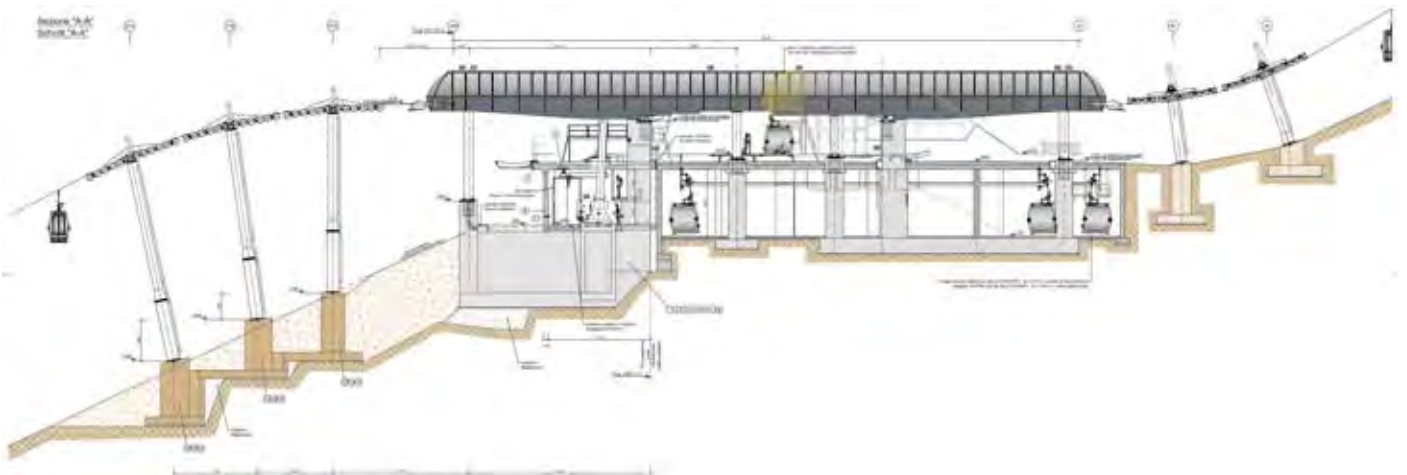



KRONPLATZ
PART OF...

RIED - GIPFEL

36

Seat Heated









GD8 PUZA DAI FÒ - PLAZA

Pinzolo (TN) / IT

↗	1224 m	⊕	245 kW
↕	513 m	☒	33
👤👤👤	1800 p/h	⌋	9

GD8 PLAZA - COLARIN

Pinzolo (TN) / IT

↗	2354 m	⊕	310 kW
↕	356 m	☒	57
👤👤👤	1800 p/h	⌋	16

GD8 COLARIN - PATASCOSS

Pinzolo (TN) / IT

↗	1156 m	⊕	185 kW
↕	246 m	☒	32
👤👤👤	1800 p/h	⌋	10

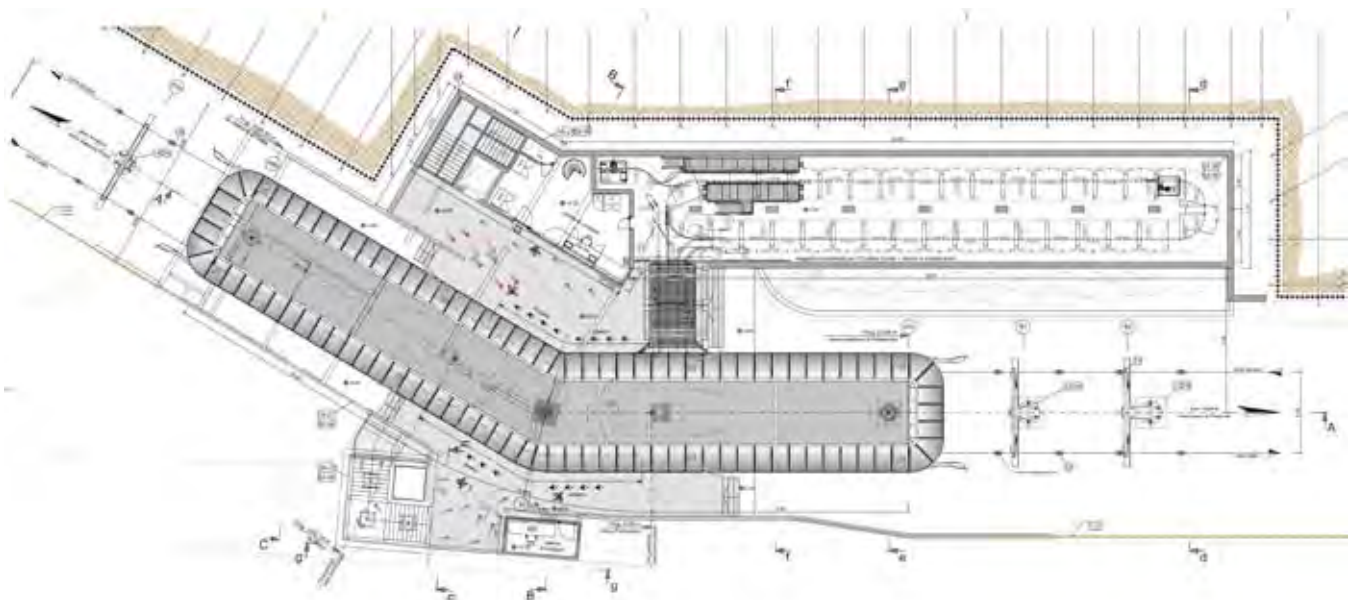



45

PINZOLO
CAMPIGLIO
EXPRESS



45









GD8 GAISJOCH

Meransen / Maranza (BZ) / IT

↗	1963 m	⊕	325 kW
↕	178 m	☰	21
👤👤	800 p/h	⌚	9

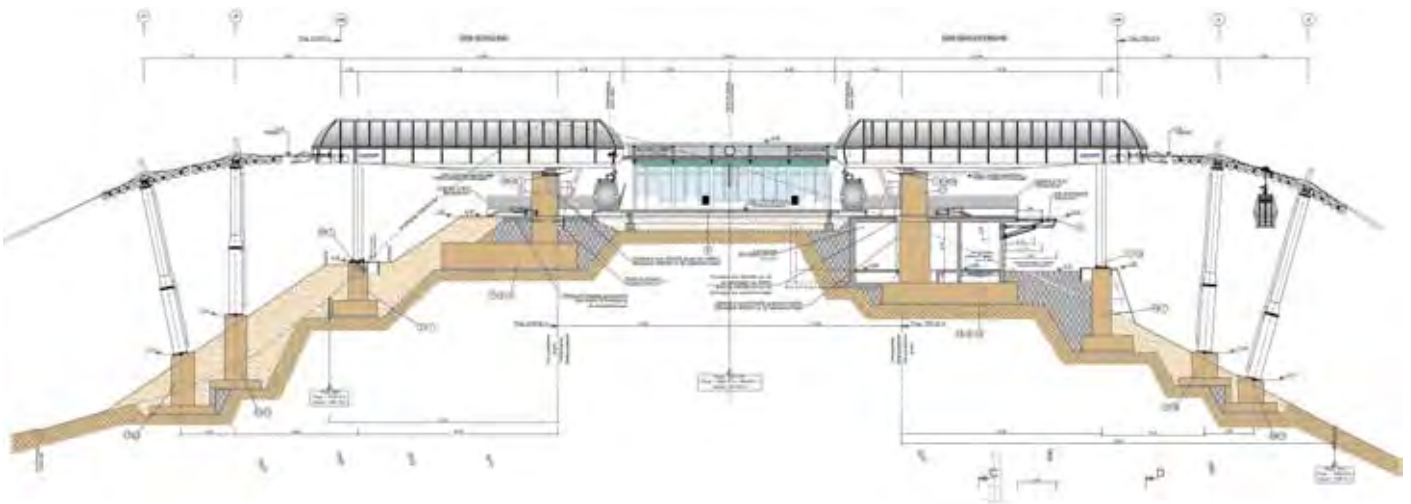













GD8 SCHILLING

Vals / Valles (BZ) / IT

 2046 m	 590 kW
 439 m	 63
 2200 p/h	 16

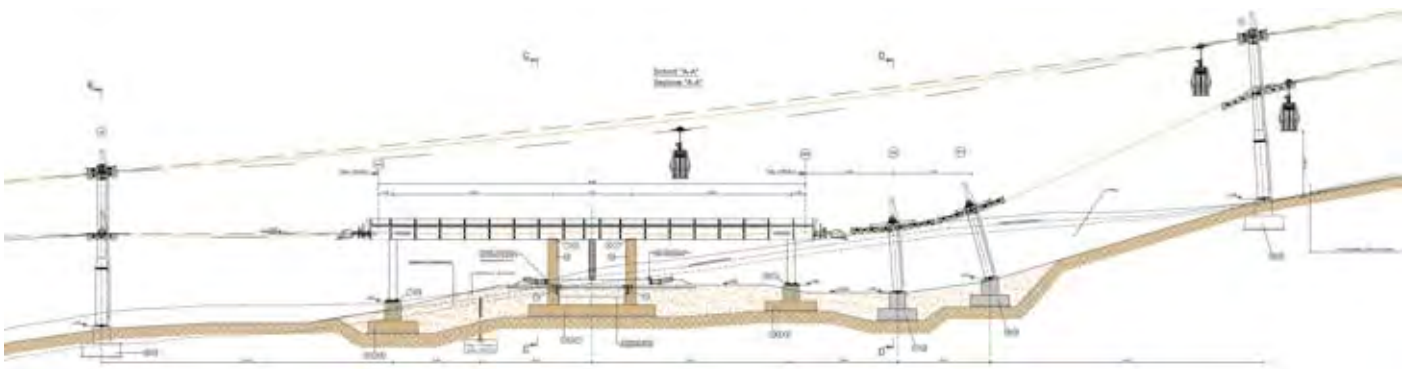

LEITNER
ropeways®





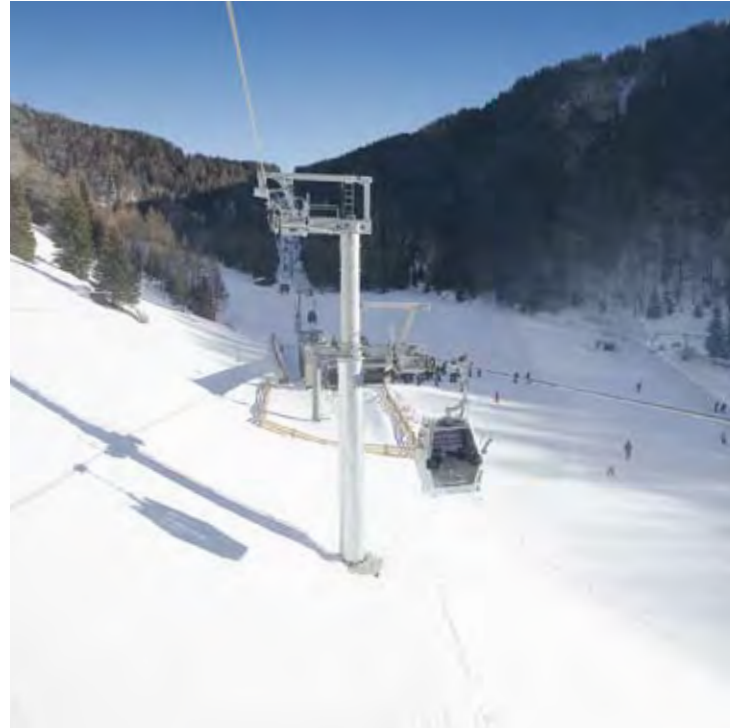







GD8 COL DEI BALDI

Alleghe (BL) / IT

	1986 m		670 kW
	469 m		75
	2800 p/h		15

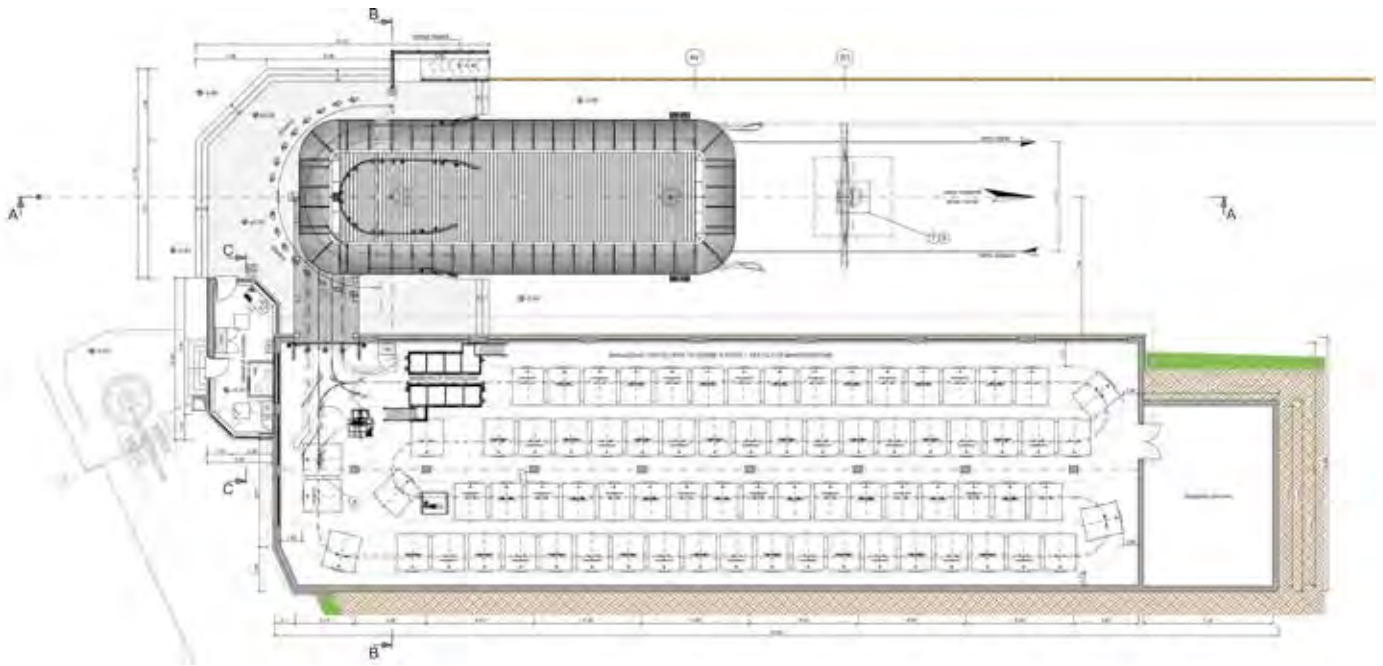











GD8 STAFAL - GABIET

Gressoney la Trinité (AO) / IT



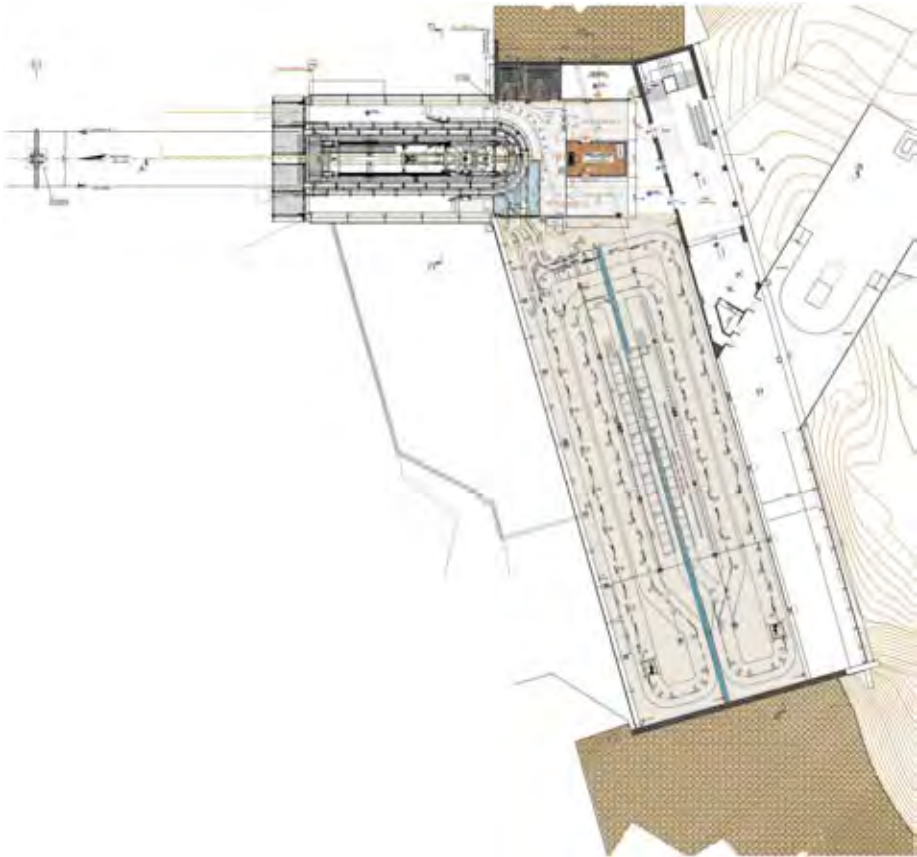



	2566 m		590 kW
	487 m		80
	2400 p/h		17





GD8 TALBAHN

Spittal an der Drau / AT

	3028 m		1077 kW
	1233 m		94
	2400 p/h		17

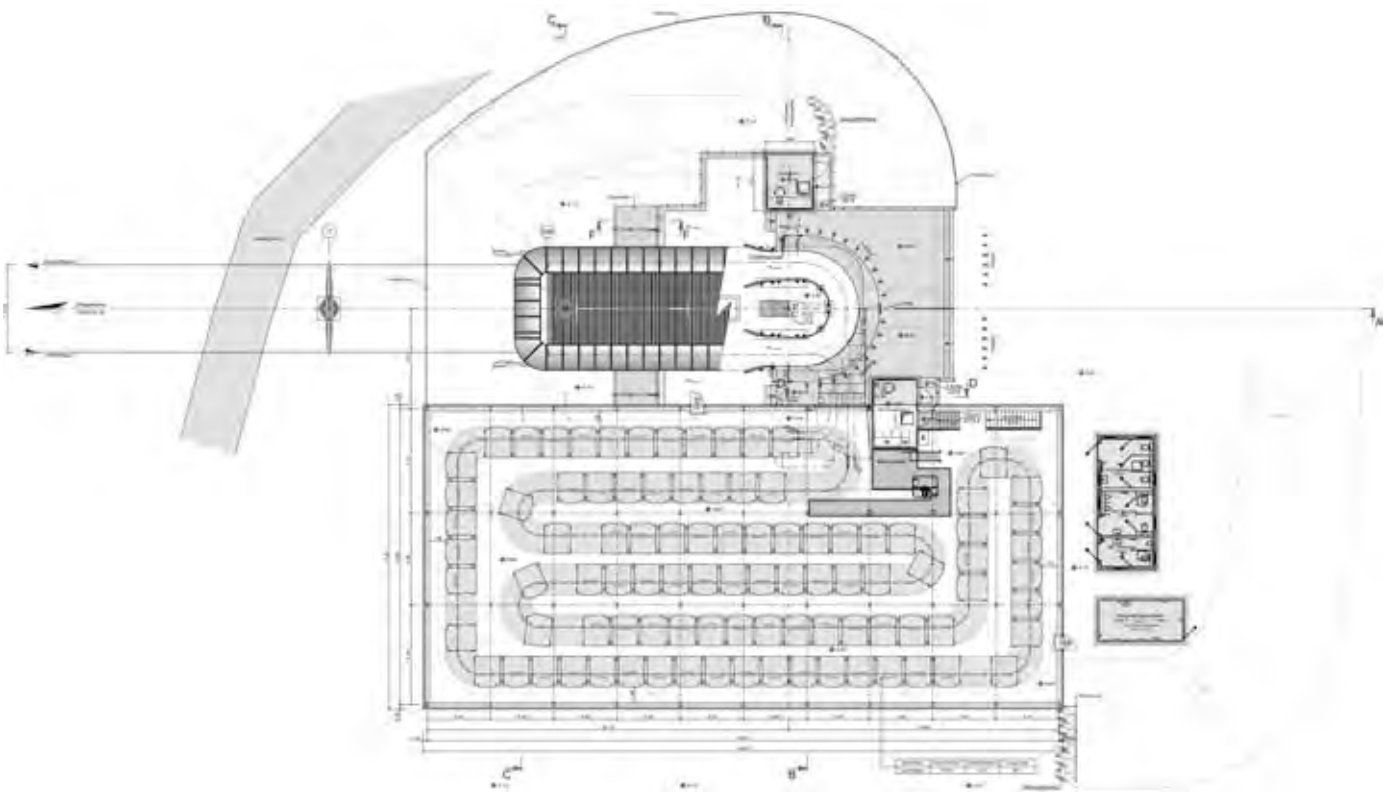







GD8 GAZIANTEP

Gaziantep / TR

↗	904 m	⚙️	98 kW
↕	3 m	🗉	20
👤👤👤	1000 p/h	🔧	4

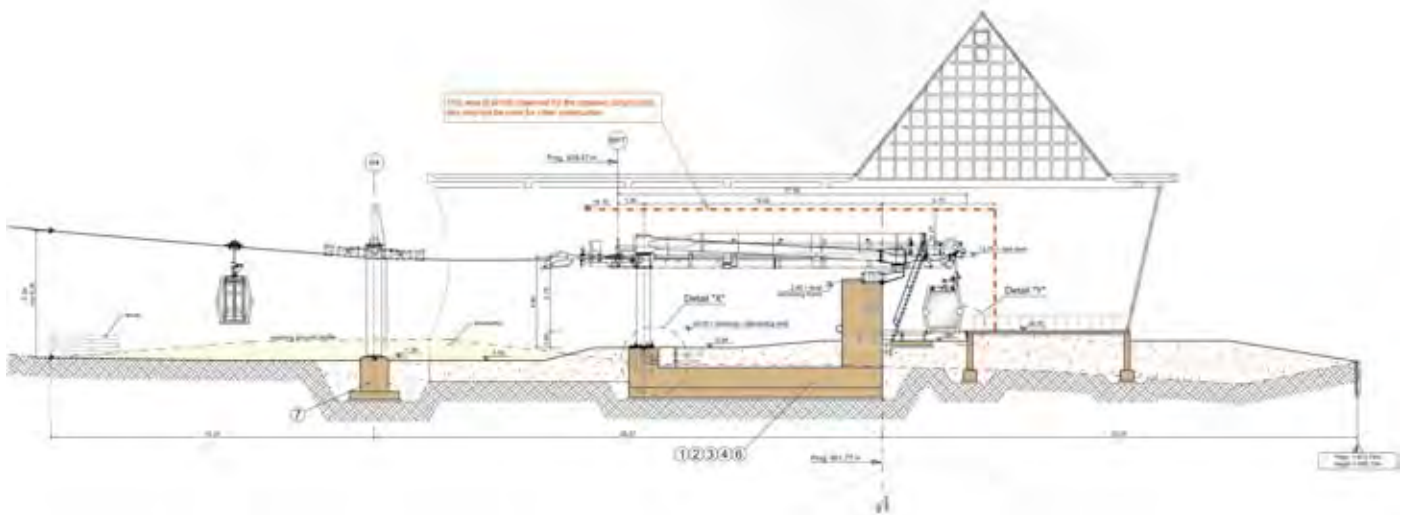







GD8 ORDU-BOZTEPE

Ordu / TR

↗ 2372 m	⊕ 341 kW
↕ 501 m	☞ 28
👤 900 p/h	⌚ 7

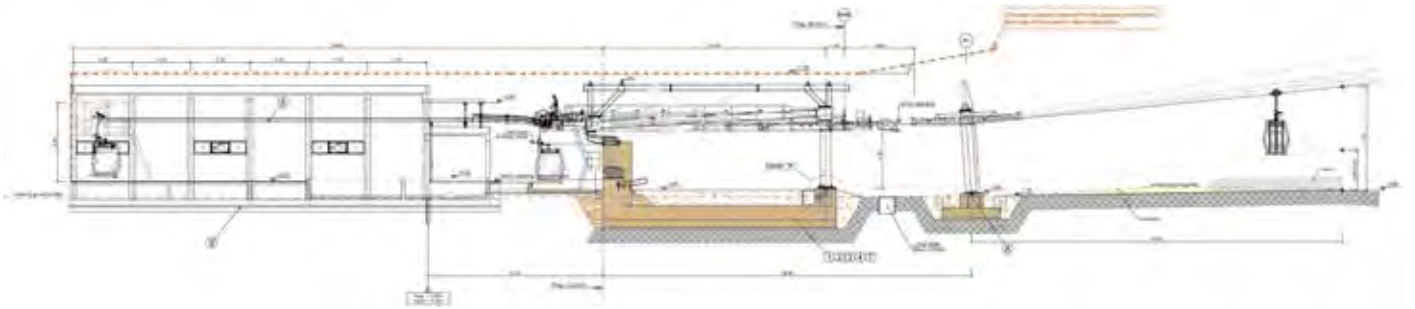













CD8C BUKOVA HORÁ - LOMNICA

Tatranska Lomnica / SK

	683 m		250 kW
	132 m		27
	2400 p/h		7

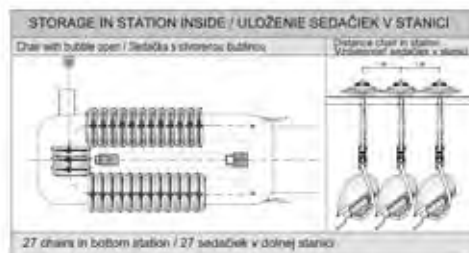
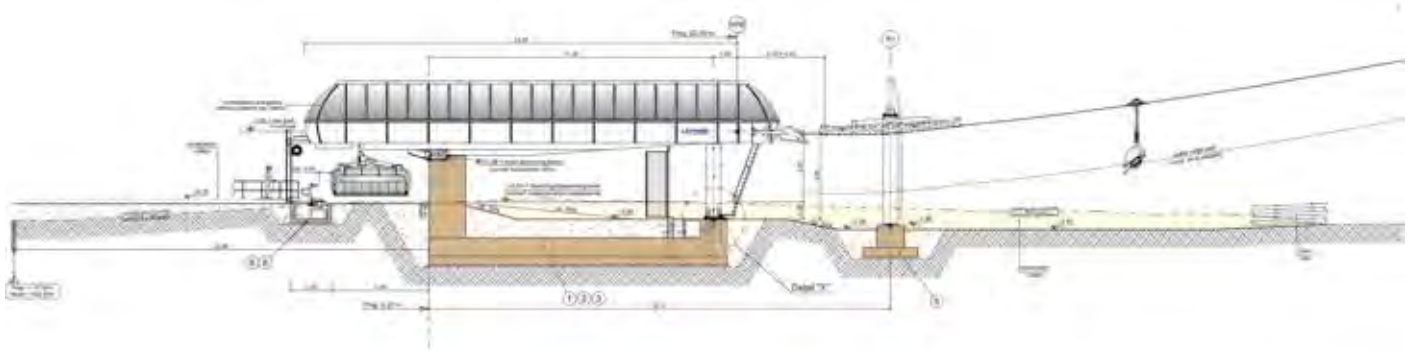







CD6C ALP DADO

Laax / CH

↗	1576 m	⚙️	560 kW
↕	369 m	🗣️	86
👤👤👤	3200 p/h	⌚	13

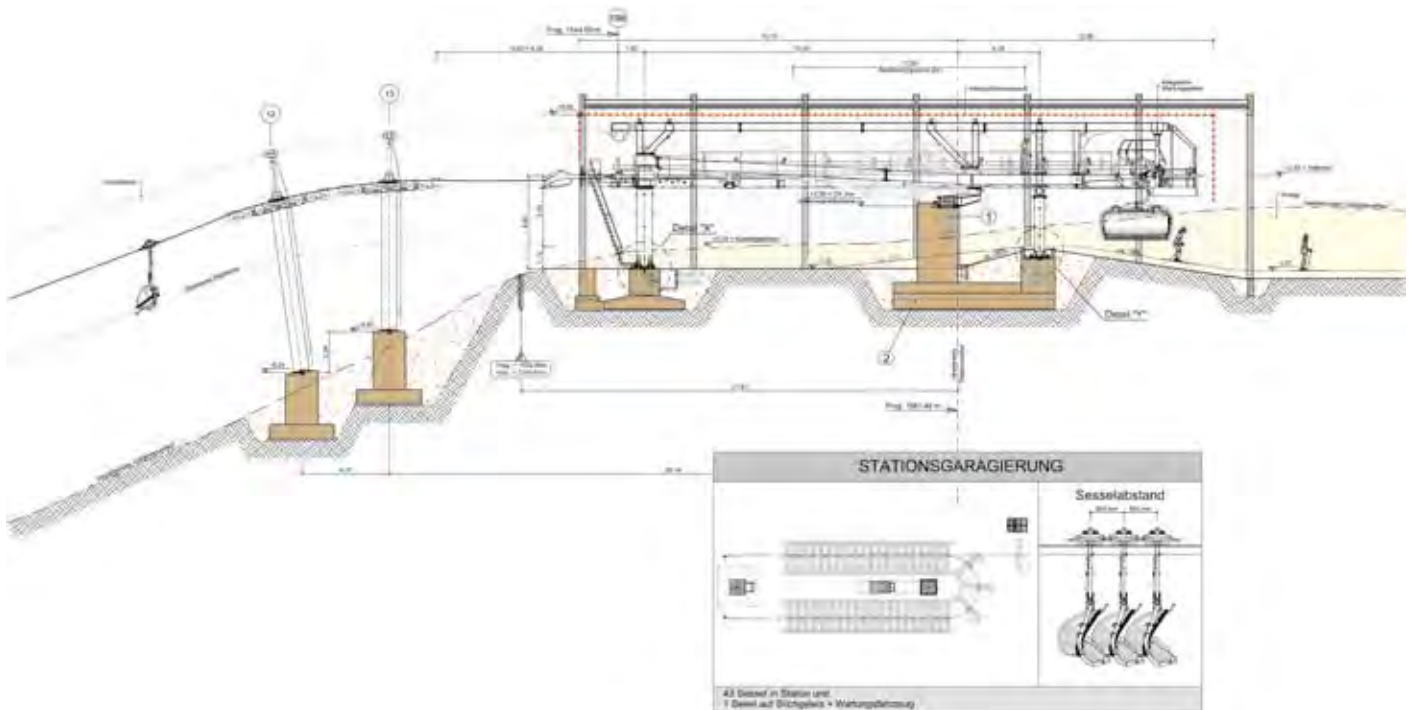

















CD6C RESTERHÖHE

Kitzbühel / AT

	1528 m		536 kW
	507 m		73
	2400 p/h		12

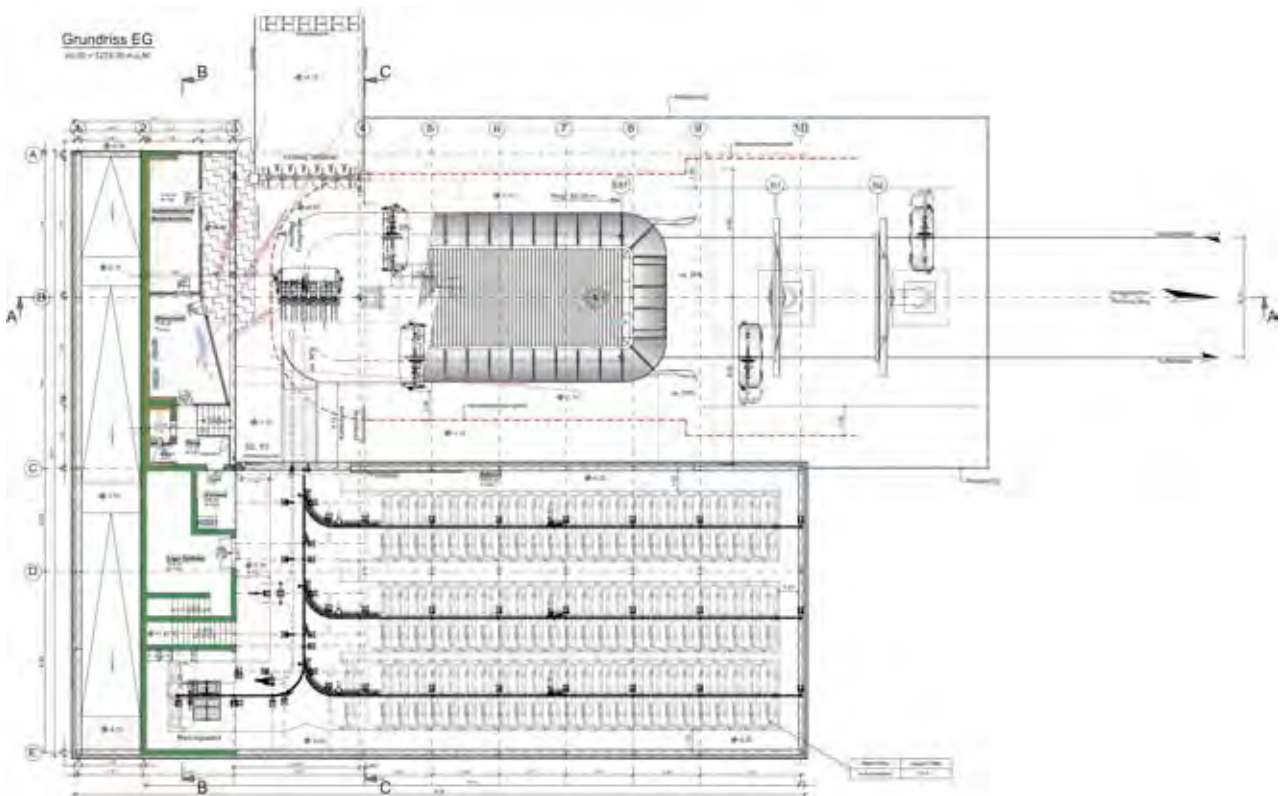

















CD6C KATZENMOOS

Finkenberg / AT

	1488 m		666 kW
	580 m		83
	2800 p/h		12

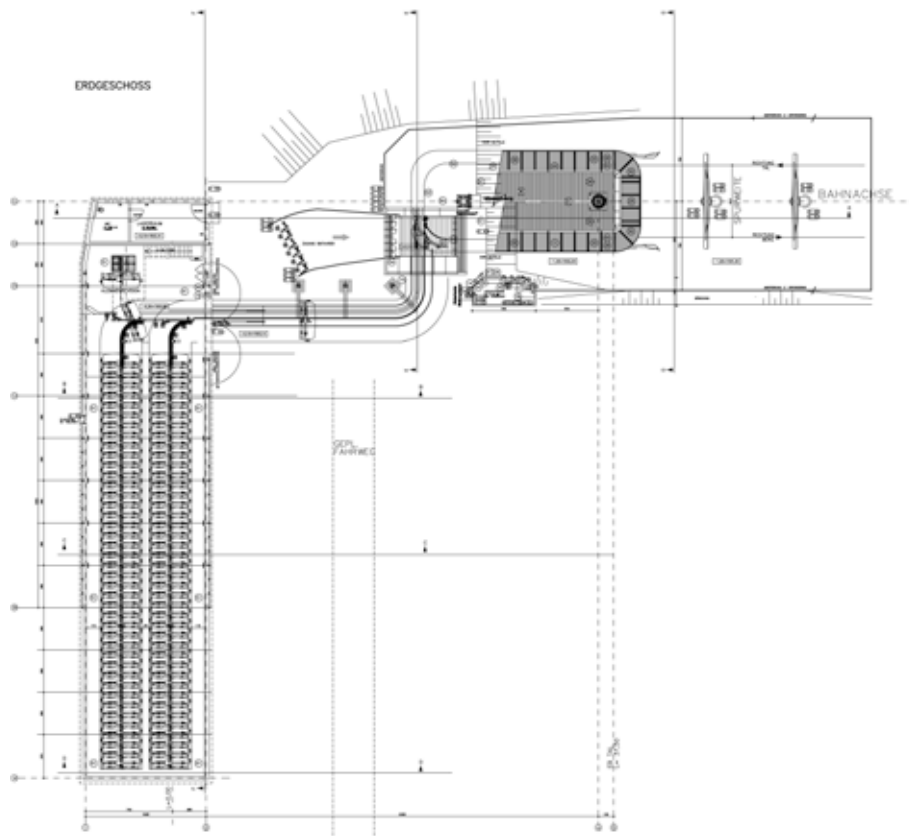

















CD6 BÄRNBISSBAHN

Spittal an der Drau / AT

	1366 m		458 kW
	421 m		82
	3000 p/h		11

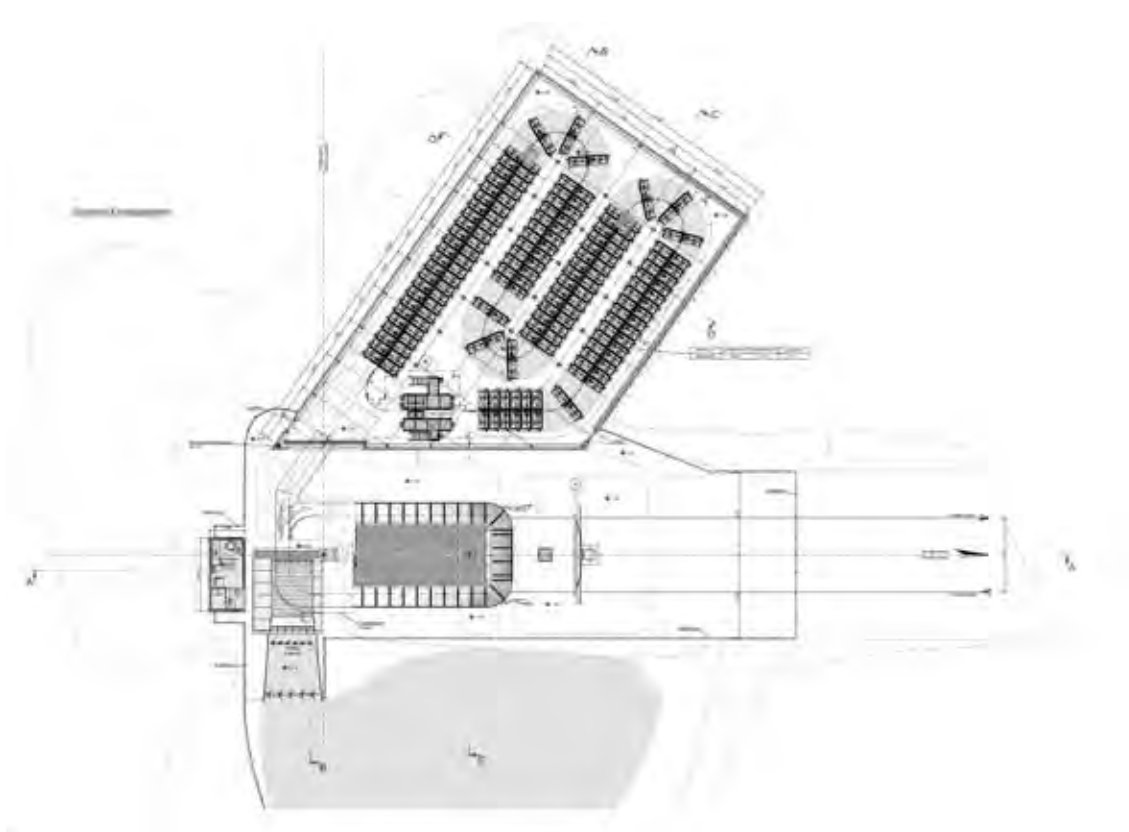



Bärnbissbahn







Bärnbissbahn
1.907 m Bergstation





CD6 BÜRE BREMBERG X-PRESS

Winterberg / DE

 761 m	 200 kW
 127 m	 48
 3000 p/h	 7

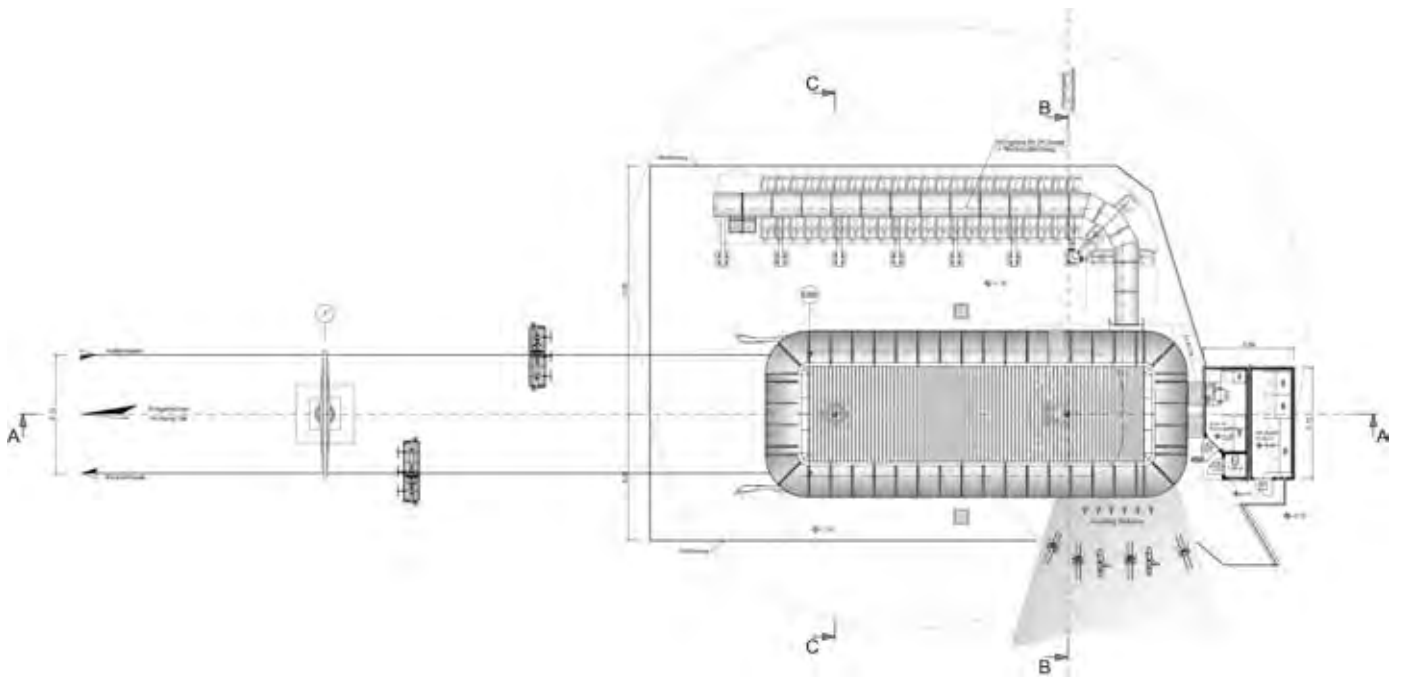













CD6C PASIEKA EXPRESS

Bialka Tatrzańska / PL

	1064 m		300 kW
	175 m		66
	3010 p/h		10

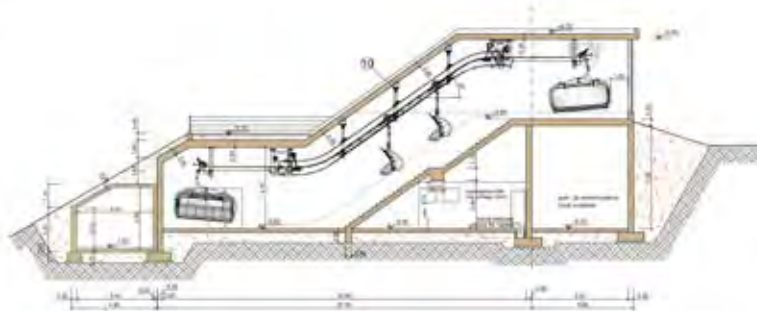
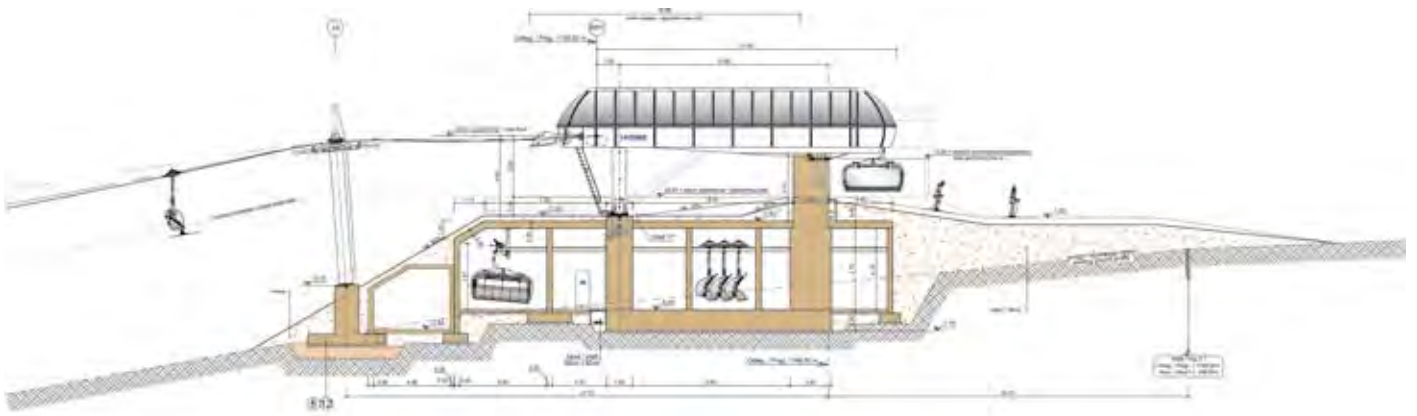













CD6 OST 6:AN

Idre / SE

	1101 m		314 kW
	207 m		72
	3200 p/h		11

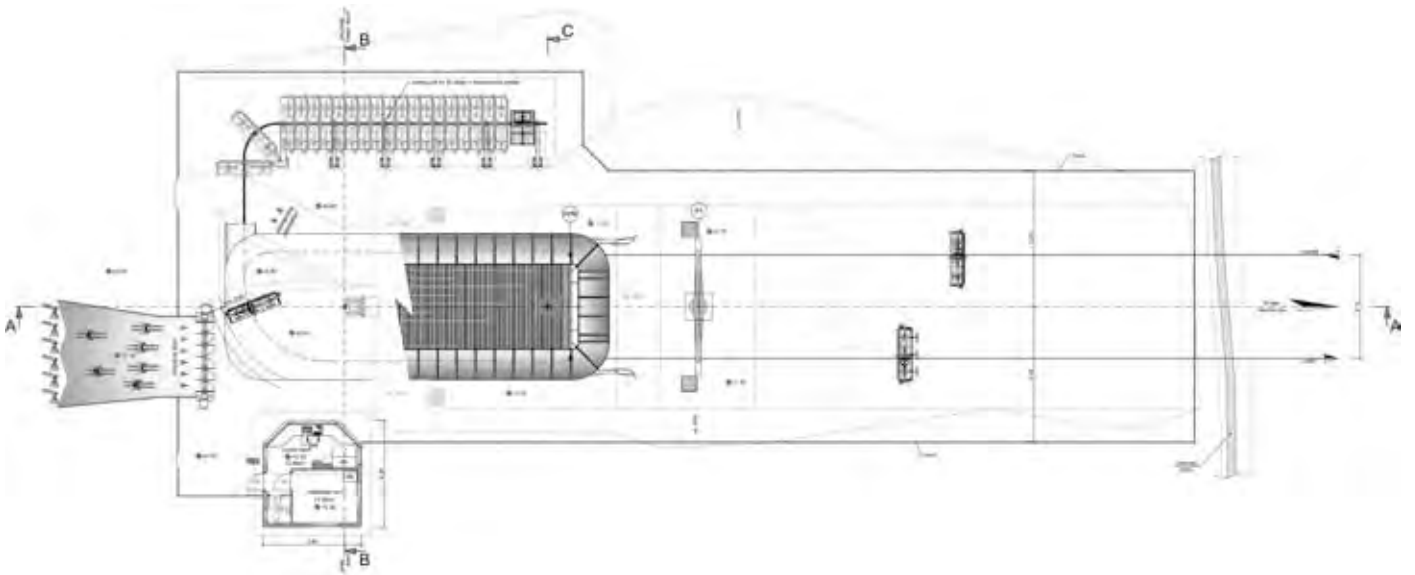







CD6 SKALET EXPRESS

Vemdalen / SE

↗ 592 m

↕ 99 m

👤👤👤 2400 p/h

⚙️ 167 kW

☎️ 35

🚪 8

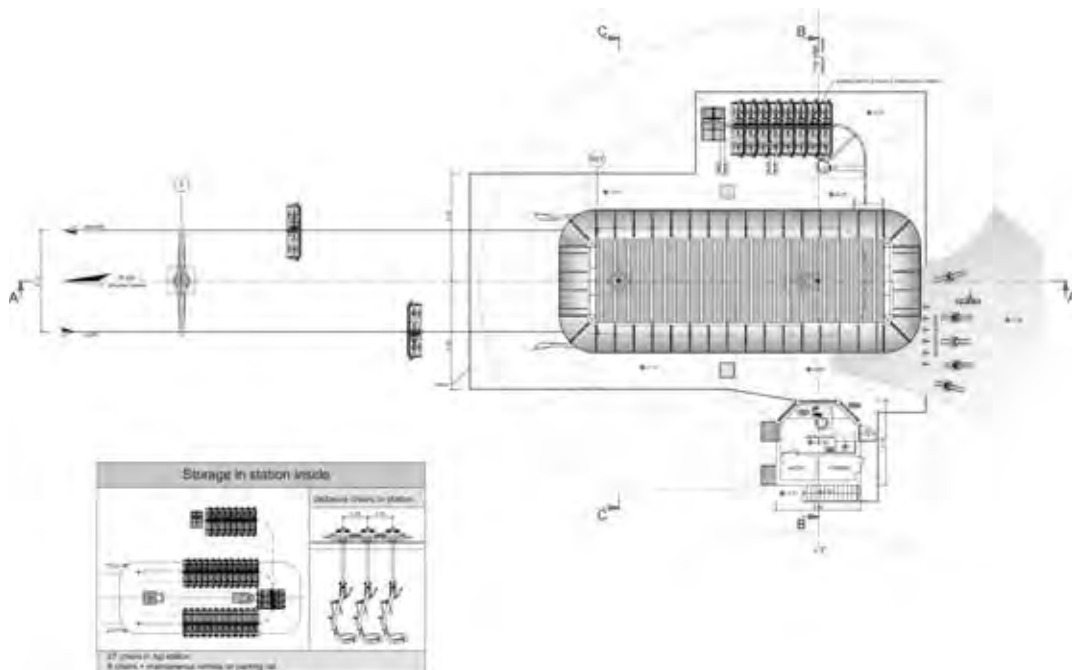



CD6 BAMBY

La Villa (BZ) / IT

↗	774 m	⚙️	380 kW
↕	290 m	🗉	46
👤👤	2800 p/h	⌚	8

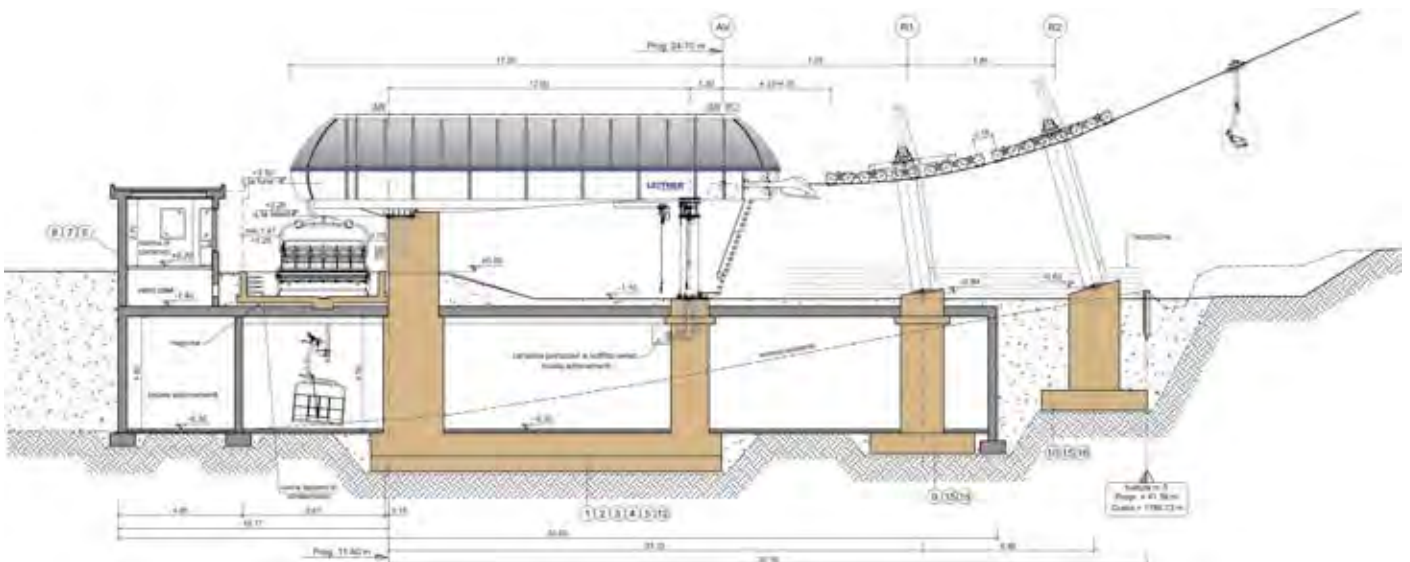







CD6 SASSO LEVANTE

Wolkenstein / Selva Gardena (BZ) / IT

↗ 1128 m

↕ 201 m

👤👤👤 2600 p/h

⚙️ 347 kW

☎️ 60

🔧 12

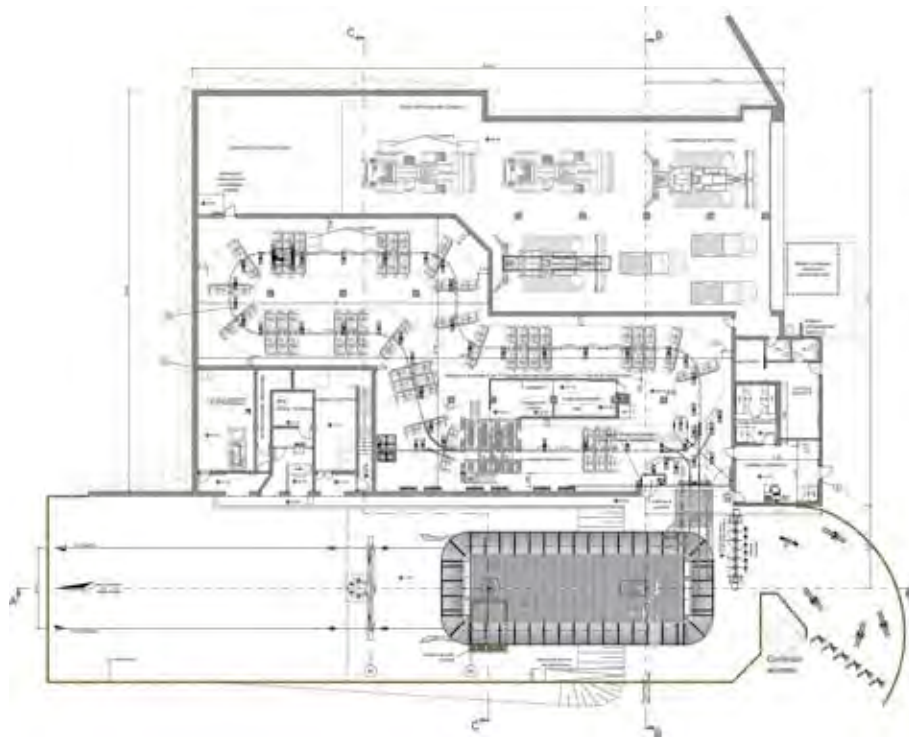







CD6 FONTE FREDDA - MONTE FREDDO

Ovindoli (AQ) / IT

↗ 1678 m

↕ 505 m

👤 3000 p/h

⚙️ 620 kW

☎️ 99

⌚ 17

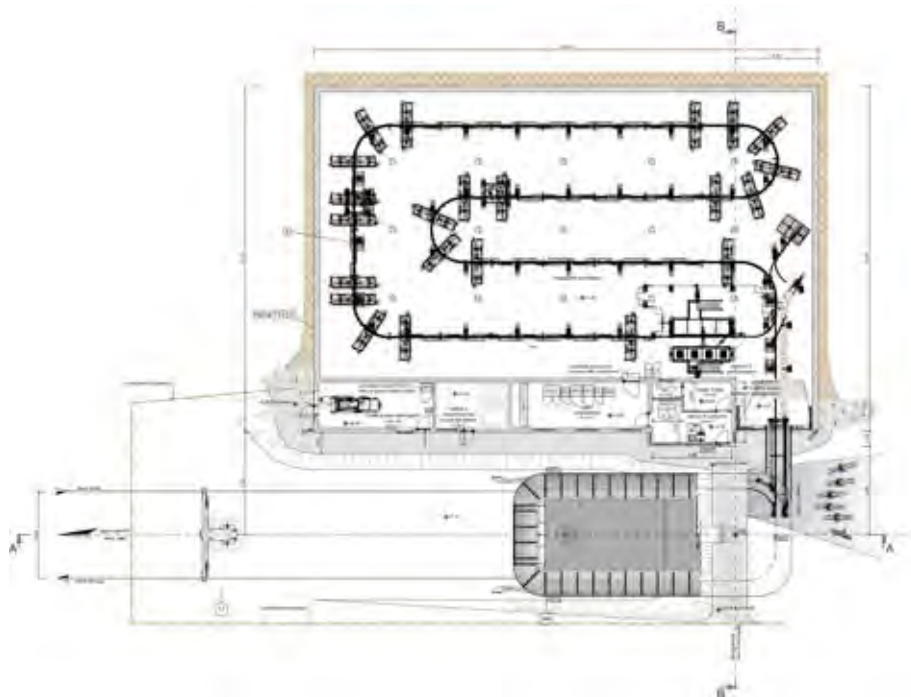













CD6 COVETAN

Les Saisies / FR

	1496 m		630 kW
	357 m		71
	2600 p/h		14

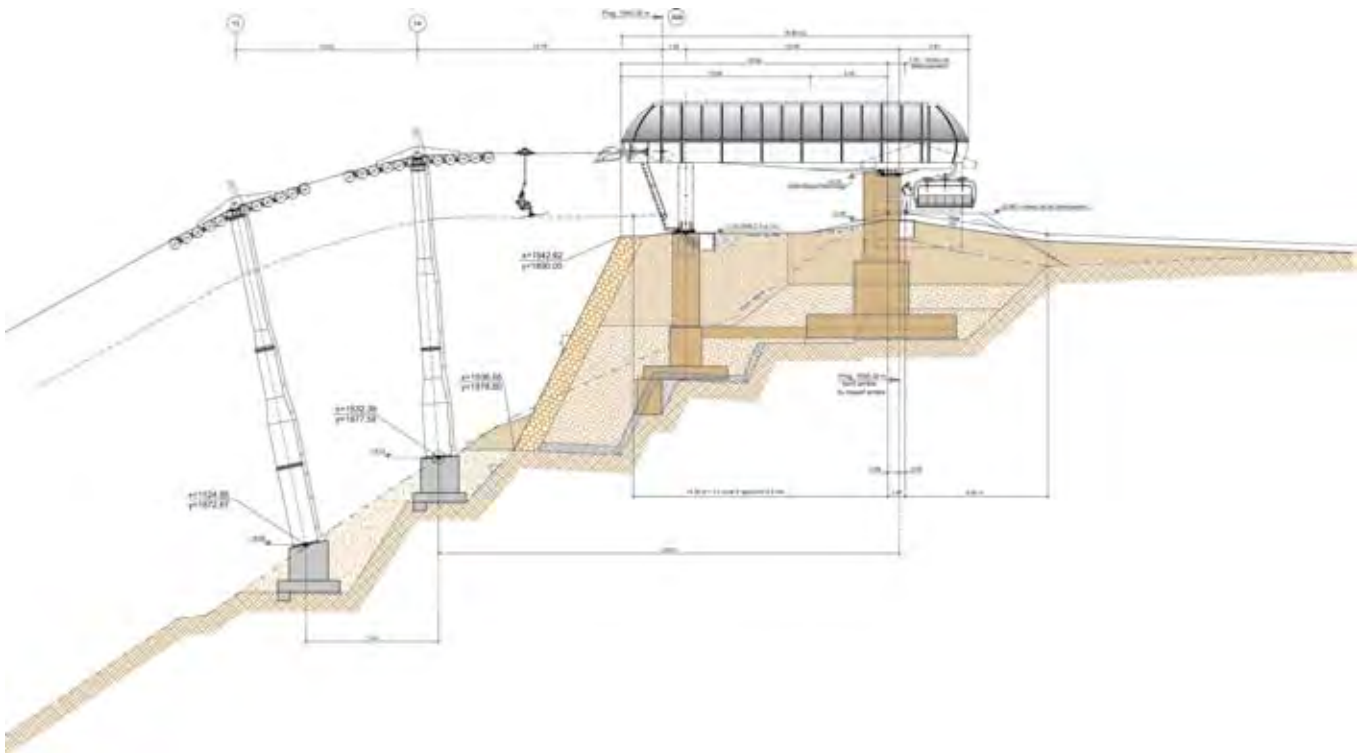



LEITNER
ropeways







LEITNER





CD6 LES JEUX

Valmeinier / FR

	1829 m		880 kW
	620 m		98
	3200 p/h		15

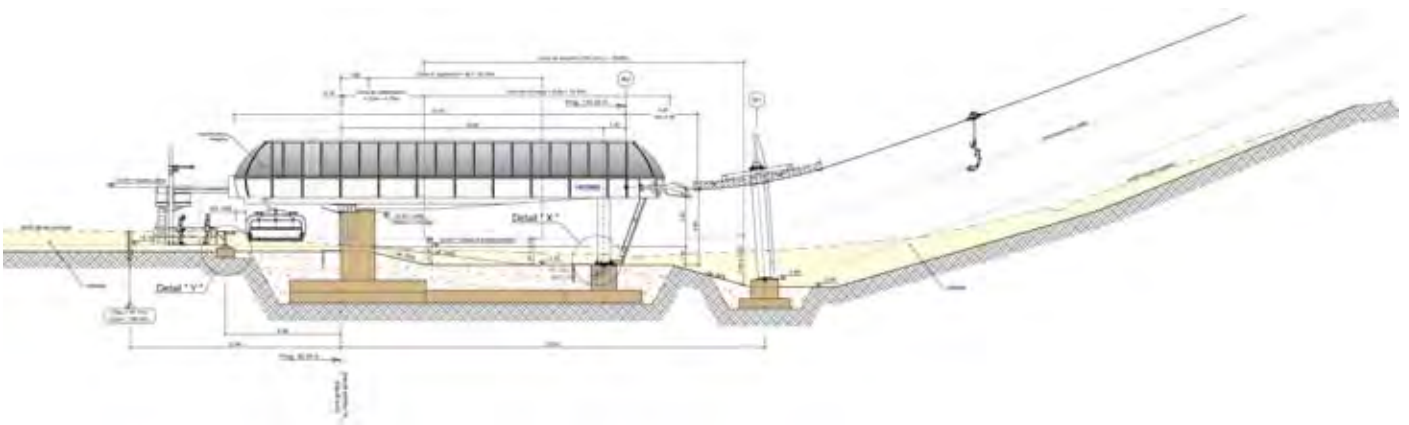













CD4C DORUKKAYA

Dorukkaya-Bolu / TR

	1160 m		250 kW
	339 m		42
	1211 p/h		9









CF4 CHERZ 1

Livinallongo (BL) / IT

↗	965 m	⚙️	199 kW
↕	243 m	🗉	131
🚶🚶🚶	2400 p/h	⚓	11

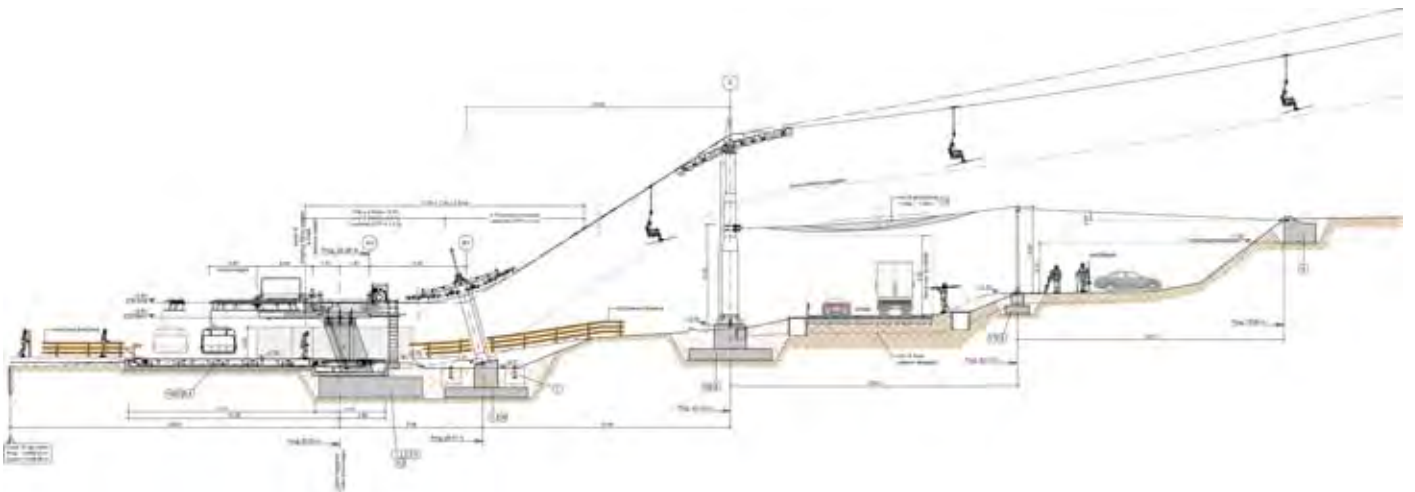













CF4 CIAMPORINO

Varzo (VB) / IT

	1227 m		220 kW
	236 m		165
	2387 p/h		12

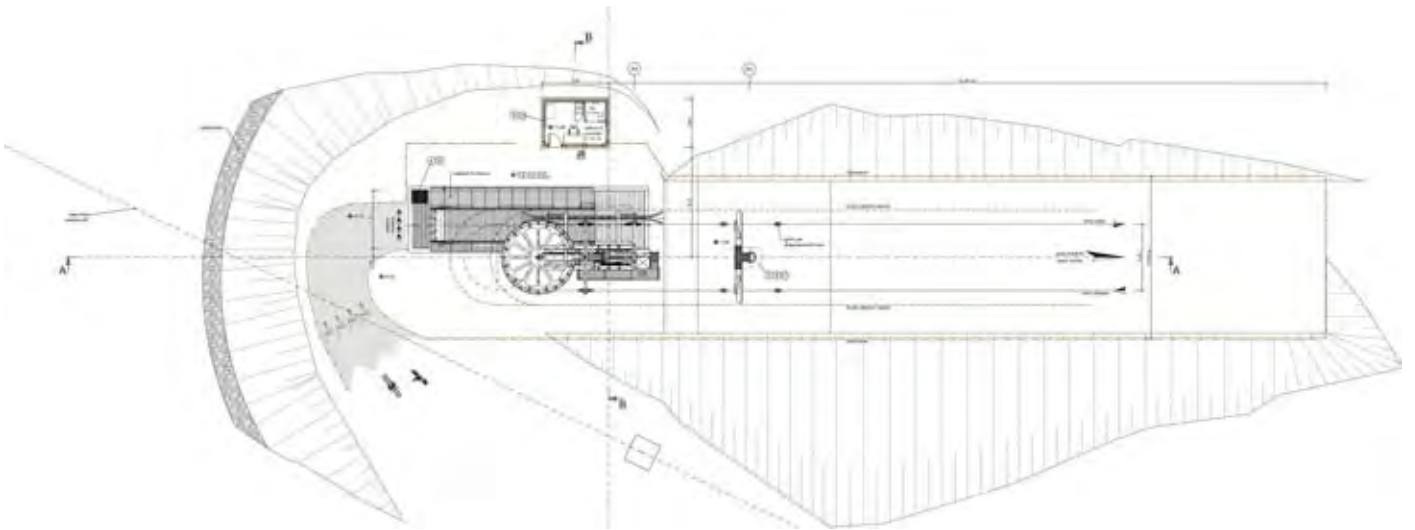











CF4 COSTES DA L'EGA

Corvara (BZ) / IT

	553 m		80 kW
	68 m		87
	2200 p/h		8

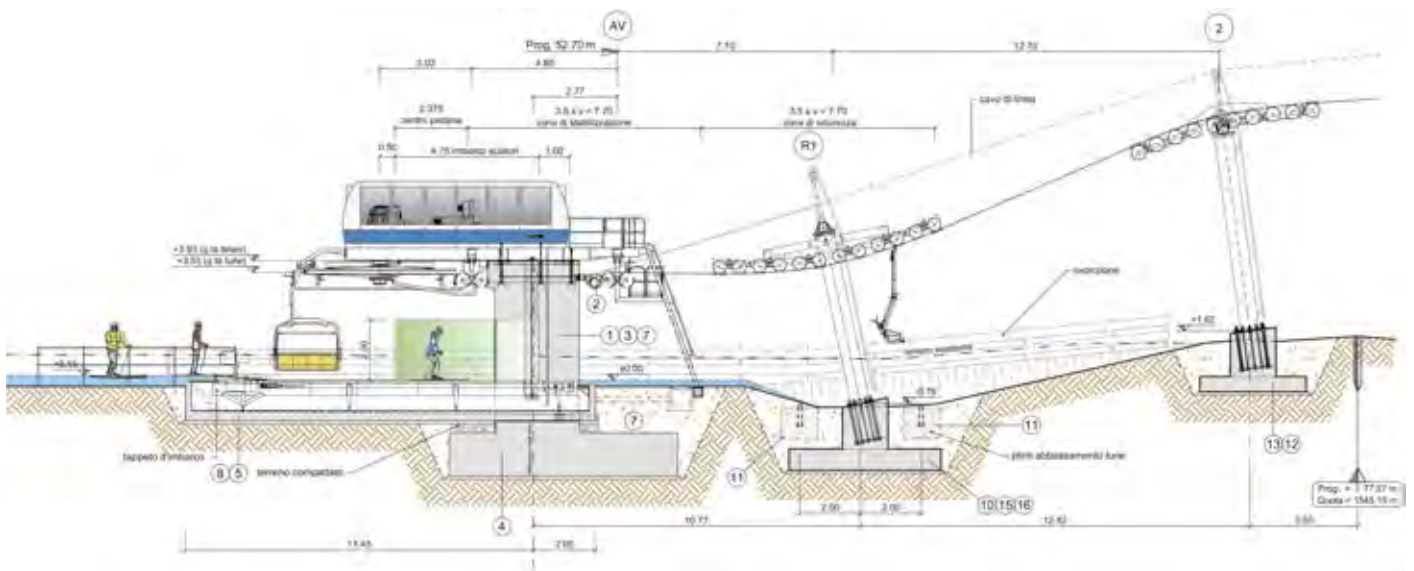











CF4 PUNGART

Slovenj Gradec / SI

	1004 m		250 kW
	195 m		100
	1824 p/h		11

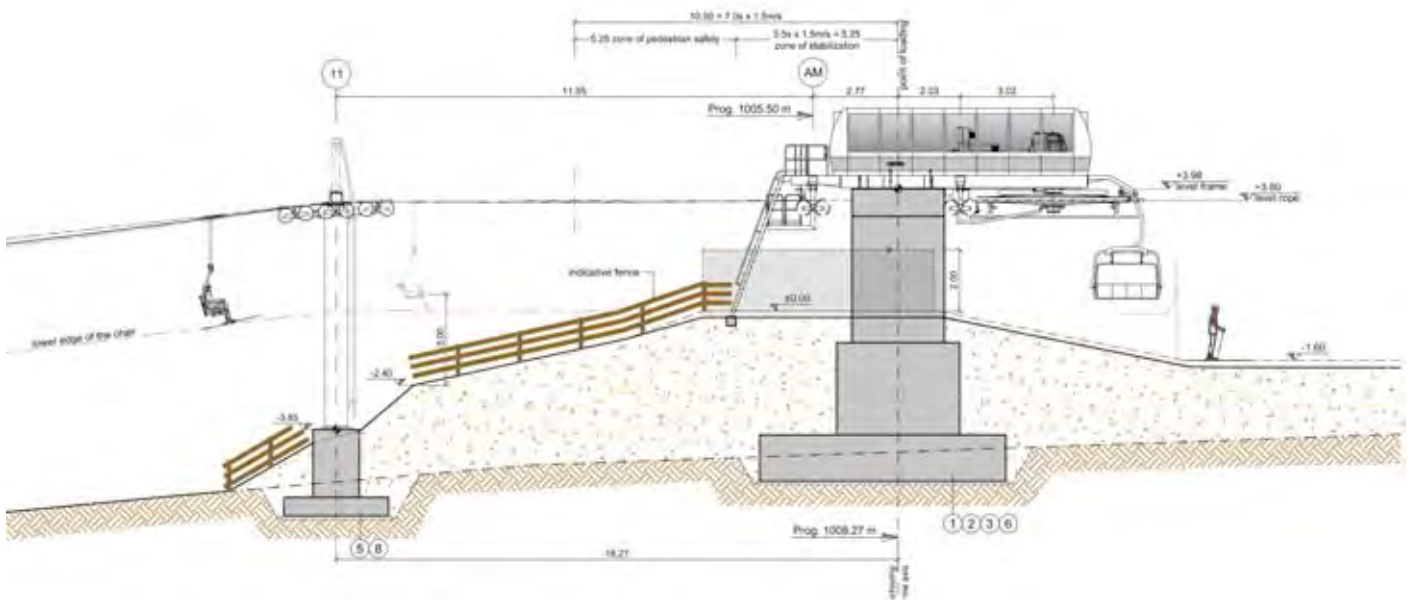



CF2 WM-SHUTTLE

Schladming / AT

↗ 511 m	⊖ 65 kW
↕ 222 m	☎ 67
👤 933 p/h	⌚ 5

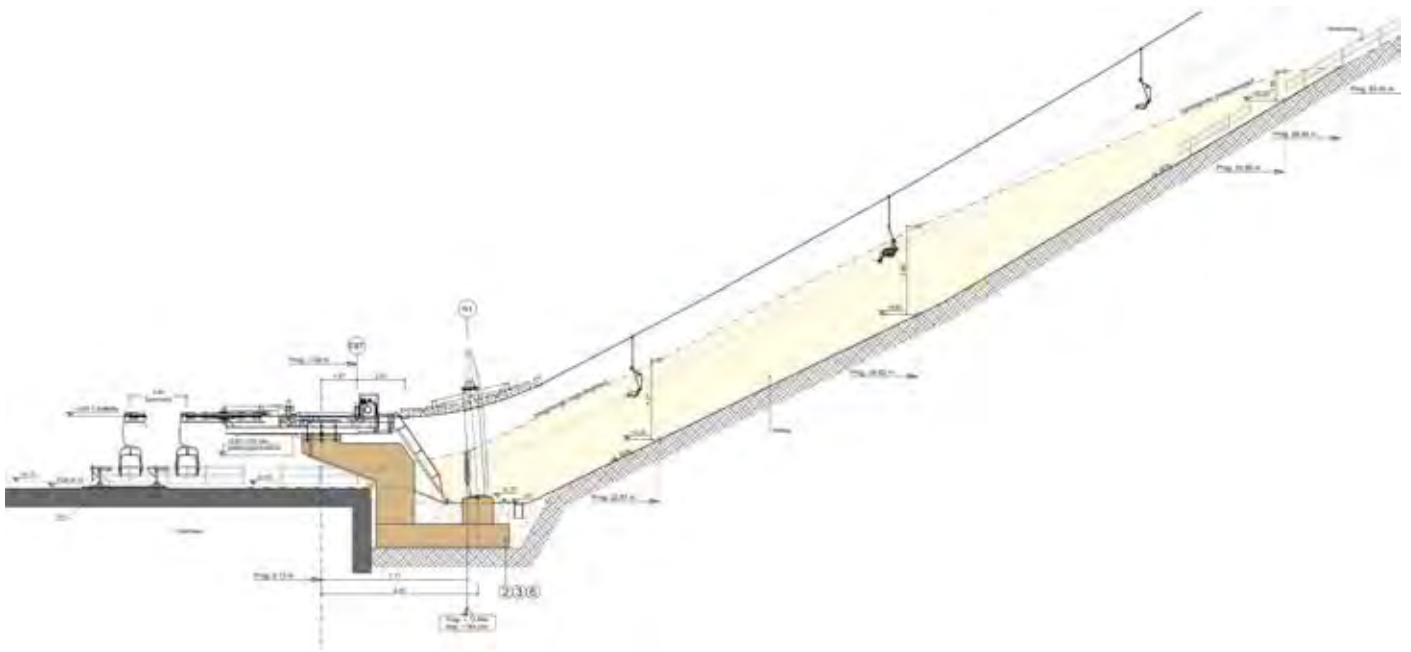







CF2 VIKERSUNDBAKKEN

Vikersund / NO

↗	521 m	⊕	29 kW
↕	179 m	☎	42
👤👤👤	405 p/h	⌚	9

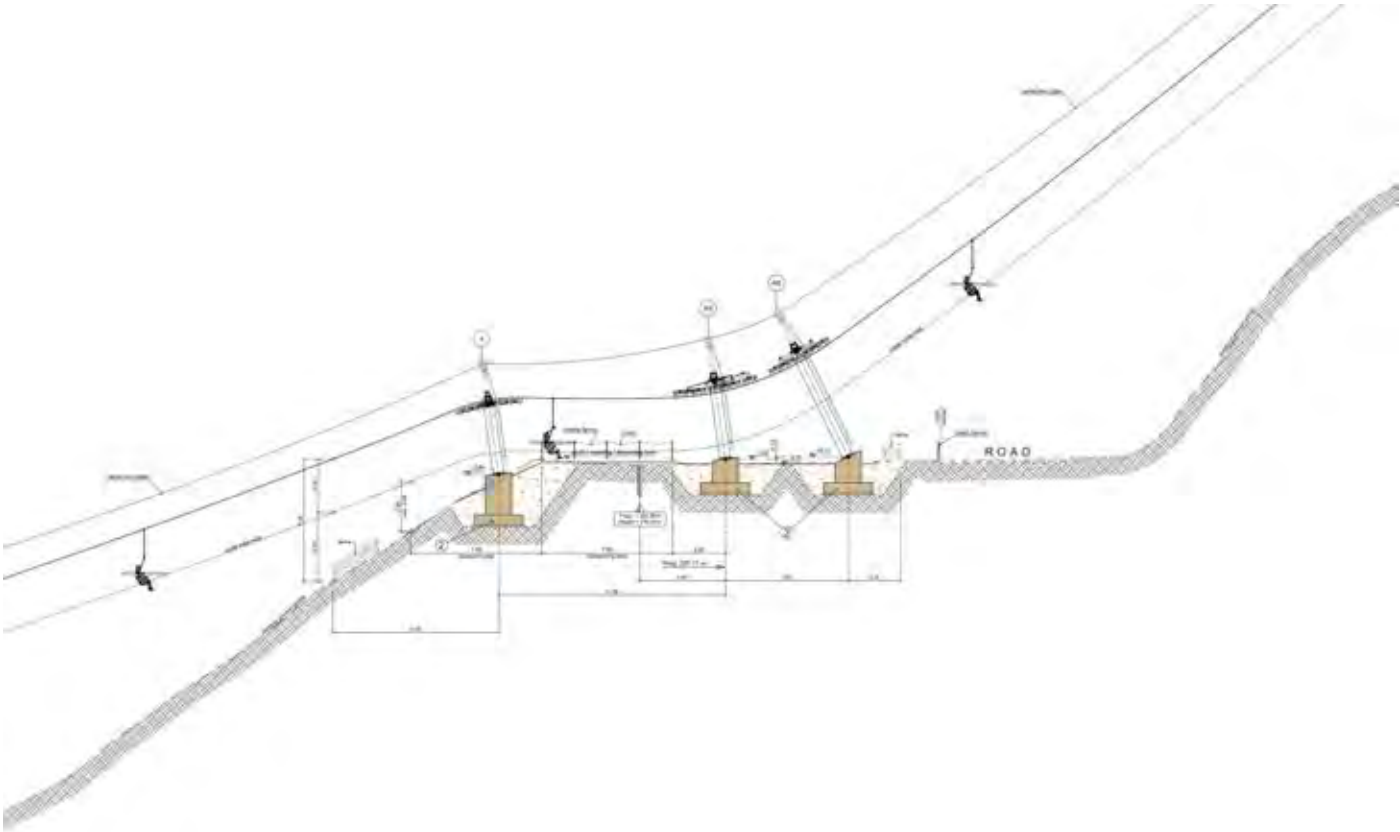

















SL1 SANTA FOSCA

Selva di Cadore (BL) / IT

	300 m		22 kW
	39 m		49
	720 p/h		4

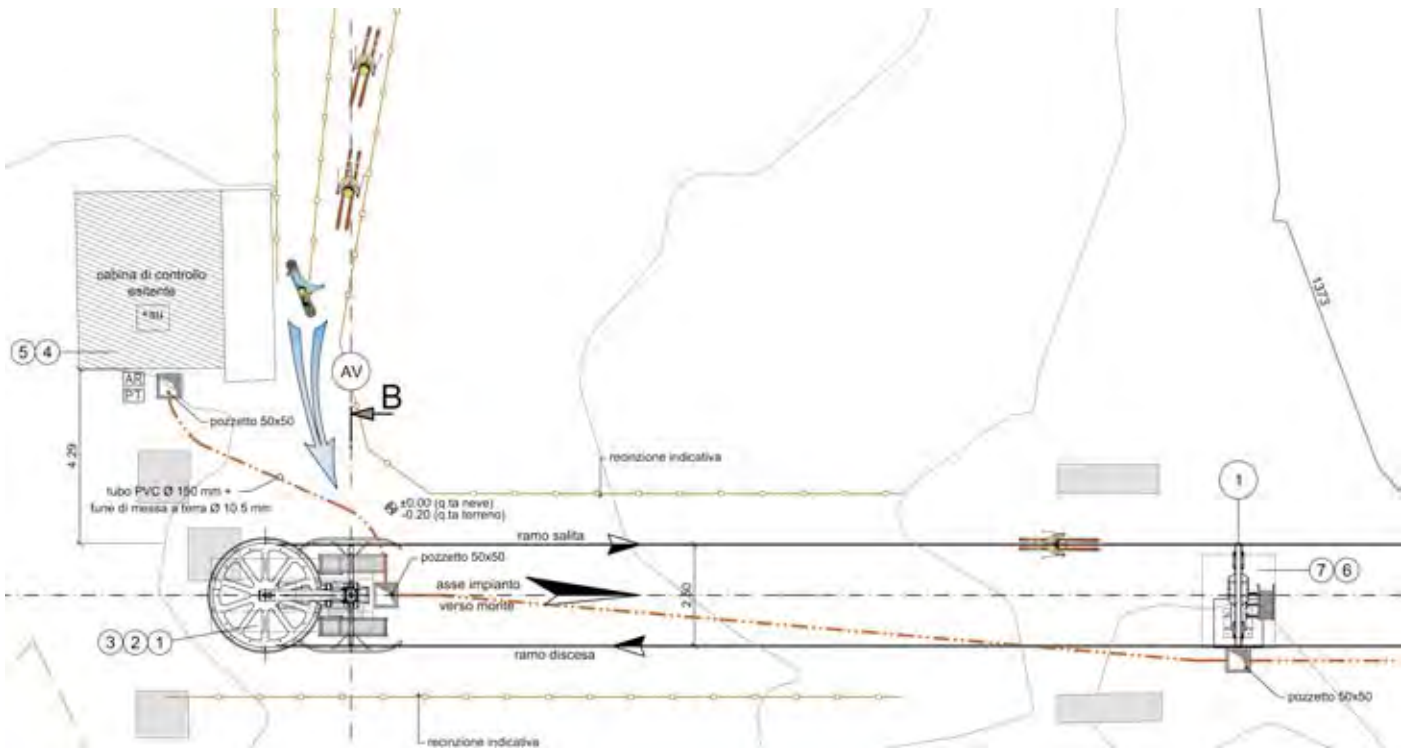









Successi 2011



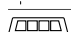



MM50 SQUAIRE METRO

Frankfurt / DE

	300 m
	2 m
	3400 p/h
	165 kW
	2
	8







GD8 SCHILLING

Vals / Valles (BZ) / IT

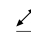
	2046 m
	439 m
	2200 p/h
	590 kW
	63
	16

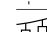

GD8 STAFAL - GABIET

Gressoney la Trinité (AO) / IT

	2566 m
	487 m
	2400 p/h
	590 kW
	80
	17

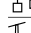

GD10 RIED

Kronplatz / Plan de Coronas (BZ) / IT

	4340 m
	801 m
	3200 p/h
	1340 kW
	144
	24





GD8 PUZA DAI FÒ - PLAZA

Pinzolo (TN) / IT

	1224 m
	513 m
	1800 p/h
	245 kW
	33
	9



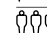
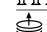

GD8 TALBAHN

Spittal an der Drau / AT

	3028 m
	1233 m
	2400 p/h
	1077 kW
	94
	17



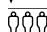

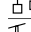
GD8 COL DEI BALDI

Alleghe (BL) / IT

	1986 m
	469 m
	2800 p/h
	670 kW
	75
	15



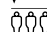

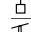
GD8 PLAZA - COLARIN

Pinzolo (TN) / IT

	2354 m
	356 m
	1800 p/h
	310 kW
	57
	16

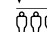

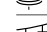

GD8 ORDU-BOZTEPE

Ordu / TR

	2372 m
	501 m
	900 p/h
	341 kW
	28
	7

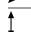

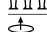

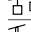
GD8 GAISJOCH

Meransen / Maranza (BZ) / IT

	1963 m
	178 m
	800 p/h
	325 kW
	21
	9

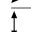

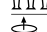

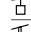
GD8 COLARIN - PATASCROSS

Pinzolo (TN) / IT

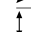

	1156 m
	246 m
	1800 p/h
	185 kW
	32
	10

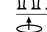
CD8C BUKOVA HORÁ - LOMNICA

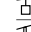

Tatranska Lomnica / SK

	683 m
	132 m
	2400 p/h
	250 kW
	27
	7

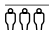
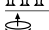
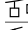

CD6 BAMBY
 La Villa (BZ) / IT

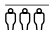
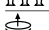
	774 m
	290 m
	2800 p/h
	380 kW
	46
	8



CD6C KATZENMOOS
 Finkenberg / AT

	1488 m
	580 m
	2800 p/h
	666 kW
	83
	12

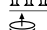
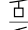

CD6 COVETAN
 Les Saisies / FR

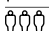
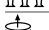
	1496 m
	357 m
	2600 p/h
	630 kW
	71
	14

CD6 FONTE FREDDA - MT. FREDDO
 Ovindoli (AQ) / IT

	1678 m
	505 m
	3000 p/h
	620 kW
	99
	17



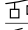

CD6C RESTERHÖHE
 Kitzbühel / AT

	1528 m
	507 m
	2400 p/h
	536 kW
	73
	12



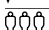
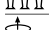

CD6 LES JEUX
 Valmeinier / FR

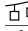
	1829 m
	620 m
	3200 p/h
	880 kW
	98
	15



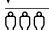
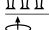

CD6 SASSO LEVANTE
 Wolkenstein / Selva Gardena (BZ) / IT

	1128 m
	201 m
	2600 p/h
	347 kW
	60
	12



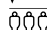
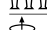

CD6C ALP DADO
 Laax / CH

	1576 m
	369 m
	3200 p/h
	560 kW
	86
	13



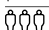
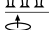

CD6C PASIEKA EXPRESS
 Bialka Tatrzańska / PL

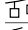
	1064 m
	175 m
	3010 p/h
	300 kW
	66
	10



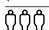
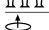

CD6 BÄRNBISSBAHN
 Spittal an der Drau / AT

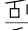
	1366 m
	421 m
	3000 p/h
	458 kW
	82
	11



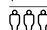
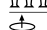

CD6 BÜRE BREMBERG X-PRESS
 Winterberg / DE

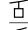
	761 m
	127 m
	3000 p/h
	200 kW
	48
	7



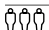
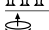

CD6 OST 6:AN
 Idre / SE

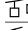
	1101 m
	207 m
	3200 p/h
	314 kW
	72
	11



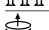

CD6 SKALET EXPRESS
Vemdalen / SE

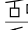
	592 m
	99 m
	2400 p/h
	167 kW
	35
	8

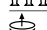

CF4 COSTES DA L'EGA
Corvara (BZ) / IT

	553 m
	68 m
	2200 p/h
	80 kW
	87
	8

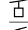
CF2 WM-SHUTTLE
Schladming / AT

	511 m
	222 m
	933 p/h
	65 kW
	67
	5

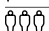

CD4C DORUKKAYA
Dorukkaya-Bolu / TR

	1160 m
	339 m
	1211 p/h
	250 kW
	42
	9

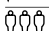



CF4 VOINEASA
Voineasa / RO

	1169 m
	184 m
	1400 p/h
	92 kW
	100
	11



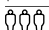
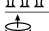

CF2 VIKERSUNDBAKKEN
Vikersund / NO

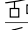
	521 m
	179 m
	405 p/h
	29 kW
	42
	9



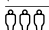
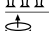

CF4 CHERZ 1
Livinallongo (BL) / IT

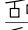
	965 m
	243 m
	2400 p/h
	199 kW
	131
	11



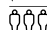
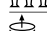

CF4 PUNGART
Slovenj Gradec / SI

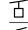
	1004 m
	195 m
	1824 p/h
	250 kW
	100
	11



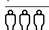
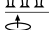

CF2 RASNOV
Rasnov / RO

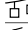
	324 m
	96 m
	311 p/h
	15 kW
	20
	5+5



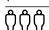
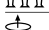

CF4 CIAMPORINO
Varzo (VB) / IT

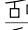
	1227 m
	236 m
	2387 p/h
	220 kW
	165
	12

CF2 BUCO DELLA NEVE
Verenetta (VI) / IT

	880 m
	204 m
	1182 p/h
	94 kW
	106
	9

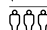
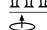

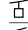
SL1 LASTE II
Asiago (VI) / IT

	369 m
	62 m
	720 p/h
	22 kW
	50
	5

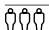
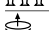
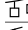

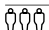
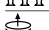
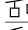

SL1 MONTE CONCA
Linguaglossa (CT) / IT

	1341 m
	278 m
	800 p/h
	90 kW
	172
	16

SL1 CHILDRENLIFT SYSENDALEN
Eidfjord / NO

	247 m
	56 m
	807 p/h
	18 kW
	47
	3

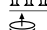
SL1 VOINEASA MOUNTAIN
Voineasa / RO

	688 m
	125 m
	700 p/h
	45 kW
	97
	7

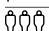
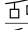

SL1 PIANI DI PEZZÈ
Alleghe (BL) / IT

	300 m
	45 m
	900 p/h
	22 kW
	47
	3



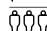
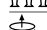

SL1 TRYSIL
Trysil / NO

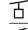
	642 m
	66 m
	757 p/h
	45 kW
	106
	6



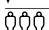
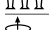

SL1 KATRINA
Klövsjö / SE

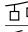
	341 m
	72 m
	780 p/h
	22 kW
	56
	4



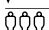
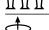

SL1 SANTA FOSCA
Selva di Cadore (BL) / IT

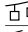

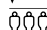
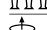

	300 m
	39 m
	720 p/h
	22 kW
	49
	4

SL2 JINA
Jina / RO

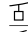
	390 m
	61 m
	893 p/h
	45 kW
	34
	4

SL1 OSTKNAPPEN
Idre / SE

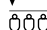
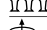
	670 m
	106 m
	800 p/h
	45 kW
	105
	7

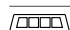
	lunghezza inclinata
	dislivello
	capacità di trasporto
	potenza
	numero totale dei veicoli
	numero sostegni in linea
	numero totale dei veicoli

LEITNER ropeways



Vipiteno (IT)



Vipiteno (IT)



Telfs (AT)



Montmélian (FR)



Grand Junction (USA)



Starà L'ubovňa (SK)



