



REPORT
2022

LEITNER®



Trending All Year Round

LEITNER®

We look back once again on an eventful year full of challenges and political and economic unrest. Despite that, by focusing closely on technological innovation around sustainability, our company performed exceptionally well at the cutting edge.

Our customers have increasingly been asking for ecofriendly, economical products, which has shifted the spotlight firmly onto our successful in-house developments. As well as the LEITNER DirectDrive, which is already well established as the industry leading drive system in new ropeways, our new LEITNER EcoDrive was successfully launched and promises energy savings of up to 20%.

More and more alpine ropeways are being used in the summer season, which means utilizing existing infrastructure efficiently. LEITNER bicycle holders are an example of our innovative, convenient systems which accommodate this leisure trend perfectly.

And in urban mobility, we've been delighted with progress on our patented ConnX® System. This unique hybrid solution combines ropeways with autonomous driverless transport, thereby promoting the use of electric mobility in public transport. ConnX® is expected to reach market maturity in the next two years. It continues LEITNER's innovative, sustainable tradition.



Vipiteno / IT



Alpbach / AT

RETROSPECTIVE

ITALY

Ropeway operators at Monte Cavallo, Vipiteno's local mountain, commissioned the new GD10 "Rosskopf" complete with new station buildings, which meant a visible upgrade and modernization for the whole region. The new ropeway runs on the route of its 35-year-old predecessor that passes over the Brennero freeway. At the Alpe di Siusi, Speikboden, and Cervino ski resorts, LEITNER replaced existing systems with ultra-modern, ultra-comfortable chairlifts with weather protection bubbles.

The Via Lattea ski resort on the border between Piedmont in Italy and Provence-Alpes-Côte d'Azur in France has been given a significant comfort upgrade. The new CD6 "Cit Roc" is routed parallel to the Sestriere World Cup run and carries up to 2600 passengers per hour on

a journey that takes just 4 minutes 30 seconds. Doubling has been the order of the day at the San Martino di Castrozza ski area, where LEITNER built the new CF4 "Cima Tognola" 4-seater chairlift. It's bottom station was slightly moved up compared to the previous 2-seater chairlift in order to enable a quick connection to the 6-seater chairlift Cigolera. LEITNER also built two surface lifts at the Passo Oclini and 3 Zinnen Dolomites resorts.

AUSTRIA

In Austria, LEITNER opened the 2022/23 winter season with no fewer than eight new ropeways. Common to them all was the maintenance-friendly, resource-friendly LEITNER DirectDrive. In the Zillertal tourist region, the new CD8C "Kapaunsbahn" replaced an existing ropeway, while the new "Hornbahn 2000" 6-seater chairlift was completed at Ski Juwel Alpbachtal Wildschönau.

Axamer Lizum was also the starting point for comprehensive modernization. The new GD10 "Hoadlbahn" was built over two sections at the former Olympic venue.

LEITNER also built the highest ropeway system in East Tyrol in the Deferegggen Valley: the CD6C "Leppleskofel".

In the Schladming-Dachstein region, LEITNER

constructed the new GD10 "Galsterberg" gondola lift, replacing a 30-year-old fixed-grip gondola system. Spacious Diamond EVO cabins in the XL Deep version feature separate upholstered seats and lots of legroom, making things really comfy for passengers.

In the Murtal and Pyhrn-Priel holiday regions, two new 10-passenger gondola lifts heralded the arrival of the latest ropeway technology.

Timed to coincide with 50th anniversary celebrations, the Telemix ropeway on Rittisberg in Styria has boosted performance significantly. With its 3-in-1 technology, the TMX6-10 "Rittisbergbahn" can be operated as a gondola lift, a chairlift, or a combination of both.



Klæbu / NO



Vars / FR

SWEDEN, NORWAY, FINLAND

Twelve new ropeways built by LEITNER in the far north have brought new quality standards across the board.

Situated in the heart of Sweden, the Idre Fjäll holiday resort has received a significant upgrade with a new 10-passenger gondola lift. The GD10 "Sydgondolen" travels around 2200 m in two sections to reach the top of Idre Fjäll.

Near Stockholm, LEITNER built the CD6 "Snöberget Direkt", which is its sixth ropeway at the Romme Alpin resort.

A comfortable ropeway for year-round use was also erected at the well-known Swedish World Cup venue of Åre. The CD6 "Stjärnliften" has holders for four bikes on each chair, making it easy to take bicycles out on summer excursions. In the Norwegian ski resort of Voss,

the new CD6 "Trastølheis" has replaced a fixed-grip ropeway which was built back in 1968. LEITNER's CD6 "MIDT-Expressen" is already its seventh ropeway in the snow-sure family ski resort of Vassfjellet – Klæbu. LEITNER built the CD6 "Bitihorn Expressen" along the summer bobsleigh track in the Norwegian town of Beitostølen. Aside from undertaking big projects in 2022, LEITNER built four surface lifts in Sweden, as well as one in Norway and one in Finland.

FRANCE

By building three new ropeways in France, LEITNER has demonstrated once again how best to combine technological innovation with customized flexibility. The CD6 "Vars Speed Master" and CD6 "La Mayt" have brought a much-needed upgrade to ropeway infrastructure at the La Forêt Blanche ski resort. The two chairlifts each replaced a predecessor model with 4 seats and thus not only bring a speed boost but also a pleasing increase in capacity. The new CD6 "Les Nants" at the Saint Gervais, which replaces a fixed grip 2-seater chairlift built in 1977, has also brought considerably more comfort while reducing journey times.

SUCCESSFUL MODERNIZATION

More and more operators are opting to modernize existing ropeways and make them more attractive. As well as thinking about comfort, safety, and greater capacity, they have been sharpening their focus on sustainability and budgets. These kinds of projects were high on the agenda again last year. Some systems were equipped with energy-saving products like the LEITNER DirectDrive, some were given the latest generation of cabins, some received a general overhaul. All in all, many ropeways were given a new lease of life in 2022 and now feature LEITNER's latest developments within their new structures.



Ecatepec / MX

© Vitro



Zermatt / CH

OUTLOOK

The new year promises a number of breath-taking projects, all of which demonstrate that the demand for technological innovation aimed at more sustainability is not a trend. It's here to stay. Demand for urban ropeways as a meaningful addition to existing public transport networks has been especially strong.

MEXICO

Mexico's capital is considered a world pioneer in how to integrate ropeways into urban transport networks. With the completion and opening of "Mexicable 2 – Linea Verde", its latest ropeway line forms a self-contained, high-performance system that offers transport which is both efficient and sustainable.

COLUMBIA

Urban ropeways also have a long tradition in Colombia. In Manizales, a municipality with more than 400,000 inhabitants in the department of Caldas, two LEITNER ropeway systems have already been successfully integrated into the public transport system. A third ropeway will be added in 2023.

MONTENEGRO

In Montenegro, one of the world's most spectacular ropeways will open in summer 2023, carrying its passengers from sea to mountain in just eleven minutes. Spanning a distance of 3.9 kilometers and 1316 vertical meters, a LEITNER system will soon connect the UNESCO World Heritage Site of Kotor with Lovćen National Park. The construction will almost completely eliminate the use of the old and winding Njeguš road, meaning a huge reduction in private motorized transport and a noticeable drop in carbon emissions.

SWITZERLAND

The mountains have also been host to a number of exciting projects involving LEITNER's successful, resource-friendly, energy-saving in-house developments such as the LEITNER DirectDrive. One of these projects is Matterhorn Glacier Ride II. It's a continuation of LEITNER's successful work on the Klein Matterhorn in Zermatt, following the construction of Matterhorn Glacier Ride I. The new 3S system will create the highest continuous crossing of the Alps by ropeway, beginning July 2023.



Kitzbühel / AT

GERMANY

Another major project is being built in the north-east of Bavaria. Aging chairlifts are being replaced by modern gondola lifts at the Ochsenkopf resort. Construction work on the GD10 "Ochsenkopf Nord" will start in 2023, followed by the modernization of the South lift one year later. Equipped with spacious Diamond cabins, this ropeway will soon bring passengers quickly and comfortably up to Ochsenkopf in summer and winter, thereby doubling transport capacity at the Fichtelgebirg's biggest ski resort.

AUSTRIA

LEITNER will be building sustainable chairlifts in Kitzbühel in 2023 in continuation of what is already a successful, long-established partnership. The company will once again be integrating its latest technologies to achieve minimum energy consumption combined with maximum operating efficiency. Kitzbühel's sustainable dual ropeway is completed by photovoltaic panels on the station covering. The new GD10 "Wilde Krimml" will soon be forming a direct link between Gerlos and Zell at Zillertal in Tyrol. This will replace the old 4-seater KrimmlXpress chairlift, including its middle station, and will lead directly from Krimmlalm up to the col.



Bressanone / IT

ITALY

The resort of Plose in Valle Isarco in South Tyrol will soon see the arrival of two new 10-passenger gondola lifts, offering modern, upgraded performance and year-round operation. GD10 "Plose 1+2" will replace a 6-passenger gondola lift built in 1986 and, thanks to LEITNER bicycle holders and racks for the popular mountain carts, will bolster and extend what this holiday region already has to offer in summer. In the Rendena Valley, the Pinzolo ski resort is looking forward to a modern 10-passenger gondola lift from LEITNER. The GD10 "Doss del Sabion" will soon be taking its guests to the top station in just under five minutes, where they will enjoy breath-taking views out over Brenta and Adamello.

Like the two ropeways mentioned above, the new CD6C "Valena" at the Pontedilegno-Tonale resort will be driven by an energy-efficient, resource-friendly LEITNER DirectDrive. Equipped with weather protection bubbles and seat heating, the new ropeway will be able to carry 3000 passengers per hour and will offer significantly more comfort than its 2002 predecessor.

Examples of
365 working days ...





GD10 BOULEVARD

Riyadh / SA

Inclined length	1128 m	Power	441 kW
Vertical rise	5 m	Total number of vehicles	40
Transport capacity	2808 p/h	Total number of towers	8

Since 2019, the Boulevard has been one of Riyadh's most spectacular leisure attractions. The metropolis of eight million people, the capital and financial center of Saudi Arabia, is focusing intensively on economic and tourist revitalization with the mega-project and the Riyadh Season festival and has recently expanded the area with the Boulevard World. Entirely based on the model of Las Vegas, the Boulevard World is to become the new entertainment hotspot of the desert city. A 10-passenger gondola lift from LEITNER is

being used for comfortable and rapid transport between this new area and Boulevard Riyadh City. The ropeway starts at the parking lot to the north of Boulevard Riyadh City, flies over a wide road and then leads into Boulevard World, where the ropeway station has been embedded in the impressive Greek landscape of Santorini. The gondola lift runs over a distance of 1.2 kilometers and reaches a maximum transport capacity of 2,808 people per hour.

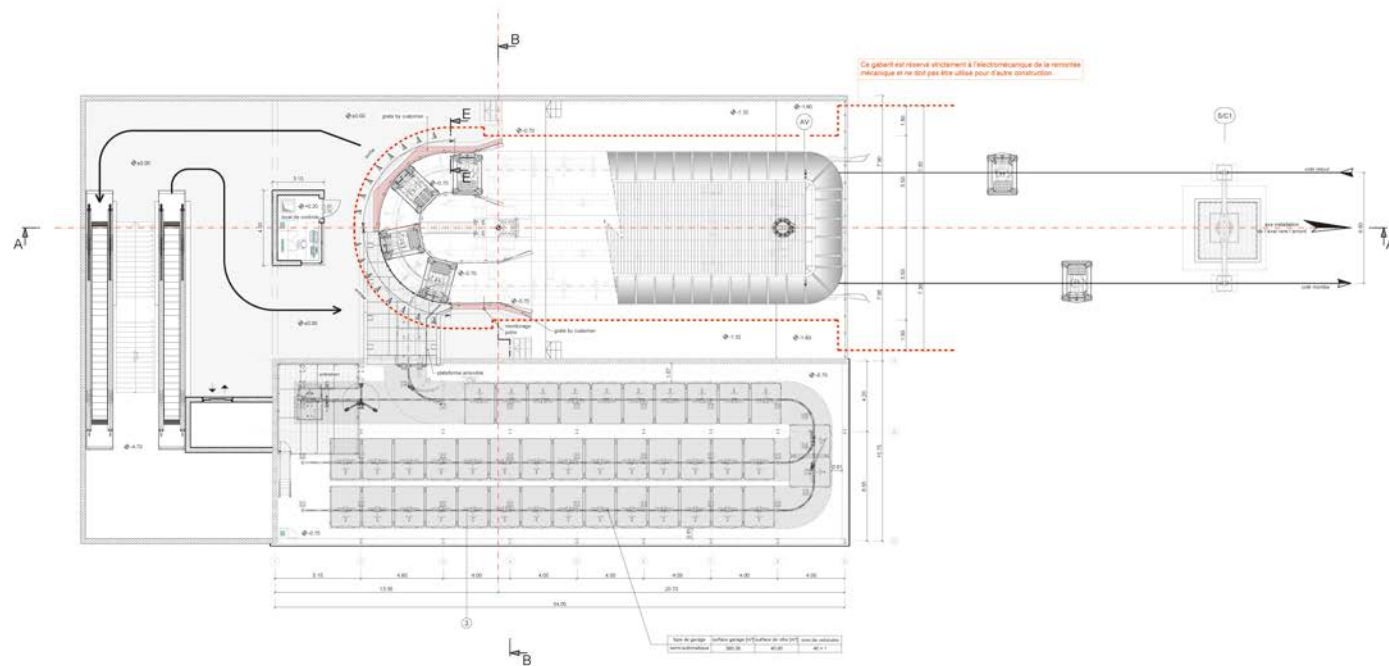
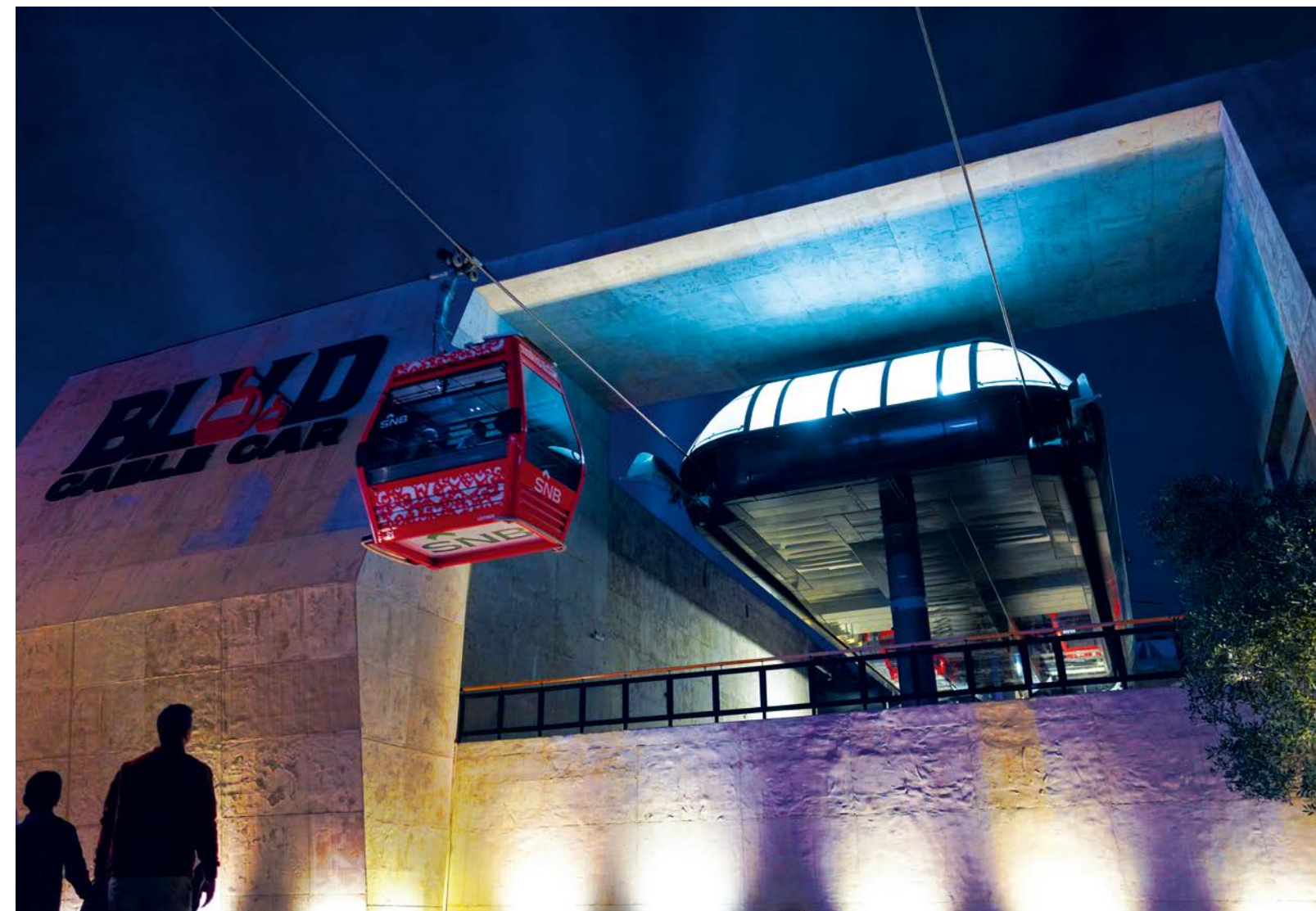



GD10 HOADLBAHN I+II

Axams / AT

Hoadlbahn I

Inclined length	1185 m
Vertical rise	422 m
Transport capacity	2800 p/h
Power	794 kW
Total number of vehicles	40
Total number of towers	10

Hoadlbahn II

Inclined length	950 m
Vertical rise	356 m
Transport capacity	2800 p/h
Power	529 kW
Total number of vehicles	35
Total number of towers	8

In 2022, a comprehensive modernization was carried out in the Axamer Lizum under the sign of sustainability and improved comfort. At the former Olympics venue close to the state capital of Innsbruck, a new gondola lift was built over two sections with an impressive top station, which was placed right next to the existing Hoadlhaus.

The new Hoadlbahn replaces with the CD4 "Schönbodenbahn" and the two fixed 2-seater chairlifts "Hoadl I" and "Hoadl II", three

ropeways at the resort, reducing the number of towers from 44 to 18. LEITNER's DirectDrive has made an important contribution to even more sustainability, less maintenance, and maximum noise reduction. The new system will carry passengers from the parking lot to the highest point in the resort in just six minutes. Seventy-five spacious Diamond EVO cabins offer the ultimate in passenger comfort and an all-round view of the surrounding mountains and the Inn Valley.

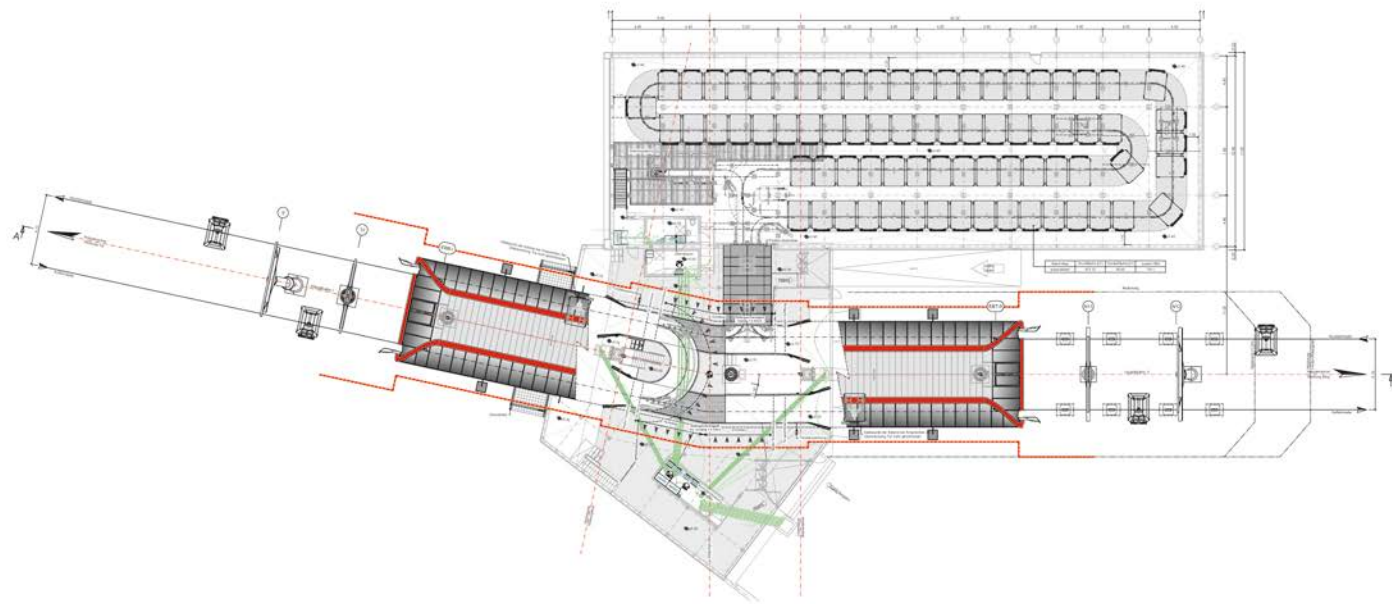



© Axamer Lizum







GD10 HÖSSBAHN

Hinterstoder / AT

Inclined length	2606 m	Power	1298 kW
Vertical rise	812 m	Total number of vehicles	89
Transport capacity	3195 p/h	Total number of towers	19

Situated at the popular World Cup venue in the region of Pyhrn-Priel, Upper Austria's largest ropeway project to date, the new GD10 "Hössbahn", features Diamond EVO cabins with automatic sliding doors, providing more legroom as well as ski racks in the interior. The bottom station, which features high capacity loading, has a longer design, making boarding easier, and is integrated into a multifunctional building that includes cash desks, management offices, public bathroom facilities, and

a first-aid room. The ropeway is accessed via the second floor, which passengers can reach across a bridge or using escalators, stairs, or an elevator. The top station has been equipped with one of the most powerful LEITNER DirectDrives, the LD10, on account of the ropeway's high capacity and the 811 meters it has to ascend. Around 3200 passengers per hour – 800 more than the old ropeway – are now carried up the mountain in two and a half minutes less time.

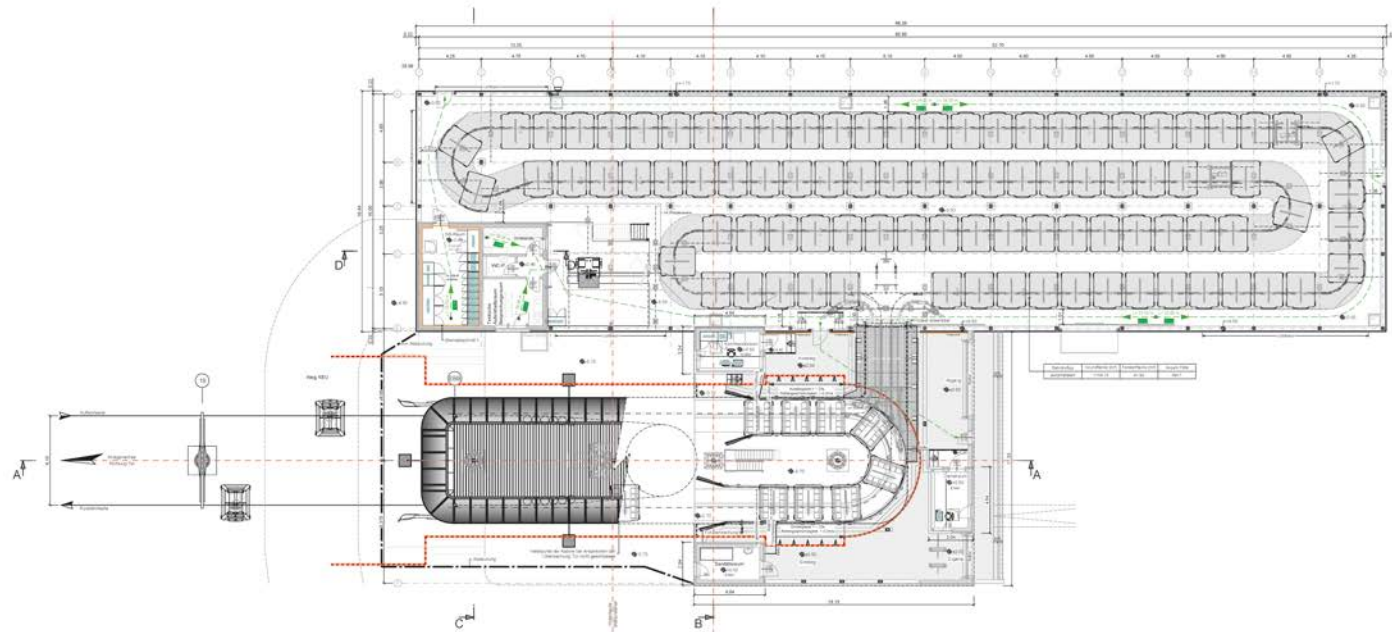



© Michael Schirmbeck

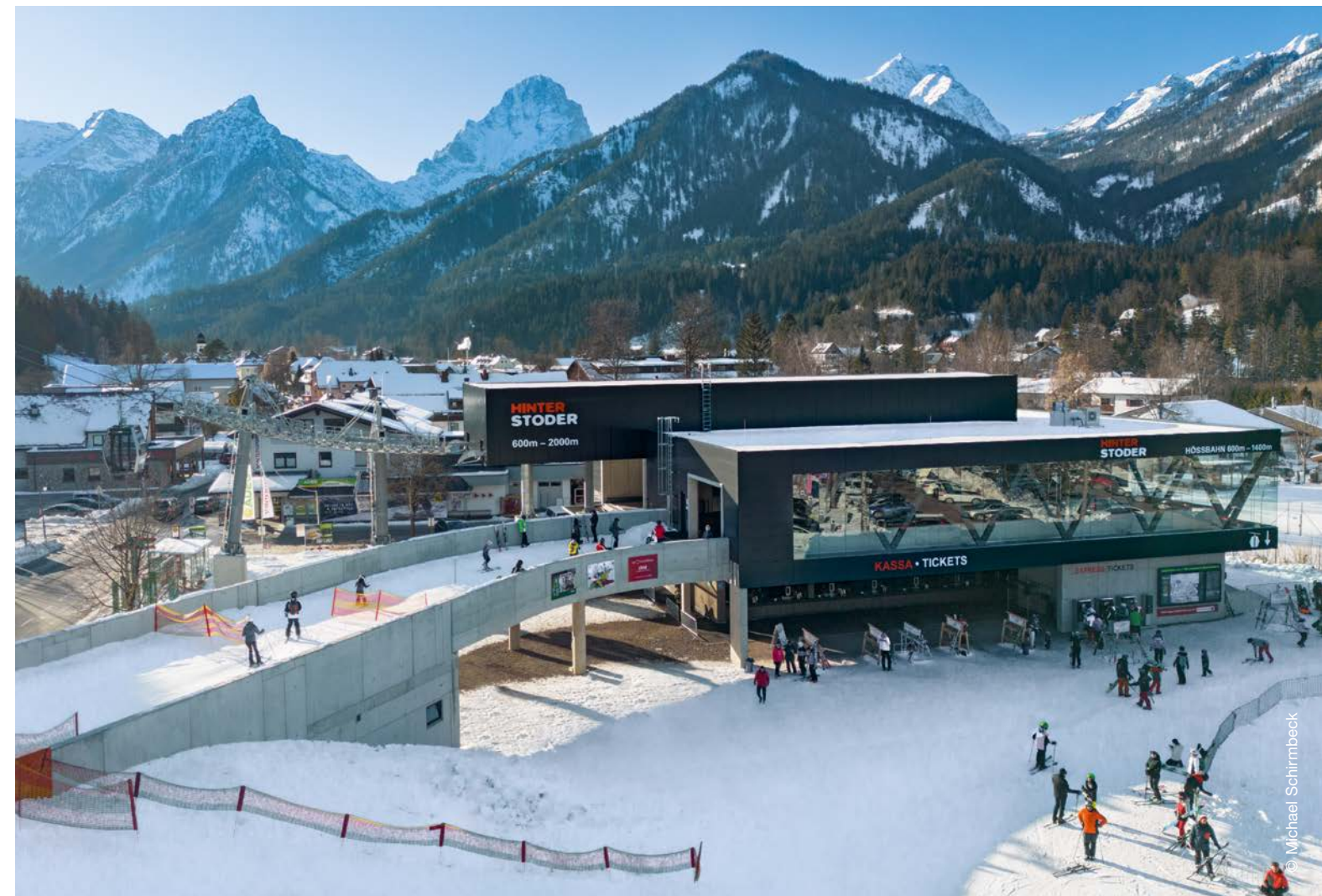

© Michael Schirmbeck

GD10 GALSTERBERGBAHN

Pruggern / AT

Inclined length	2334 m	Power	794 kW
Vertical rise	507 m	Total number of vehicles	45
Transport capacity	1760 p/h	Total number of towers	14

Equipped with a LEITNER DirectDrive, the GD10 “Galsterbergbahn” is set to replace an over thirty year-old fixed-grip gondola lift. This means a significant upgrade for winter sports enthusiasts. Spacious Diamond EVO cabins in the XL Deep version feature separate upholstered seats and lots of legroom, making things really comfy for passengers. Big glass sides all round provide an exceptional panoramic view of the surrounding mountains.

The operators have placed special emphasis on getting the station buildings to blend in with their surroundings. They’re being built in the clapboard look common to traditional structures in the region. Building a new main ropeway has significantly upgraded facilities there, especially the attractive valley descent which is great for kids and which was widened in the upper section last year. It has also helped distribute guests more evenly around the mountain.

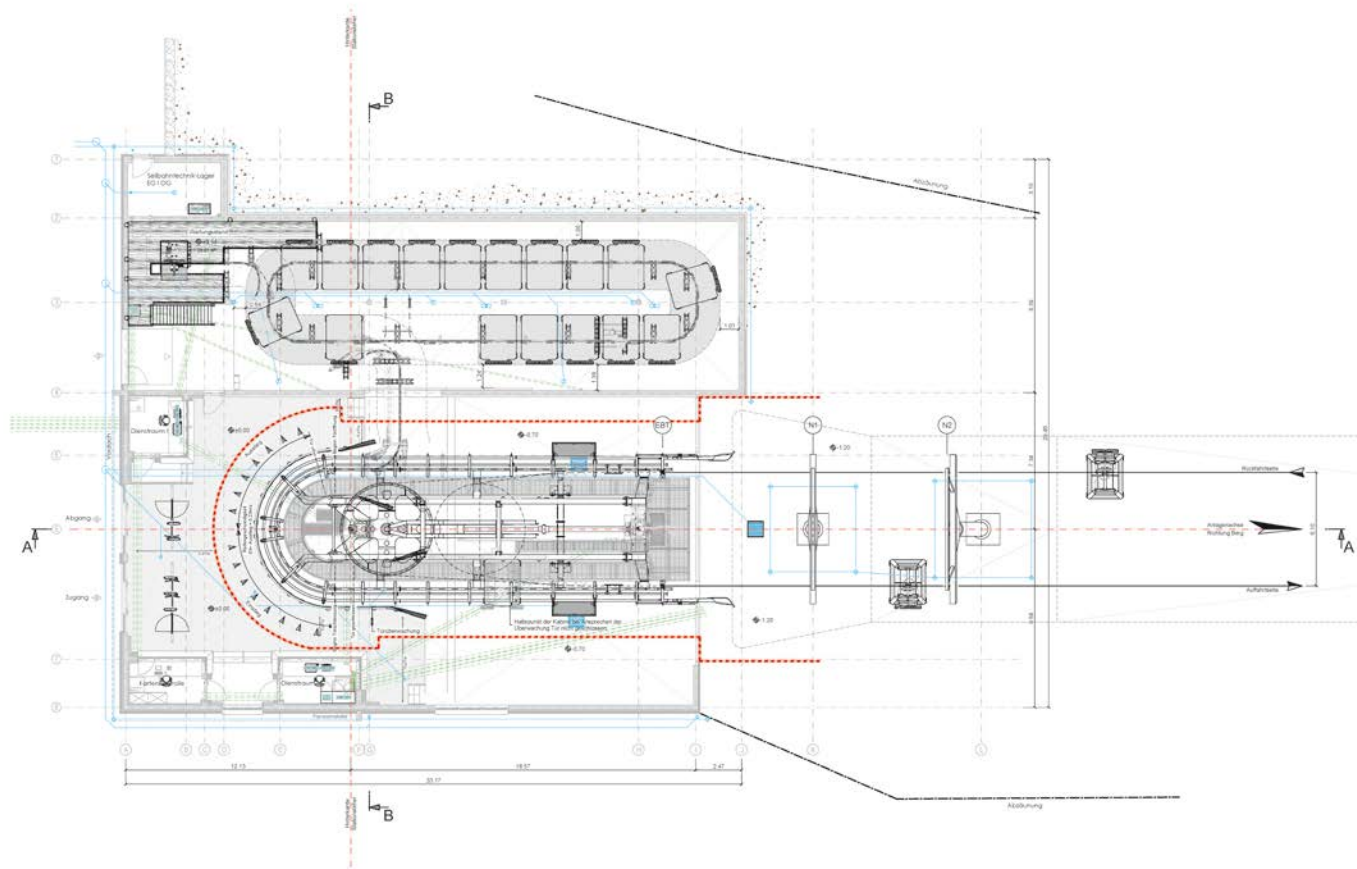





GD10 GREBEN10

St. Lambrecht / AT

Inclined length	2884 m	Power	794 kW
Vertical rise	647 m	Total number of vehicles	65
Transport capacity	2100 p/h	Total number of towers	17

At the ski resort of Grebenzen – St. Lambrecht, the new GD10 “Geben10” replaces one chairlift and two surface lifts, reducing journey times by around 30 minutes. All the skiers who use the training slope in Grebenzen (which is open throughout the winter) for training, competitions, and races will benefit from fast travel times.

The ropeway has a maximum transport capacity of 2100 people per hour and delivers maximum comfort with 65 Diamond cabins. Designed by Pininfarina, these have large glass sides all round, offering an uninterrupted panoramic view, and carry visitors at six meters per second.

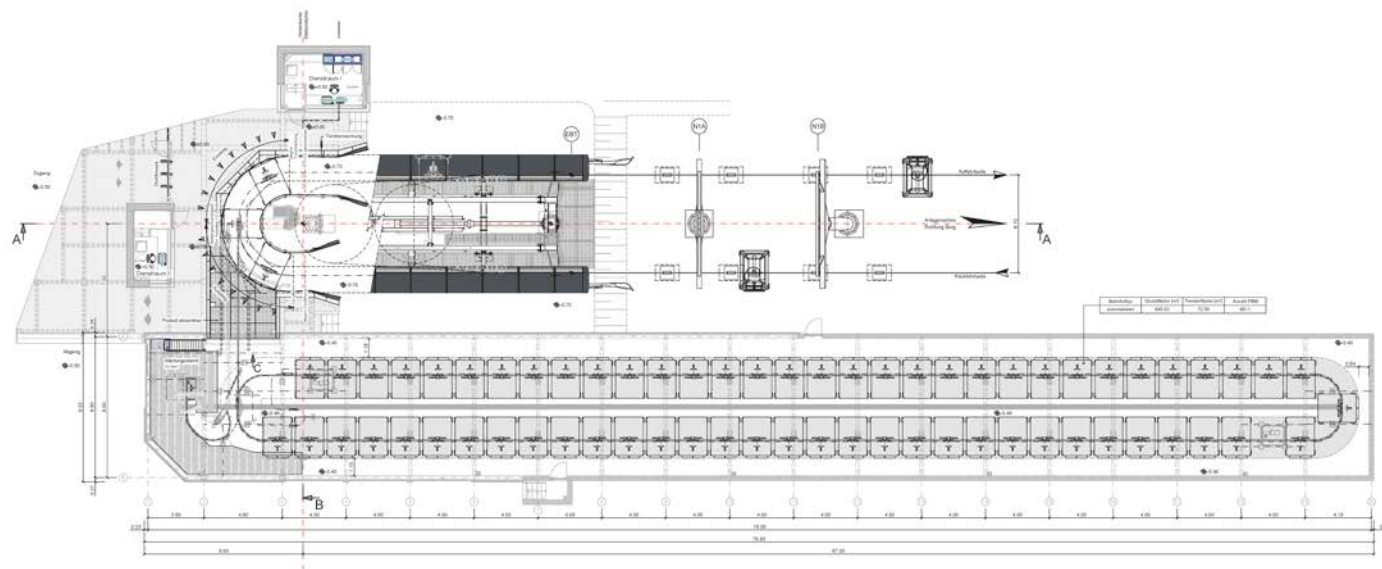



GD10 ROSSKOPF

Sterzing - Vipiteno / IT

Inclined length	2706 m	Power	950 kW
Vertical rise	892 m	Total number of vehicles	65
Transport capacity	2300 p/h	Total number of towers	15

A new ropeway era began at Monte Cavallo in Vipiteno in December 2022. Very near to LEITNER's headquarter, the resort's 6-passenger gondola lift, which was commissioned right back in 1987, has now been replaced by a modern 10-passenger gondola system. The GD10 "Rosskopf" travels along exactly the same route, including the well-known crossing of the Brennero freeway, and has been equipped with the eco-friendly, maintenance-friendly LEITNER DirectDrive and

Diamond EVO Premium cabins. This ropeway is especially quiet and easy on resources due to its DirectDrive system. Its 65 cabins offer exceptionally comfortable seating and a unique, all-round viewing experience. New buildings and architectural touches have been included. New station buildings were completed at the top and bottom of the ropeway when the gondola lift was built. The bottom station building offers space for new offices for the Vipiteno Tourist Board.

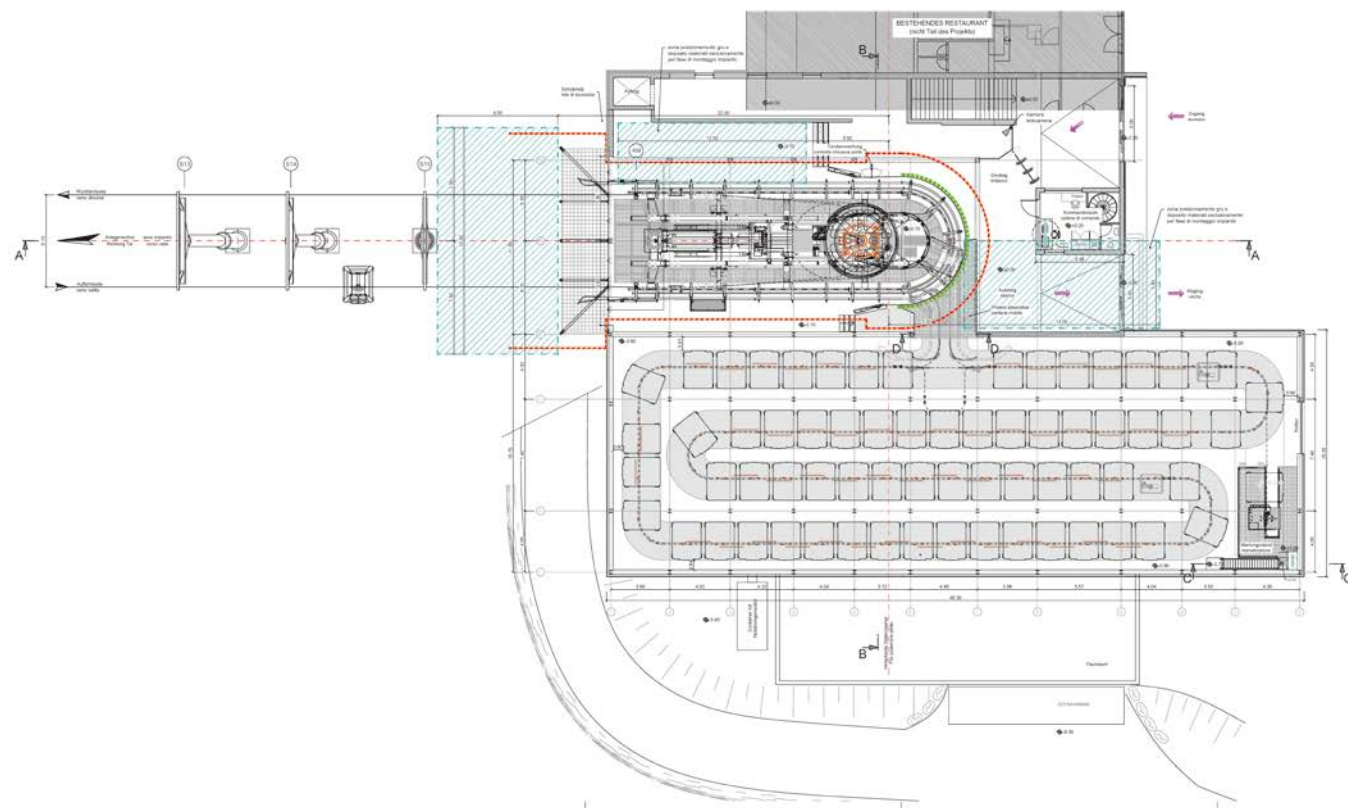





GD10 SYDGONDOLAN I+II

Idre / SE

Sydgondolen I

Inclined length	1519 m
Vertical rise	238 m
Transport capacity	3000 p/h
Power	529 kW
Total number of vehicles	52
Total number of towers	11

Sydgondolen II

Inclined length	629 m
Vertical rise	58 m
Transport capacity	3000 p/h
Power	353 kW
Total number of vehicles	28
Total number of towers	6

LEITNER has upgraded the Idre Fjäll ski resort by completing a new 10-passenger gondola lift called GD10 "Sydgondolen I+II". Sustainability is high on the agenda in Sweden (as it is elsewhere), so the new, two-section ropeway is naturally equipped with a LEITNER DirectDrive. This ropeway's bottom sector can be run autonomously, so that the lower slopes can still be used when winds are high in the

upper areas. There will be a total of 80 cabins providing a capacity of up to 3000 passengers per hour. This ropeway will remain open all year round and will offer bike transport in summer. In the winter season, visitors to this popular leisure destination can look forward to two new descents made accessible by the new gondola lift.

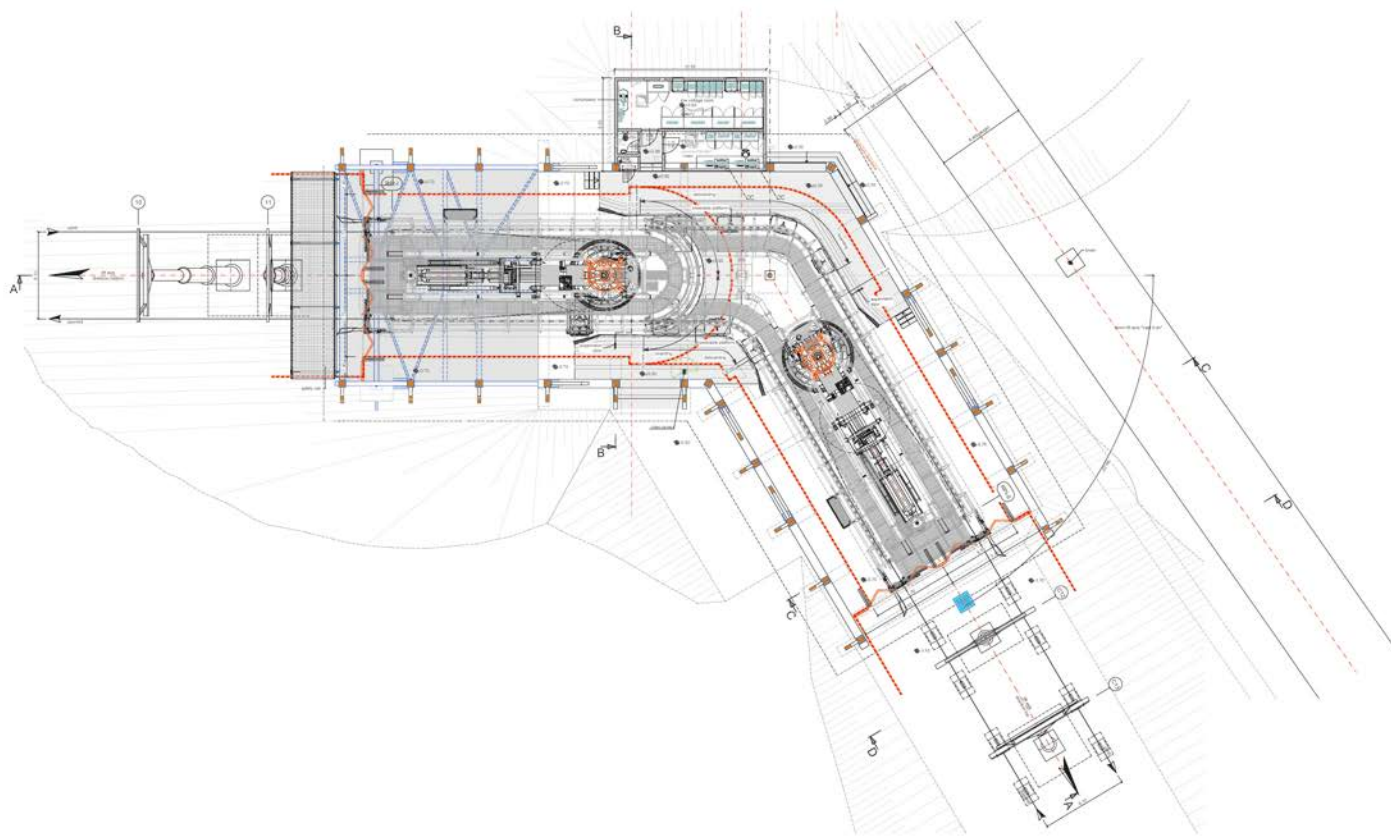





TMX6-10 RITTISBERGBAHN

Ramsau / AT

Inclined length	853 m	Power	441 kW
Vertical rise	316 m	Total number of vehicles	44
Transport capacity	2343 p/h	Total number of towers	10

Timed to coincide with the ski resort's 50th anniversary, the completion of the TMX6-10 "Rittisbergbahn" brought significant modernization to the Schladming-Dachstein region, with much greater flexibility and performance. The journey time to the top station at 1500 meters has been almost halved compared to the previous lift and now takes just over three minutes. Thanks to its 3-in-1 technology, the system can be operated as a gondola lift, a chairlift, or a combination of both.

This makes the Telemix ropeway on Rittisberg the ideal solution, because the mountain is popular with families and used in many

different ways. These include, increasingly, cross-country skiing, winter hiking, and snowshoeing. By combining cabins and chairs, the new ropeway offers the flexibility needed for the ascent. Another of its benefits is that it makes it easier to carry sledges for the illuminated night toboggan run on Rittisberg. Only the cabins are used in summer. This Telemix ropeway positions the resort ideally for the opening of a new mountaincart route scheduled for summer 2023. Special holders have been developed for the carts so that they can be transported outside the cabin.

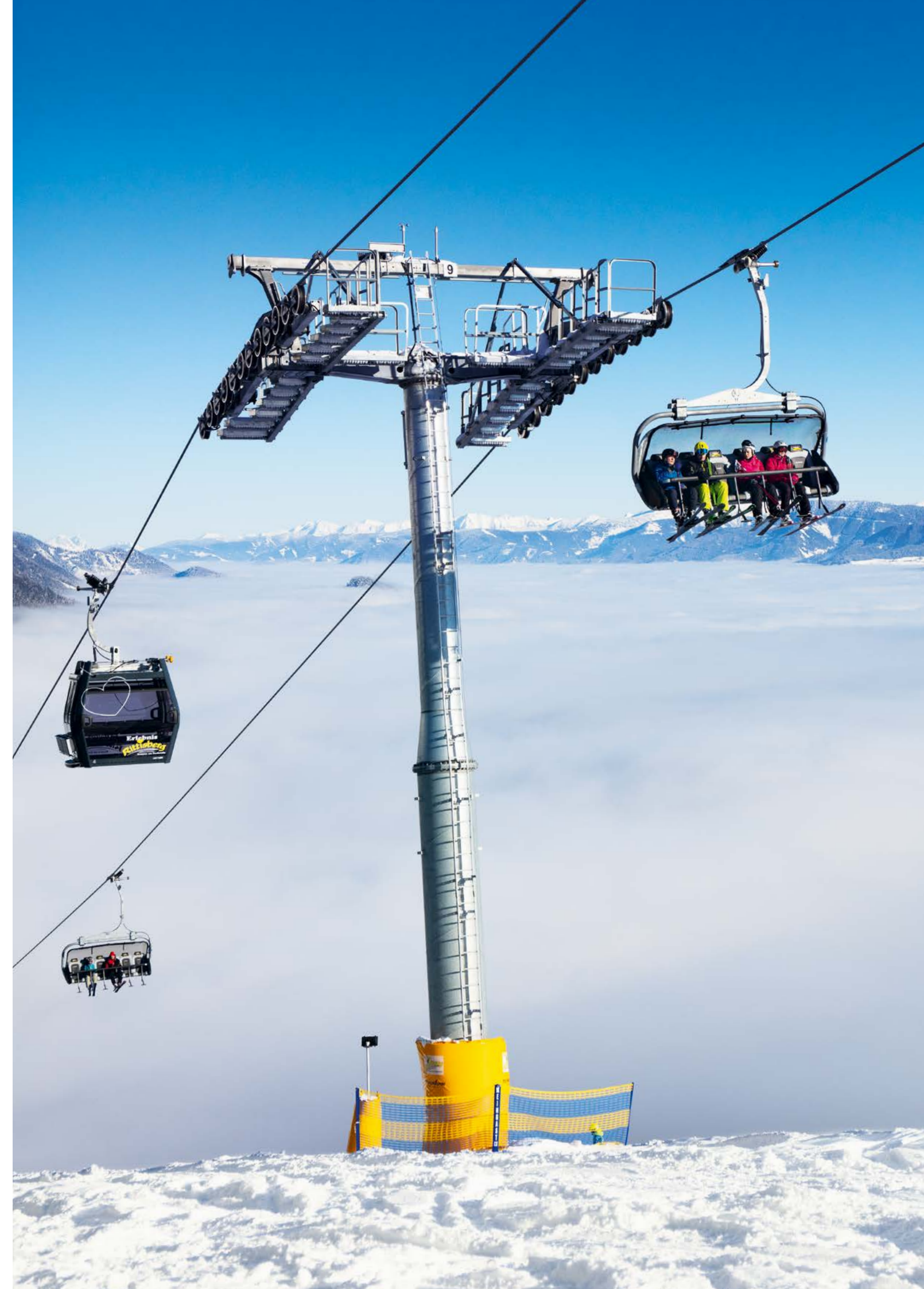
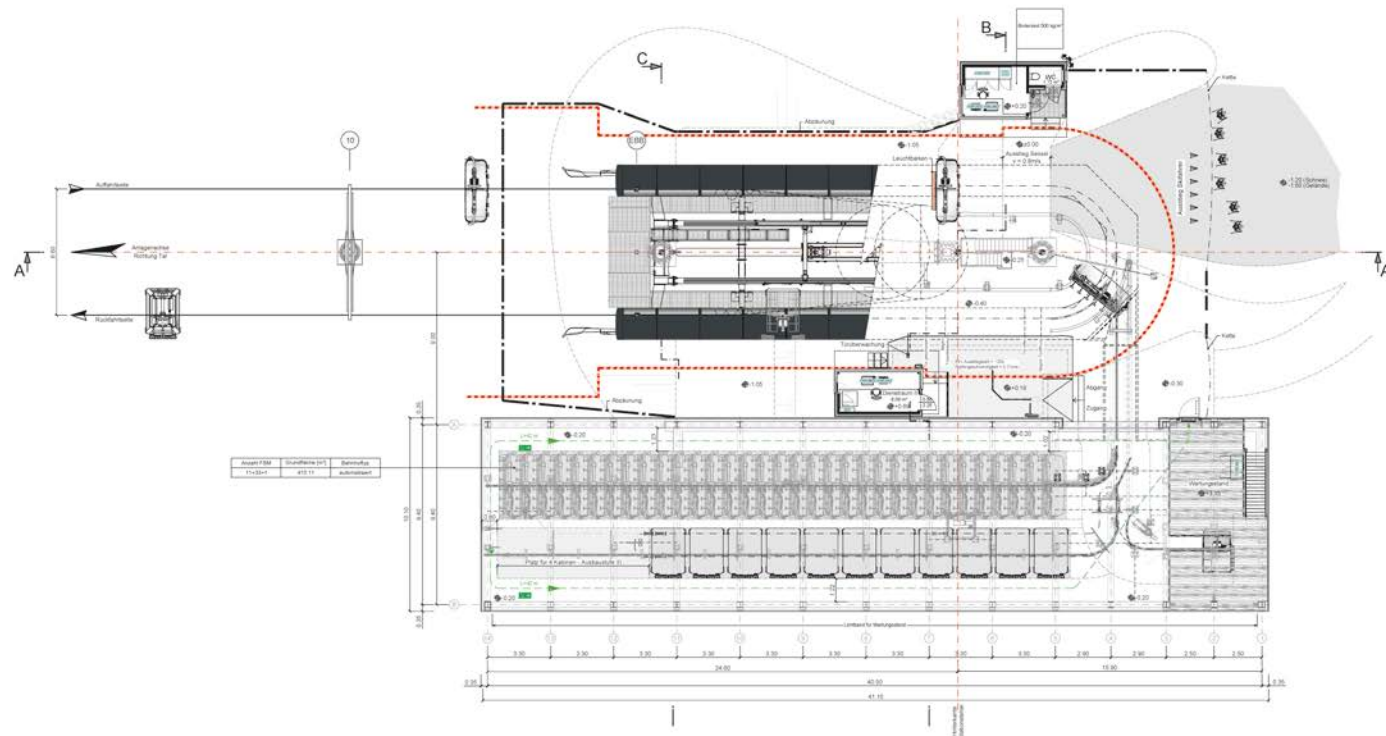





CD8C SEENOCK

Sand in Taufers - Campo Tures / IT

Inclined length	1192 m	Power	679 kW
Vertical rise	294 m	Total number of vehicles	65
Transport capacity	3400 p/h	Total number of towers	11

At the South Tyrolean ski resort of Speikboden, the new CD8C "Seenock" replaces a 4-seater chairlift which has already been operating for 30 years. The new chairlift uses the existing route and features LEITNER DirectDrive, Premium chairs with genuine leather seats, weather protection bubbles, and seat heating. The modern 8-seater chairlift's station has been designed by Italy's renowned

Pininfarina studio. The new ropeway increases capacity to 3400 passengers per hour, brings the journey time down to just four minutes, and gives easy access to the various slopes of this family-friendly ski resort. The highlight is the almost eight-kilometer-long valley run involving 1450 meters of descent – one of the biggest drops in South Tyrolean skiing.

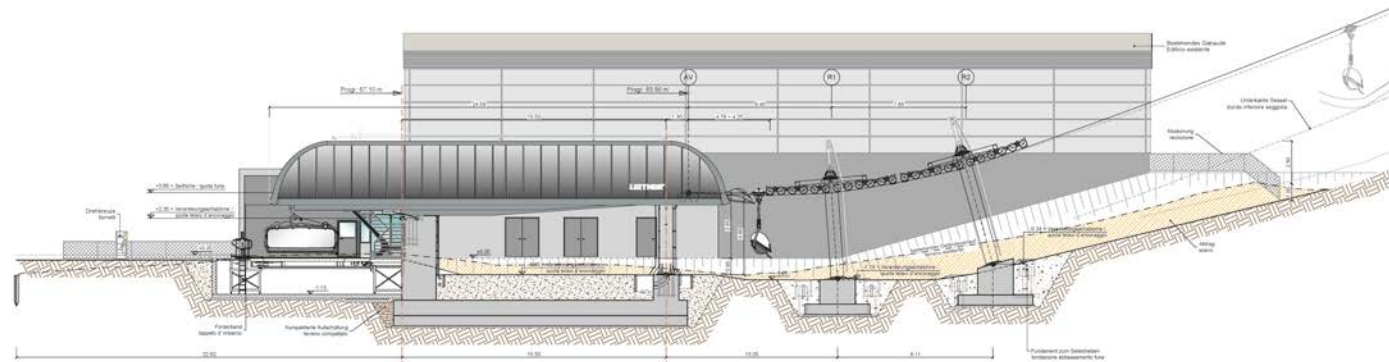





© Speikboden

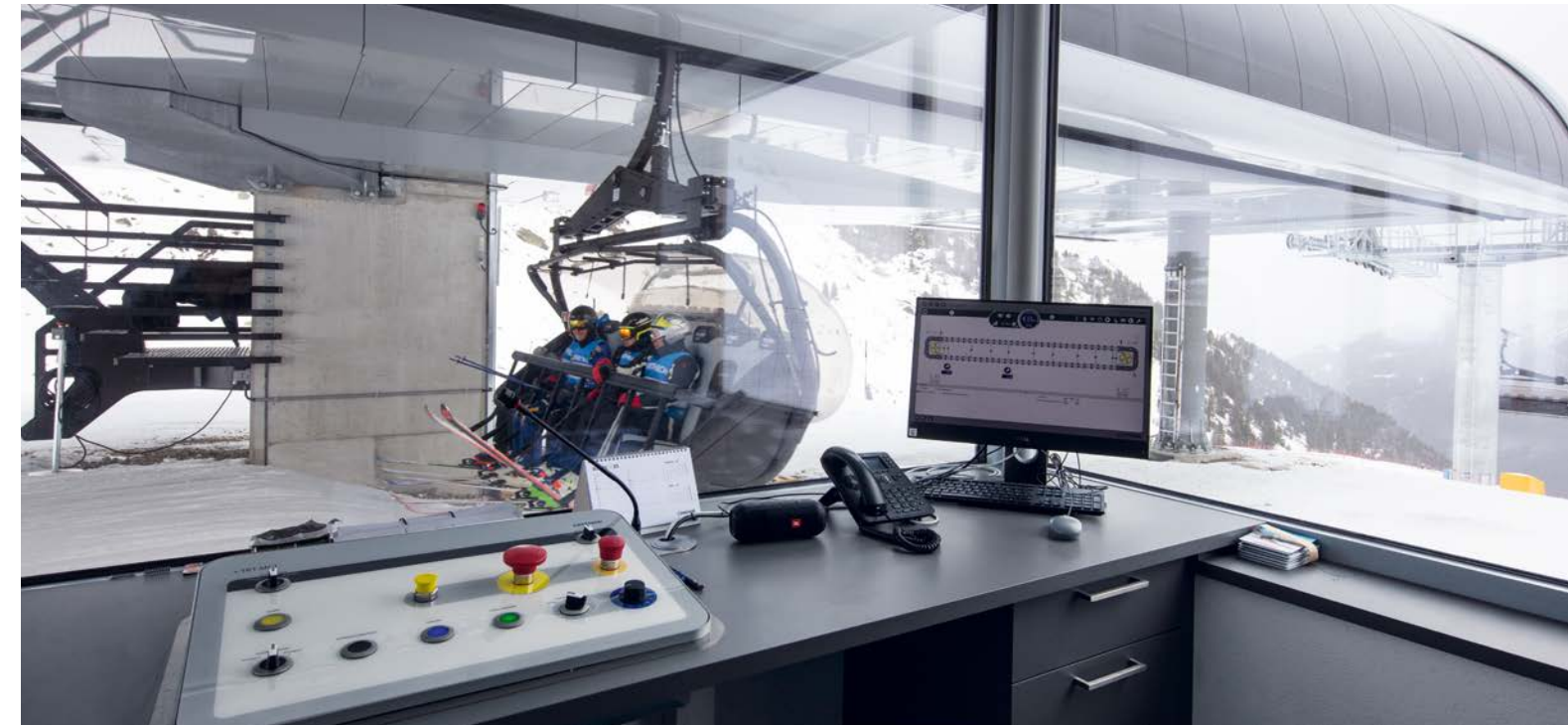



CD8C KAPAUNS

Zell am Ziller / AT

Inclined length	1936 m	Power	882 kW
Vertical rise	597 m	Total number of vehicles	72
Transport capacity	2940 p/h	Total number of towers	17

The new CD8C "Kapauns" in the tourist region of Zillertal has replaced an old system built in 1993, and its extended route takes it right up to the top of the col. This has created a new link between Zell and Gerlos. The new routing has almost doubled the associated pistes to over 2.5 km, bringing some to above 2500 m in the process, and making them fully north-facing, which means excellent snow conditions right into the spring. This part of the Zillertal Arena, with its 147 km of slopes, has

been made significantly more attractive by the new ropeway. With a journey time of around seven minutes, the new 8-seater chairlift carries up to 3000 people per hour along a route of nearly two kilometers. It incorporates not only the latest ropeway technology from LEITNER, but also, in collaboration with world-renowned architects Snøhetta, a strong architectural dimension. The new stations feature designs that are minimalist yet spectacular.

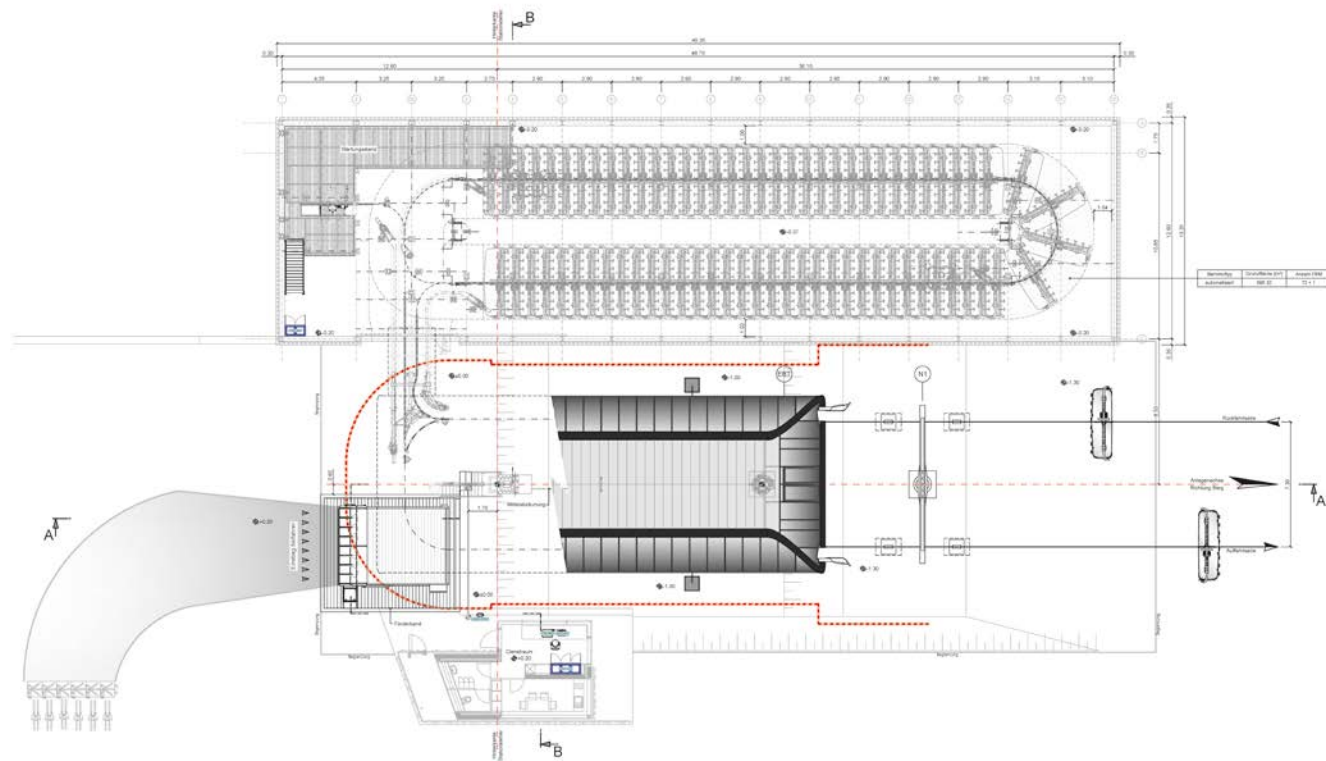







CD6C HORNBAHN 2000

Alpbach / AT

Inclined length	1123 m	Power	662 kW
Vertical rise	391 m	Total number of vehicles	61
Transport capacity	2600 p/h	Total number of towers	11

The new CD6C "Hornbahn 2000" has replaced its 4-seater predecessor at Ski Juwel Alpbachtal Wildschönau. This modern, detachable 6-seater chairlift carries up to 2600 people over a distance of nearly 1100 meters to the Top of Alpbachtal station in under four minutes. High-end equipment, including LEITNER DirectDrive, heated seats, and weather protection bubbles, means the focus in Alpbachtal

is very much on quality rather than quantity. This replacement investment was not aimed at expansion, but on improving the quality of the mountain experience. That includes the new Top of Alpbachtal attraction, which can be reached on the "Hornbahn 2000". The new top station, with its observation tower, platform and modern premises, has become a new focal point for the entire region.

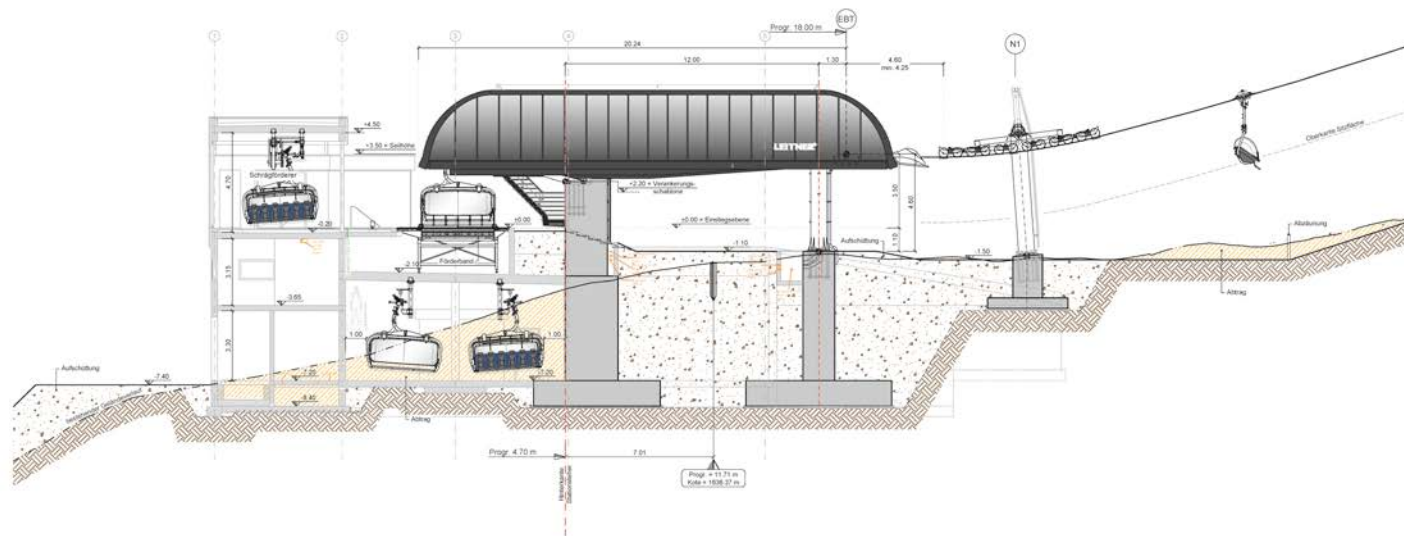







CD6C LEPPLESKOFELBAHN

St. Jakob im Defereggental / AT

Inclined length	1130 m	Power	529 kW
Vertical rise	390 m	Total number of vehicles	48
Transport capacity	2400 p/h	Total number of towers	10

A new 6-seater chairlift has brought ultimate comfort to the Tyrolean ski resort of Defereggental. The new facility, which ascends to nearly 2700 meters above sea level, is East Tyrol's highest ropeway system and offers especially impressive levels of comfort.

LEITNER DirectDrive, heated premium seats, and weather protection bubbles provide sustainable efficiency and relaxed transport

in all weather conditions. With a journey time of under four minutes, the chairlift carries up to 2400 people per hour, making it part of the new quality offensive in East Tyrol's ski resorts. In combination with the new construction, the operators also invested in expanding their ski slope infrastructure. The development of three new ski runs means no less than 25 percent more slopes.

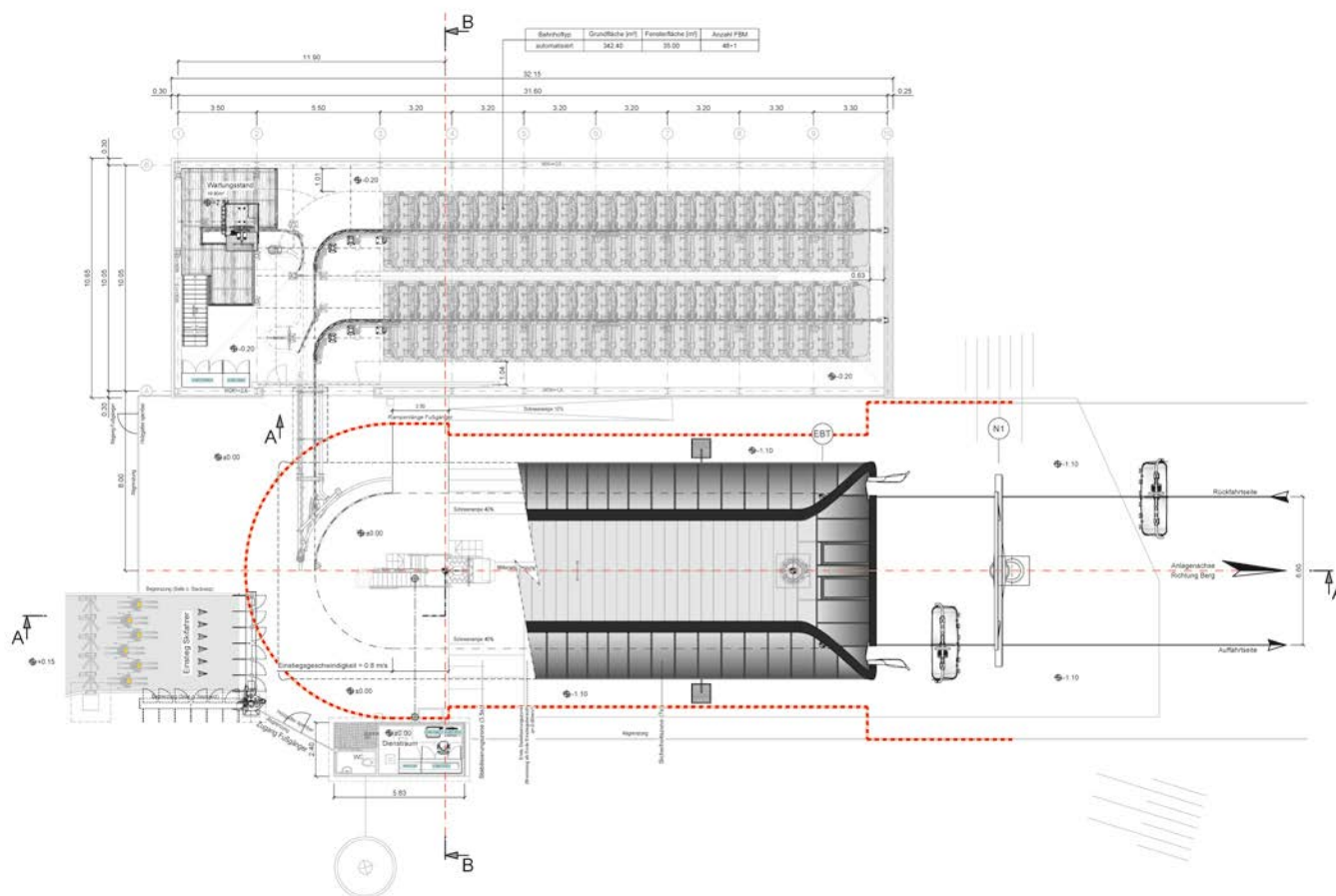



© Martin Luggler



© Simon Abele



© Simon Abele





CD6C GRAN SOMETTA

Cervinia / IT

Inclined length	1168 m	Power	475 kW
Vertical rise	234 m	Total number of vehicles	57
Transport capacity	2400 p/h	Total number of towers	11

Together with the Swiss ski resort of Zermatt, the Cervino Ski Paradise is part of the "Matterhorn Ski Paradise", one of the largest and snowiest ski areas in the Alps. The new CD6C "Gran Sometta" has vastly improved the connection between Valtournenche and the rest of the ski resort. This modern ropeway replaces the eponymous surface lift and is driven by the

eco-friendly LEITNER DirectDrive. Passengers are now more comfortable because of the new heated seats and weather protection bubbles. The new ropeway is also impressively quick, carrying sports enthusiasts to the 3092 m top station in just four minutes, which is over 65% faster than its predecessor.

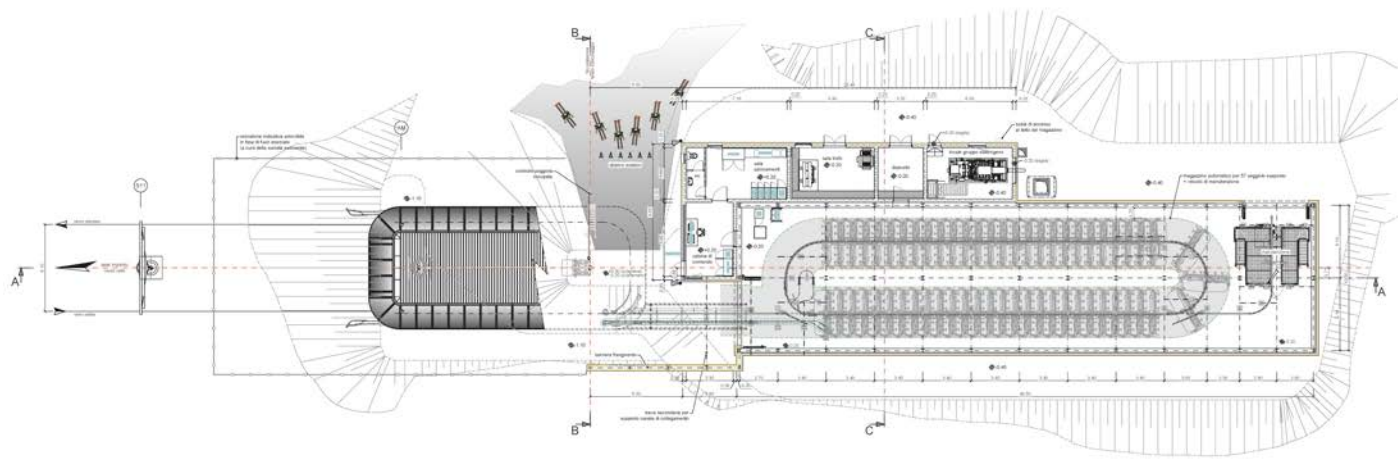





CD6 CIT ROC

Sestriere / IT

Inclined length	1211 m	Power	2 x 280 kW
Vertical rise	325 m	Total number of vehicles	64
Transport capacity	2600 p/h	Total number of towers	13

The Via Lattea (which means 'Milky Way' and is also the name of the ski resort) between Piedmont in Italy and Provence-Alpes-Côte d'Azur in France connects the Italian venues of the 2006 Turin winter Olympics with Montgenèvre in France, via Claviere on the border. But it isn't just the resort's location which crosses boundaries: it's 400 km of slopes and numerous ropeways are also

of record-breaking proportions. A modern 6-seater chairlift made by LEITNER was recently installed along the famous world cup run in Sestriere. The new CD6 "Cit Roc" carries up to 2600 people per hour on a journey of just under five minutes, which means significantly greater capacity for the ski resort which belongs to Turin's Olympic region.

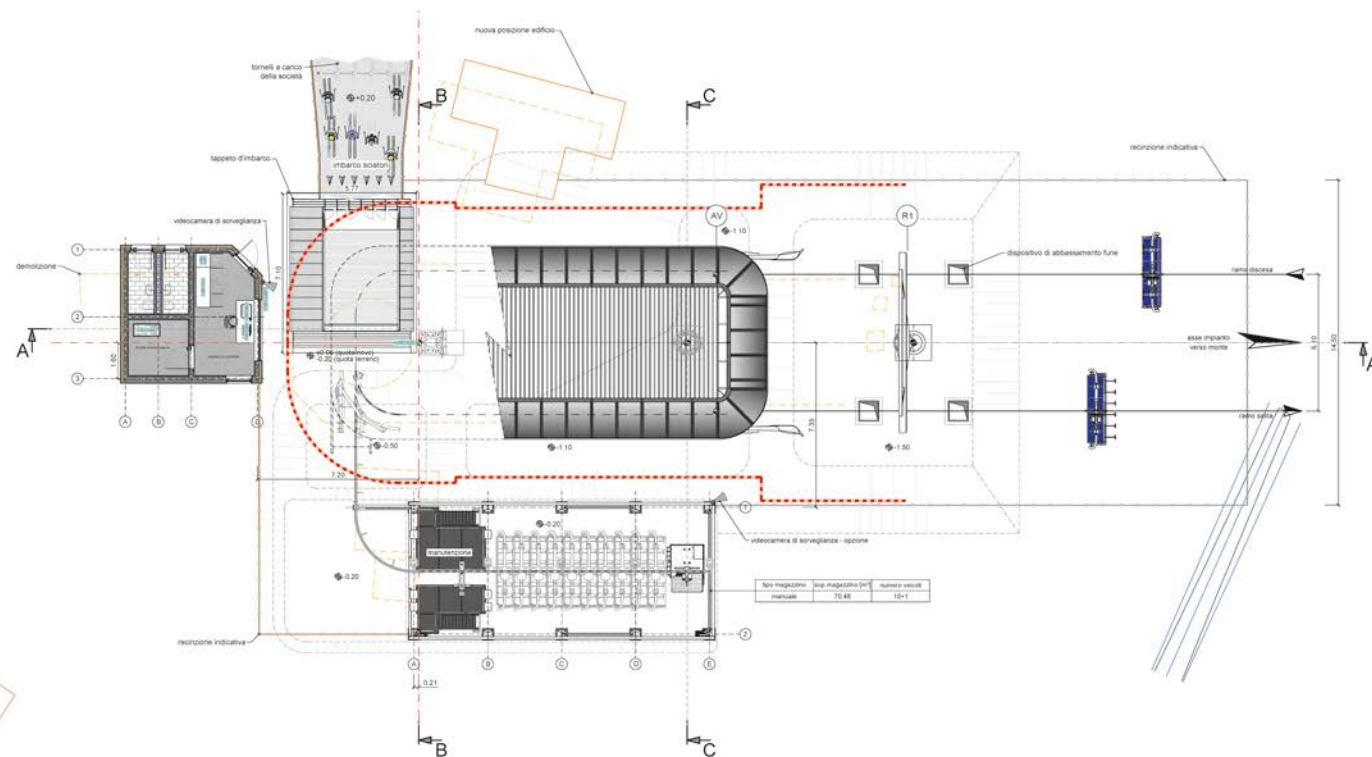



CD6 STJÄRNLIFTEN

Åre / SE

Inclined length	765 m	Power	368 kW
Vertical rise	328 m	Total number of vehicles	42
Transport capacity	2600 p/h	Total number of towers	12

LEITNER built a new 6-seater chairlift to augment the forty-plus existing ropeways at Sweden's largest ski resort. The new CD6 "Stjärnliften" was erected in the center of the well-known World Cup venue of Åre, where it replaces a fixed grip 2-seater chairlift. Aside from boosting capacity for winter operation, one of the aims of modernizing

this ropeway was to enable bicycles to be carried during the summer months. LEITNER bicycle holders, which can carry four bikes per chair, are super-easy to use and make it much more convenient to take bikes up into the hills. The CD6 "Stjärnliften" is also the first ropeway in Sweden to be built specifically for year-round use.

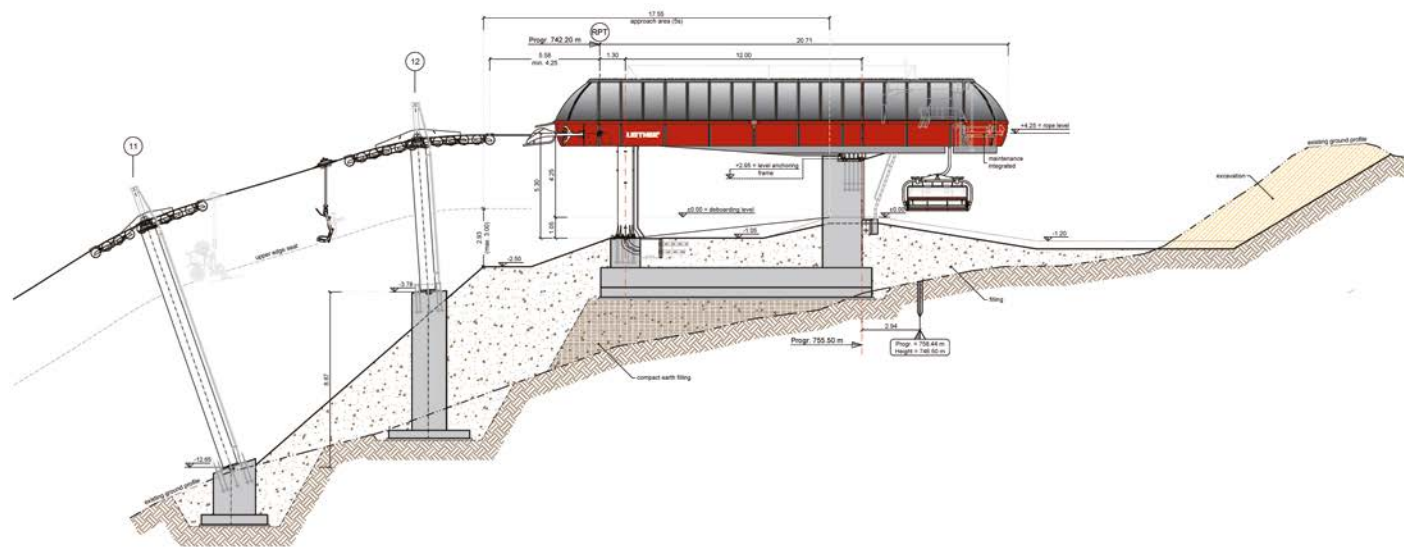



CD6 SNÖBERGET DIREKT

Romme Alpin / SE

Inclined length	2427 m	Power	529 kW
Vertical rise	266 m	Total number of vehicles	126
Transport capacity	3200 p/h	Total number of towers	19

LEITNER built a 6-seater chairlift at the Romme Alpin ski resort near Stockholm. It has boosted capacity and comfort, especially for the numerous weekend visitors who come from the city. This ropeway, powered by a LEITNER DirectDrive, connects the two farthest locations at the resort, making it

Romme Alpin's longest ropeway. Covering a length of 2427 m, just before its highest point, the ropeway crosses the Nordexpress 6-seater chairlift built by LEITNER in 2012. LEITNER's CD6 "Snöberget Direkt" is its sixth ropeway at this central Swedish ski area.

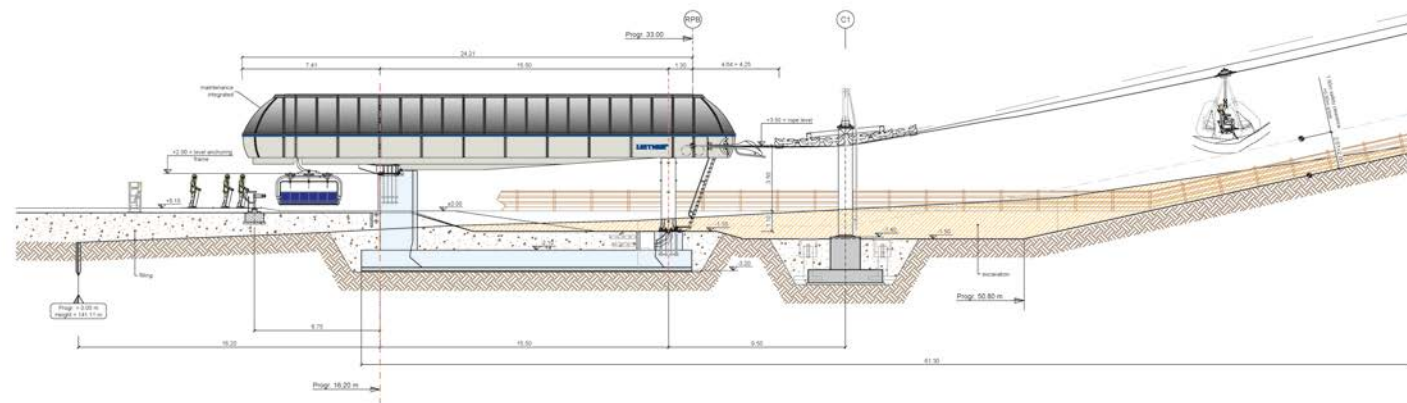





CD6 MIDT-EXPRESSEN

Klaebu / NO

Inclined length	1371 m	Power	560 kW
Vertical rise	301 m	Total number of vehicles	60
Transport capacity	2600 p/h	Total number of towers	12

The Norwegian ski resort of Vassfjellet – Klæbu, south of Trondheim, which is especially popular with families, invested in a modern, detachable 6-seater chairlift built by LEITNER. This ropeway is called CD6 “MIDT-Expressen”

and has a capacity of 2600 passengers per hour. It's LEITNER's seventh ropeway in snow-sure Vassfjellet, which offers a total of 15 kilometers of slopes.

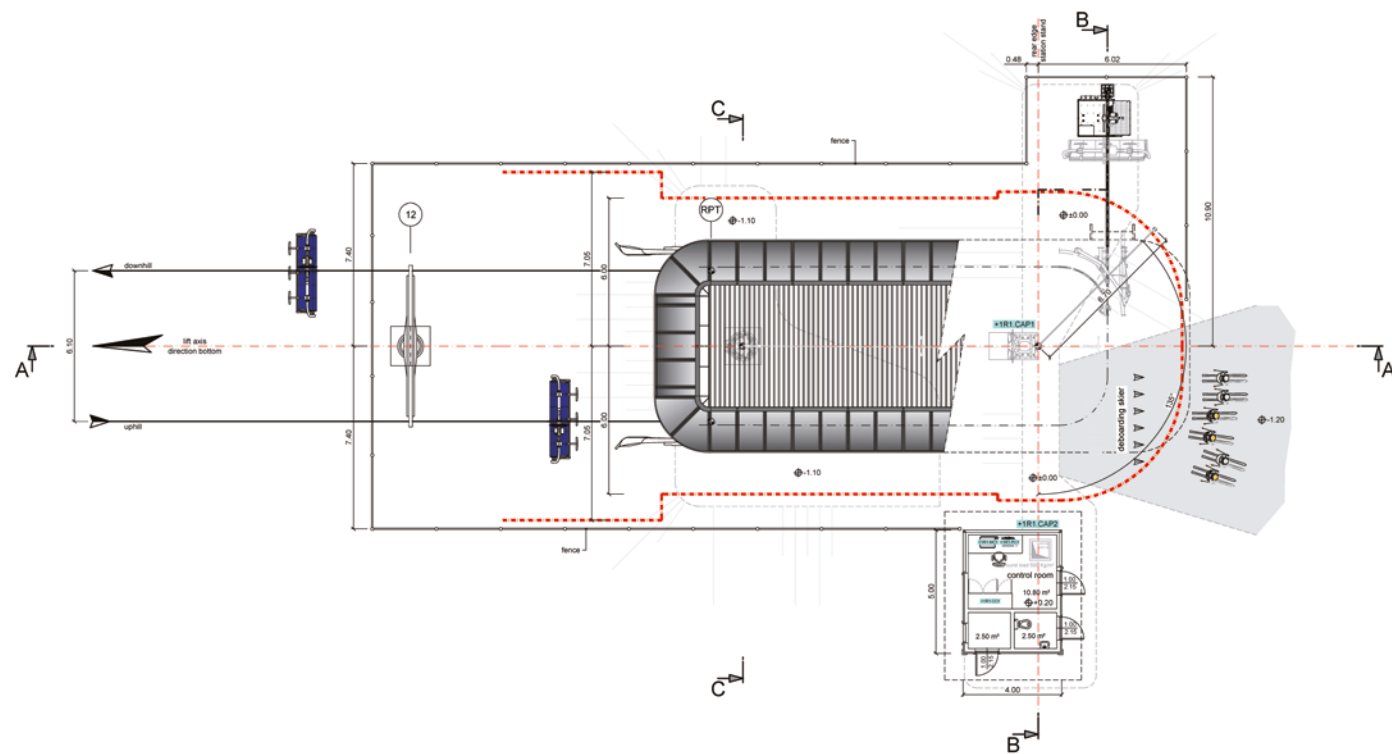

CD6 BITIHORN EXPRESSEN

Beitostølen / NO

Inclined length	726 m	Power	250 kW
Vertical rise	130 m	Total number of vehicles	40
Transport capacity	2600 p/h	Total number of towers	8

LEITNER built the CD6 "Bitihorn Expressen" chairlift along the summer bobsleigh track in the Norwegian town of Beitostølen in 2022. This comfortable new system is the second detachable chairlift which LEITNER has built there, and replaces a 3-seater chairlift built in 1986.

By making this investment, the operators aimed to distribute visitors more evenly across the resort and give them better access to the steeper slopes, as well as modernizing the

facilities in general. The Bitihorn Expressen not only offers space for twice as many passengers as its predecessor, it also saves them over six minutes of travel time. This capacity and speed increase has made the Beitostølen Skisenter tangibly more attractive. It means quick access to twelve kilometers of varied slopes in winter, and makes it easy to transport bicycles in summer with its LEITNER bike holders.

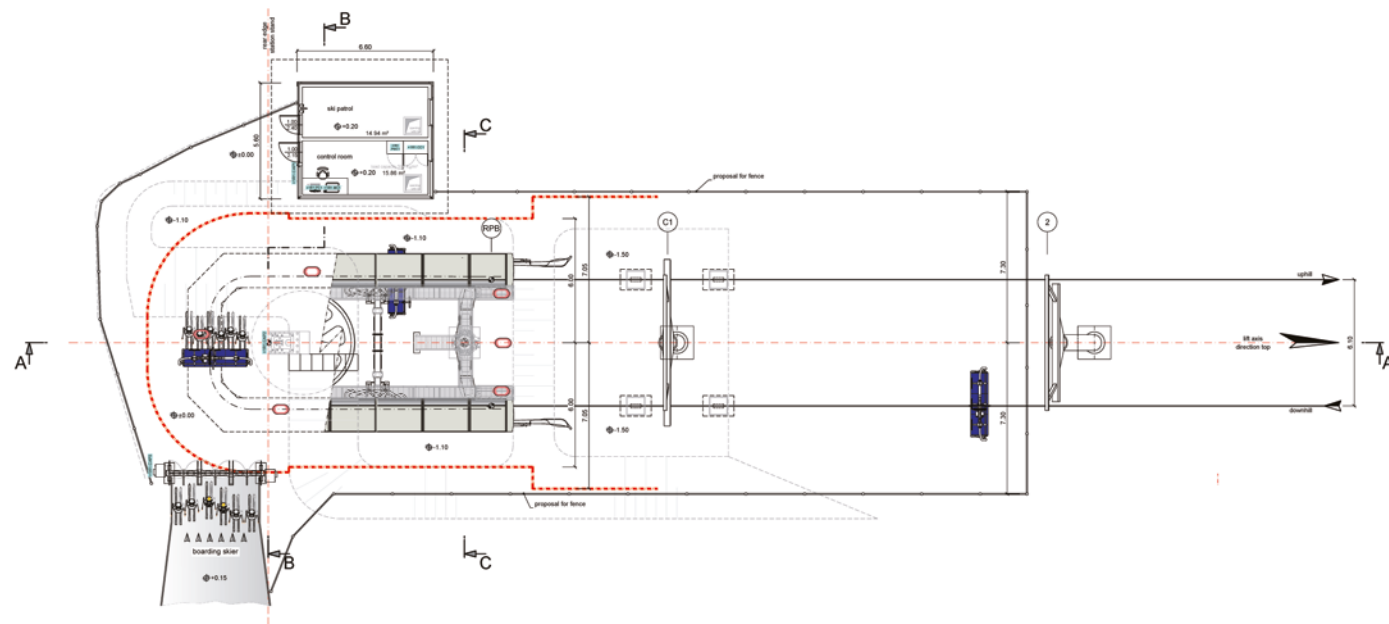



CD6 TRÅSTØLEN

Voss / NO

Inclined length	1002 m	Power	368 kW
Vertical rise	255 m	Total number of vehicles	49
Transport capacity	2400 p/h	Total number of towers	8

Voss Resort is the largest skiing area in western Norway and offers descents for every ability. A highlight of the Norwegian fjord landscape, Voss is idyllically situated between the Hardanger and Sogne fjords and boasts views over the mountains and forested valleys, rivers, and waterfalls, and even – when visibility is good – a view out to the Norwegian coast.

At this picturesque resort, LEITNER constructed the new CD6 “Trastølen” chairlift to replace a fixed-grip ropeway built back in 1968. Powered by a LEITNER DirectDrive, the new system delivers a significantly improved capacity of up to 2400 passengers per hour. The new ropeway also reduces the journey time along the existing route to just over three minutes.

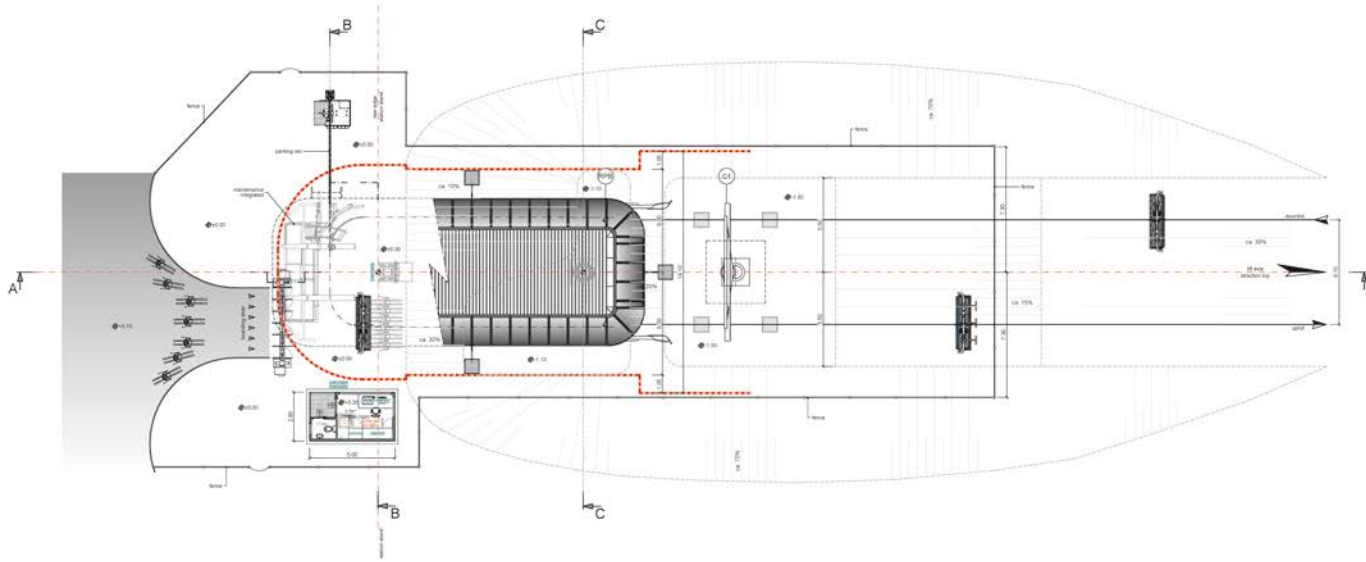

CD6 VARS SPEED MASTER

Vars / FR

Inclined length	1549 m	Power	808 kW
Vertical rise	522 m	Total number of vehicles	56
Transport capacity	2000 p/h	Total number of towers	14

The La Forêt Blanche ski resorts connects the two French winter sports venues of Vars and Risoul in the Briançon arrondissement. Surrounded by the peaks of the Ecrin massif, Ubaye valley, and Queyras national parks, this winter sports area offers stunning views com-

bined with every variety of snowy fun. Its new CD6 "Vars Speed Master" has brought it a much-needed upgrade, replacing its 4-seater predecessor. The new ropeway has speeded up journey times and also increased capacity considerably.

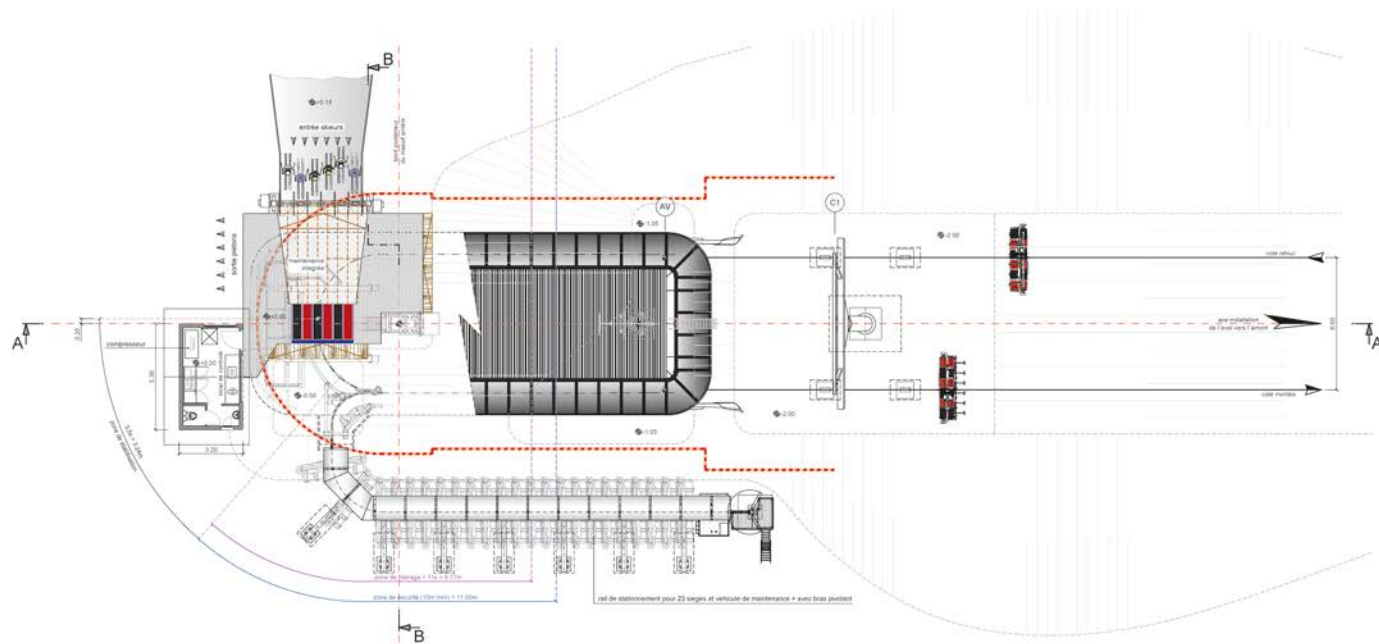

CD6 LA MAYT

Vars / FR

Inclined length	2251 m	Power	882 kW
Vertical rise	609 m	Total number of vehicles	104
Transport capacity	2800 p/h	Total number of towers	21

With its multiple snow parks, children's areas, and other attractive features, the La Forêt Blanche ski resort appeals to different target groups. Its diverse facilities, combined with its picturesque setting and well-maintained slopes, make this region one of France's most popular skiing areas. La Forêt Blanche, lying between 1650 and 2750 meters in altitude, has 185 kilometers of pistes, making it one of

the largest ski resorts in France. So it requires ropeways of the highest quality. Spanning a length of just under 2.5 kilometers, the new CD6 "La Mayt" system ascends over 600 meters and carries up to 2800 people per hour. This modern LEITNER chairlift replaces an old 4-seater ropeway and a surface lift, providing a comfortable connection to the top station beneath the peak of La Mayt, at 2470 m.

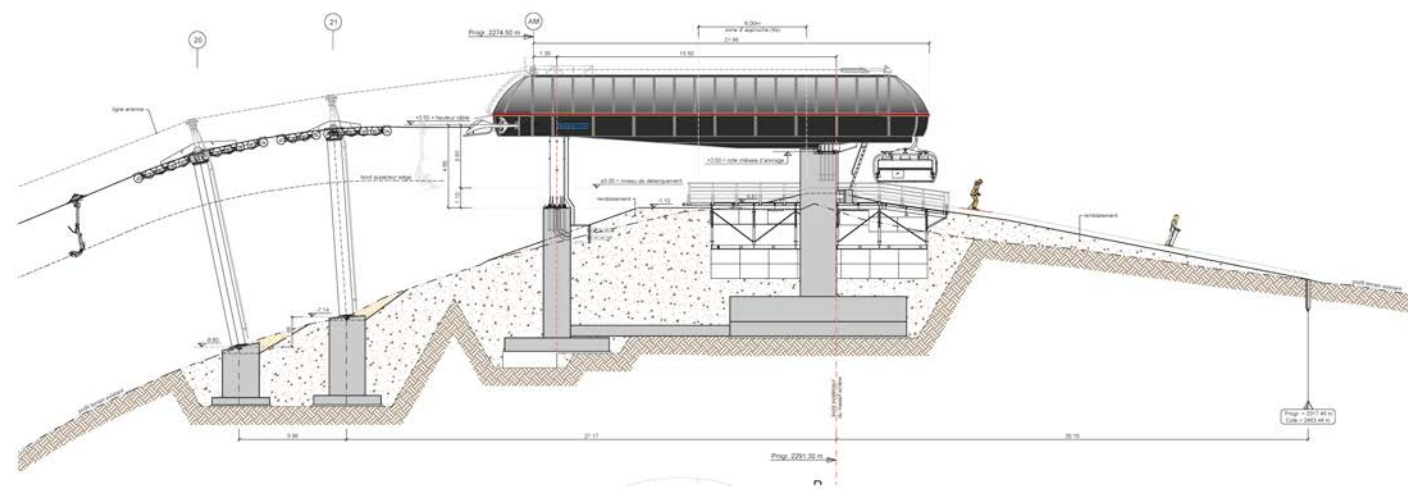





CD6 LES NANTS

Saint Gervais / FR

Inclined length	811 m	Power	400 kW
Vertical rise	248 m	Total number of vehicles	41
Transport capacity	2400 p/h	Total number of towers	8

Immediately adjoining Mont Blanc, the French ski resort of St. Gervais offers its visitors ski runs of every level. This idyllic resort, with its unspoiled character, is just around the corner from one of the major centers of alpine skiing: Chamonix. Interestingly, although the highest mountain in the Alps is surrounded by the municipality of Chamonix on the French side, the summit area belongs to the village of St. Gervais.

As well as its 263 kilometers of pistes, multiple snow parks, cross-country ski trails, snowshoe and winter hiking trails, this popular Haute Savoie can now boast the “Les Nants”, which hasn’t just reduced journey time significantly, it also makes things much more comfortable for winter sports enthusiasts. The new detachable ropeway replaces the Arbois fixed grip 2-seater chairlift built in 1977 and carries up to 2400 people per hour.

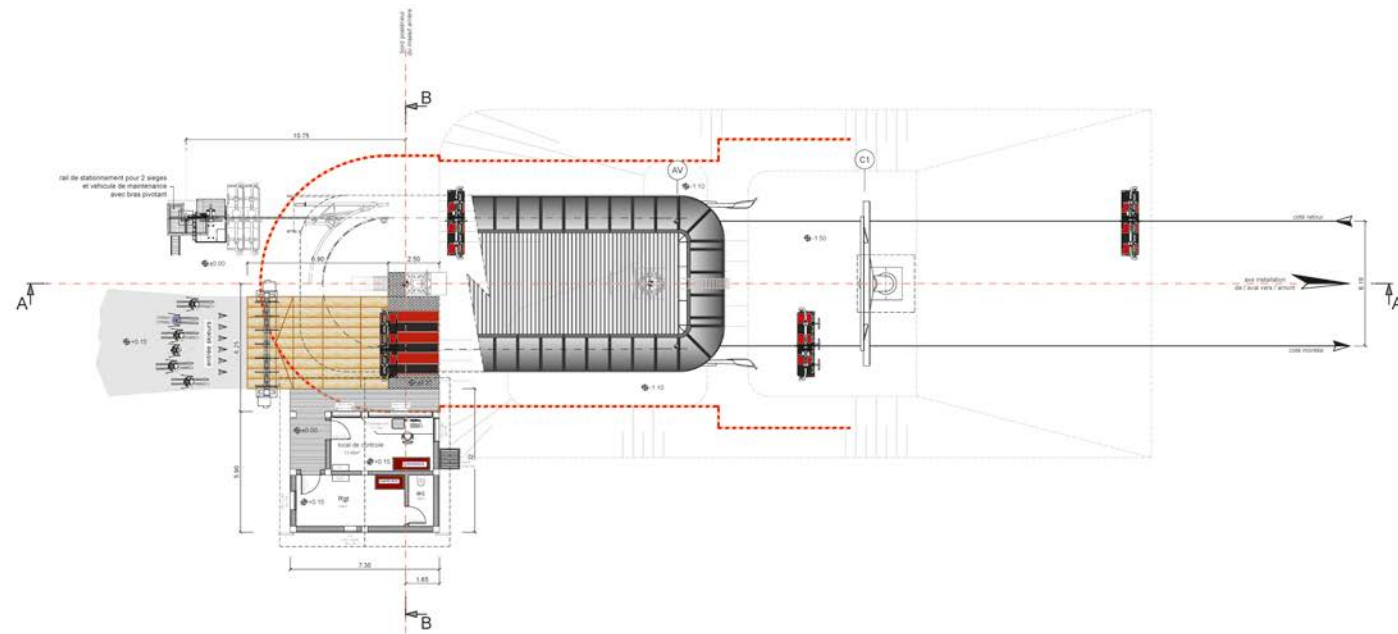





CF4 CIMA TOGNOLA

San Martino / IT

Inclined length	444 m	Power	132 kW
Vertical rise	144 m	Total number of vehicles	42
Transport capacity	1500 p/h	Total number of towers	6

LEITNER built the new CF4 "Cima Tognola" chairlift in continuation of a successful, long-standing partnership at the San Martino di Castrozza ski resort. The new ropeway's bottom station has been moved a little further uphill from its 2-seater predecessor's, which creates a quick connec-

tion from the Cigolera 6-seater chairlift. Nestling amid the fabulous Dolomite landscape, the Italian ski resort offers peerless views over the Pala Group, as well as 60 kilometers of slopes for beginners and advanced skiers alike.

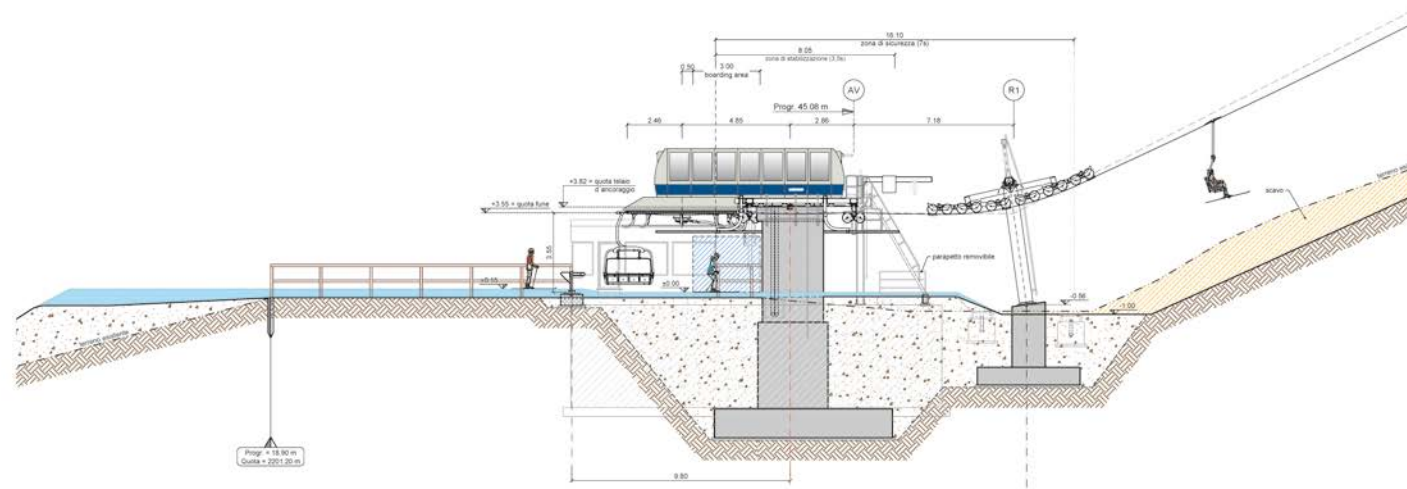





SL1 DORIS

Innichen - San Candido / IT

Inclined length	799 m	Power	90 kW
Vertical rise	173 m	Total number of vehicles	98
Transport capacity	720 p/h	Total number of towers	8

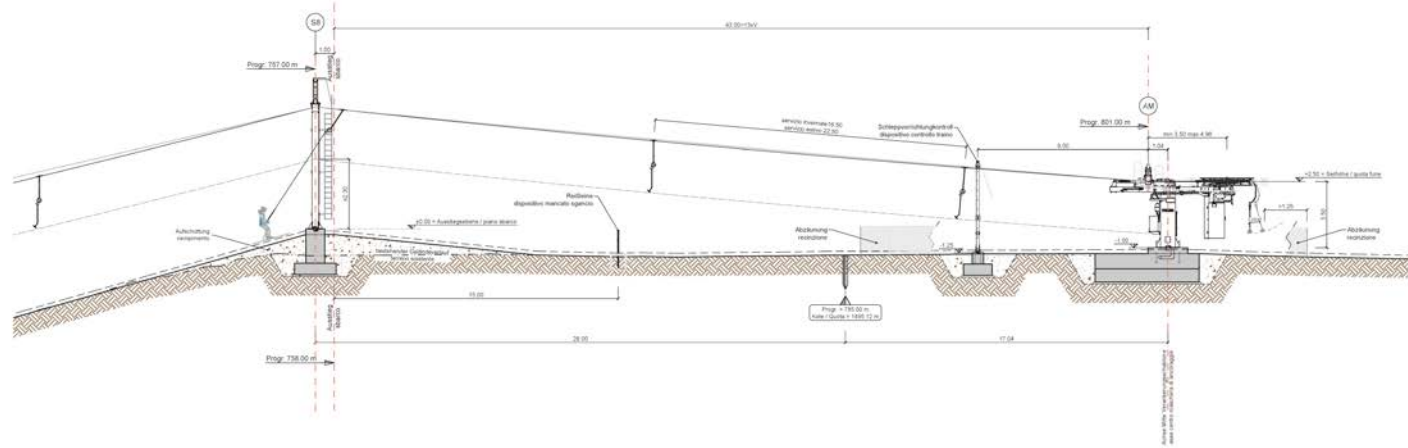



SL1 SCHWARZHORN

Jochgrimm - Passo Oclini / IT

Inclined length	626 m	Power	75 kW
Vertical rise	104 m	Total number of vehicles	106
Transport capacity	900 p/h	Total number of towers	7

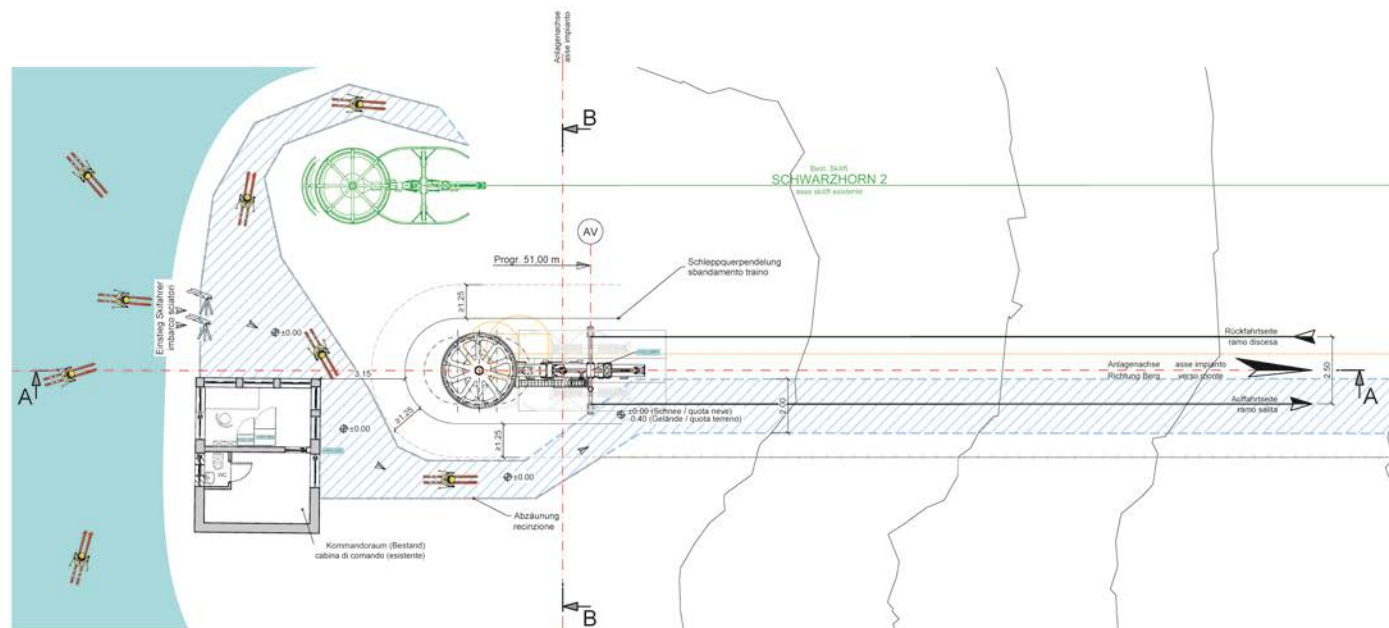

Successfully modernized





GD10 DANTER + CEPIES

Wolkenstein - Selva di Val Gardena / IT

Danter

Inclined length	2160 m
Vertical rise	519 m
Transport capacity	3000 p/h
Power	900 kW
Total number of vehicles	74
Total number of towers	15

Cepies

Inclined length	507 m
Vertical rise	126 m
Transport capacity	3000 p/h
Power	360 kW
Total number of vehicles	24
Total number of towers	5

The two Danter and Cepies 10-passenger gondola lifts have been playing an important strategic role in the skiing paradise between Selva di Val Gardena and Passo Gardena since 2013. On behalf of operator Seggiovia Dantercepies SpA, LEITNER last year set another technical milestone in the development of this ropeway. The focus was on the sustain-

able conversion of the two drives positioned in the middle station. The planetary gearing in the gondola lifts Danter (LP300) and Cepies (LP135), together with the motors, were replaced with two new LEITNER LD10 and LD5 DirectDrives. This brought about significant reductions in noise and energy consumption, as well as minimizing maintenance.

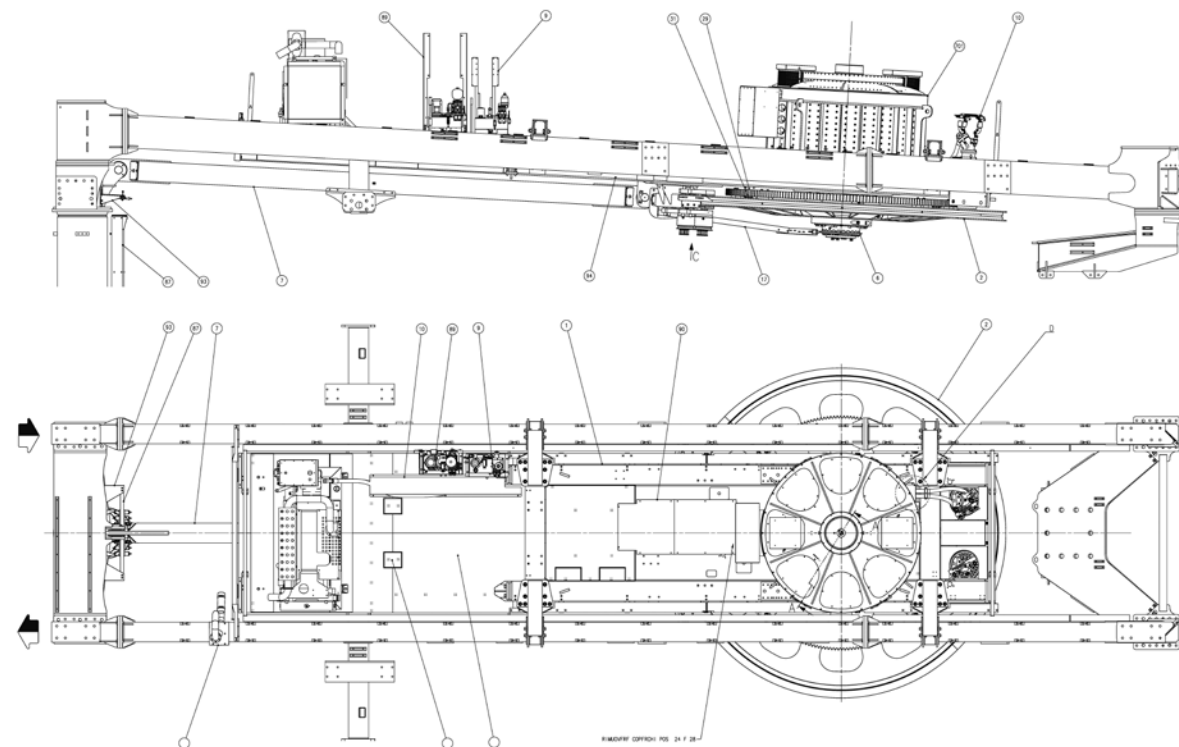



GD8 BERG- + NESSELBAHN

Meransen - Maranza / IT

Bergbahn

Inclined length	1571 m
Vertical rise	240 m
Transport capacity	2400 p/h
Power	794 kW
Total number of vehicles	52
Total number of towers	14

Nesselbahn

Inclined length	1678 m
Vertical rise	477 m
Transport capacity	2400 p/h
Power	794 kW
Total number of vehicles	55
Total number of towers	14

Visitors to the Rio Pusteria ski resort in South Tyrol can enjoy a total of 55 kilometers of pistes reaching as high as 2500 meters, far from the hustle and bustle of many other winter sports regions. The "Bergbahn and Nesselbahn" 8-passenger gondola lifts, which are connected by a middle station, have been upgraded as part of comprehensive modernization work, making them especially energy-efficient. Two LeitDrive frequency converters have been incorporated along with two LEITNER DirectDrives. This general overhaul also included a vibration monitoring system, laying the foundations for safe, low-energy operation.

been upgraded as part of comprehensive modernization work, making them especially energy-efficient. Two LeitDrive frequency converters have been incorporated along with two LEITNER DirectDrives. This general overhaul also included a vibration monitoring system, laying the foundations for safe, low-energy operation.

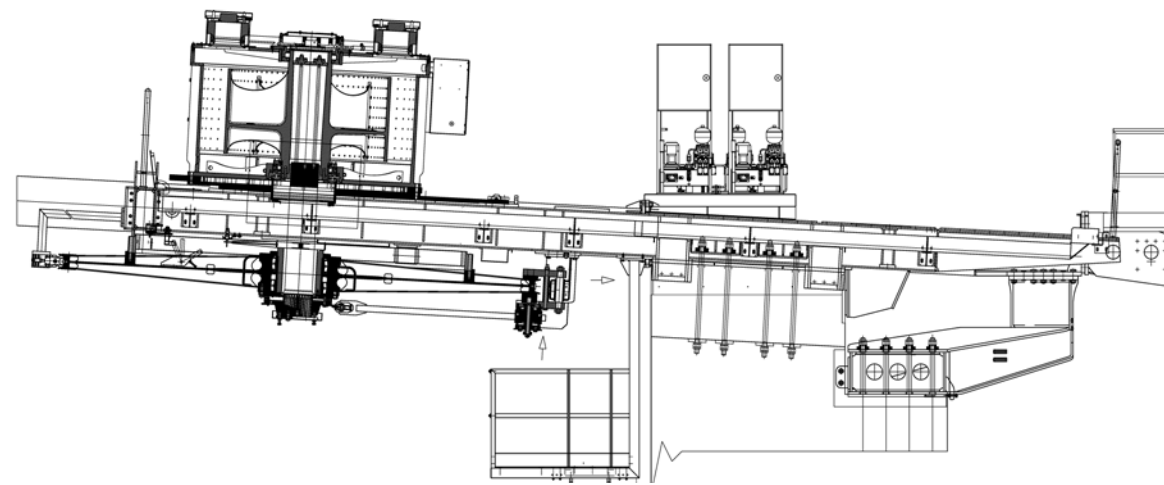



GD8 COL VERDE

San Martino di Castrozza / IT

Inclined length	1564 m	Power	500 kW
Vertical rise	443 m	Total number of vehicles	38
Transport capacity	1500 p/h	Total number of towers	14

The San Martino di Castrozza ski resort in Trentino encompasses 60 kilometers of pistes of every difficulty, as well as children's areas and an attractive range of cross-country ski trails. The gondola lift built by LEITNER in 1998 has been significantly updated in the

course of modernizations. Thanks to 38 new Diamond cabins with external ski racks, the ropeway has now been brought up to date in terms of comfort, making for a pleasant 1.5 kilometer journey.

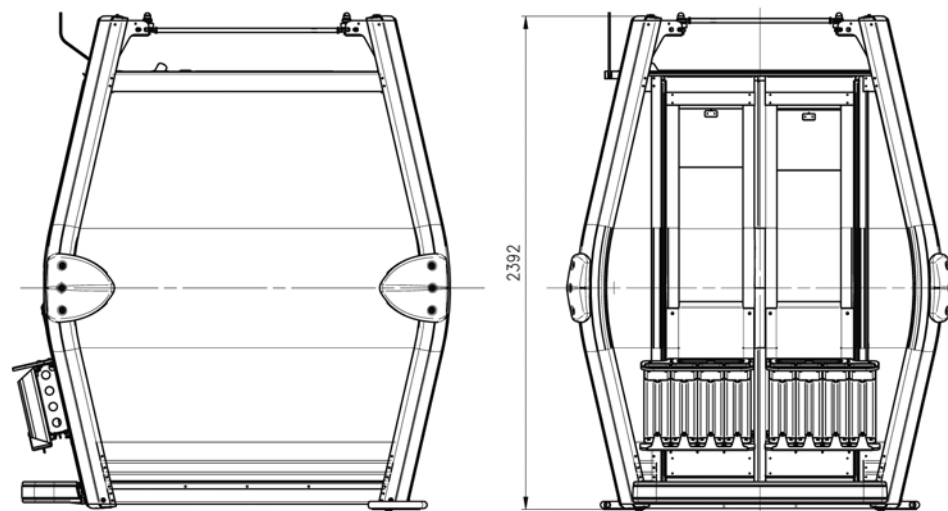

AT160 CHIESA VALMALENCO

Chiesa in Valmalenco / IT

Inclined length	1973 m	Power	490/490 kW
Vertical rise	1098 m	Total number of vehicles	2
Transport capacity	1400 p/h		

One of the world's most spectacular aerial tramways, the Snow Eagle carries 160 people, making it also one of the largest in the world. It's been responsible for superlatives since 1999 and carrying passengers up into the piste landscape of the Valmalenco Bernina ski resort in the heart of Alpe Palù in Lombardy. This ropeway, which will soon be 25 years old, was closely inspected for safety and func-

tionality as part of a comprehensive overhaul. Complete with the stylized face of a woman which is the ski resort's logo on the cabin, it resumed operations punctually in time for Christmas. This means up to 1400 people per hour can now enjoy the almost four-minute journey in conjunction with the latest technical standards.

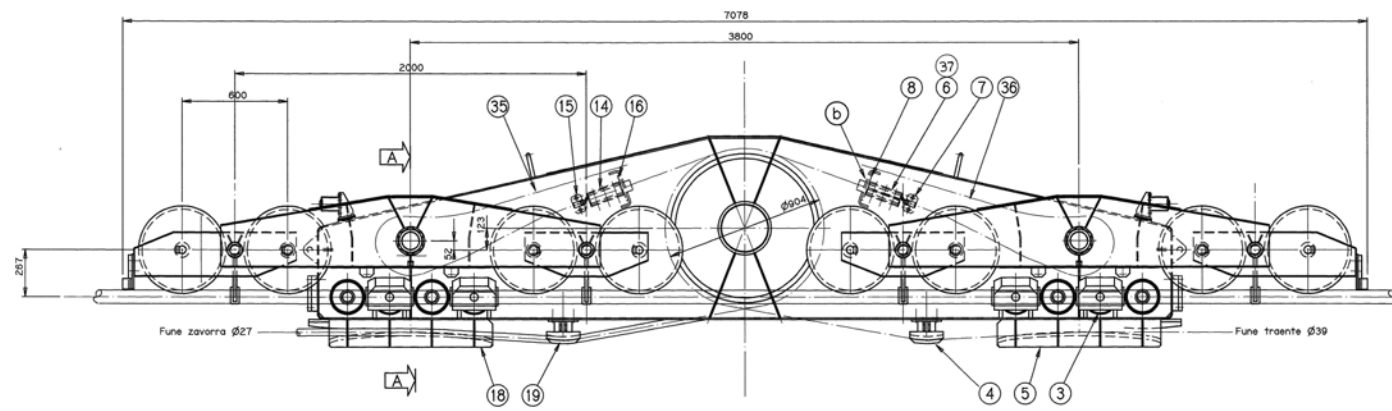

Successes 2022





Successes 2022

LEITNER®



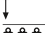
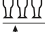
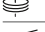
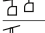

GD10 ROSSKOPF
Sterzing - Vipiteno / IT



	2706 m
	892 m
	2300 p/h
	950 kW
	65
	15

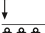

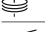

GD10 HOADLBAHN I
Axams / AT



	1185 m
	422 m
	2800 p/h
	794 kW
	40
	10

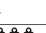

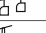

GD10 HOADLBAHN II
Axams / AT



	950 m
	356 m
	2800 p/h
	529 kW
	35
	8



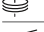



CD6C GRAN SOMETTA
Cervinia / IT



	1168 m
	234 m
	2400 p/h
	475 kW
	57
	11





CD6C SPITZBÜHEL
Seis - Siusi / IT



	1015 m
	219 m
	2400 p/h
	441 kW
	50
	8



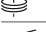

CD6 CIT ROC
Sestriere / IT



	1211 m
	325 m
	2600 p/h
	2 x 280 kW
	64
	13



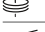

GD10 HÖSSBAHN
Hinterstoder / AT



	2606 m
	812 m
	3195 p/h
	1298 kW
	89
	19

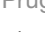

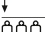
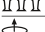

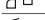
GD10 GALSTERBERGBAHN
Pruggern / AT



	2334 m
	507 m
	1760 p/h
	794 kW
	45
	14

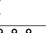

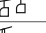

GD10 GREBEN10
St. Lambrecht / AT



	2884 m
	647 m
	2100 p/h
	794 kW
	65
	17



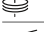

CD6C HORNBAHN 2000
Alpbach / AT



	1123 m
	391 m
	2600 p/h
	662 kW
	61
	11

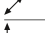

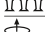

CD6C LEPPLESKOFELBAHN
St. Jakob im Defereggental / AT



	1130 m
	390 m
	2400 p/h
	529 kW
	48
	10



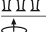

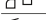

CD6 VARS SPEED MASTER
Vars / FR



	1549 m
	522 m
	2000 p/h
	808 kW
	56
	14



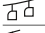

GD10 BOULEVARD
Riyadh / SA



	1128 m
	5 m
	2808 p/h
	441 kW
	40
	8

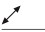
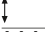
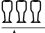

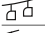



GD10 SYDGONDOLEN I
Idre / SE



	1519 m
	238 m
	3000 p/h
	529 kW
	52
	11



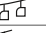



GD10 SYDGONDOLEN II
Idre / SE



	629 m
	58 m
	3000 p/h
	353 kW
	28
	6



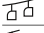



CD6 LA MAYT
Vars / FR

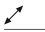

	2251 m
	609 m
	2800 p/h
	882 kW
	104
	21

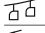

CD6 LES NANTS
Saint Gervais / FR



	811 m
	248 m
	2400 p/h
	400 kW
	41
	8

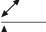
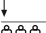
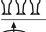

CD6 BITIHORN EXPRESSEN
Beitostølen / NO

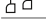

	726 m
	130 m
	2600 p/h
	250 kW
	40
	8



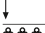
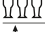
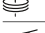
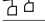

TMX6-10 RITTISBERGBAHN
Ramsau / AT



	853 m
	316 m
	2343 p/h
	441 kW
	44
	10



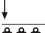

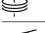
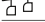

CD8C SEENOCK
Sand in Taufers - Campo Tures / IT



	1192 m
	294 m
	3400 p/h
	679 kW
	65
	11

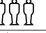

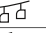



CD8C KAPAUNS
Zell am Ziller / AT



	1936 m
	597 m
	2940 p/h
	882 kW
	72
	17



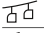



CD6 MIDT-EXPRESSEN
Klaebu / NO



	1371 m
	301 m
	2600 p/h
	560 kW
	60
	12



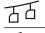



CD6 TRÅSTØLEN
Voss / NO



	1002 m
	255 m
	2400 p/h
	368 kW
	49
	8

CD6 STJÄRNLIFTEN
Åre / SE

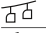

	765 m
	328 m
	2600 p/h
	368 kW
	42
	12

CD6 SNÖBERGET DIREKT
Romme Alpin / SE



	2427 m
	266 m
	3200 p/h
	529 kW
	126
	19

CF4 CIMA TOGNOLA
San Martino di Castrozza / IT



	444 m
	144 m
	1500 p/h
	132 kW
	42
	6

CF4 VITRANC 2
Kranjska Gora / SI



	1021 m
	459 m
	1000 p/h
	200 kW
	63
	10

SL2 VÄSTLIFTEN
Idre / SE



	638 m
	120 m
	1145 p/h
	75 kW
	69
	6

SL1 DORIS
Innichen - San Candido / IT



	799 m
	173 m
	720 p/h
	90 kW
	98
	8

SL1 SCHWARZHORN
Jochgrimm - Passo Oclini / IT



	626 m
	104 m
	900 p/h
	75 kW
	106
	7

SL1 LASKUOPPI
Tahko / FI



	286 m
	54 m
	896 p/h
	30 kW
	49
	4

SL1 HOVDEBAKKEN
Gjøvik / NO



	416 m
	87 m
	717 p/h
	45 kW
	68
	4

SL1 MINITEGE
Åre / SE



	172 m
	28 m
	493 p/h
	22 kW
	28
	2

SL1 POLARIS
Idre / SE



	527 m
	43 m
	782 p/h
	30 kW
	93
	6

SL1 KNAPP 398
Stöten / SE



	440 m
	30 m
	771 p/h
	22 kW
	64
	4

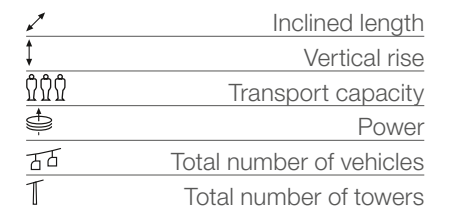

LEITNER



Vipiteno, Italy



Vipiteno, Italy



Telfs, Austria



Montmélián, France



Grand Junction, USA



Starà L'ubovňa, Slovakia

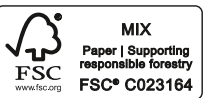

MIX
Paper | Supporting
responsible forestry
FSC® C023164

LEITNER®

www.leitner.com

